



High Peak Borough Council

working for our community

Town and Country Planning Act 1990 Town and Country Planning (Control of Advertisements) Regulations 1989

You are advised to read the notes overleaf before completing any part of this form.

Application for Consent to Display and Advertisement

Three completed copies of this form and the drawings specified overleaf (see Note 3) should be sent to:-

Regeneration Department, Municipal Buildings, Glossop, Derbyshire. SK13 8AF

1. APPLICANT (block capitals please)

Full name **TESCO STORES LTD**
Address **CARRUS BUILDING B**
SHIRE PARK, WELDON GARDEN CITY
Postcode **ACT 1AB**
Tel No .

2. AGENT (if any)(block capitals please)

Full name **AJ COCKER ASSOCIATES**
Address **NEW CENTURY HOUSE**
176 DRAKE STREET
ROCHDALE, LANC'S
Postcode **OL16 1UP**
Tel No **01706 764880**

3. Full postal address or location of the land on which the advertisement is to be displayed.

TESCO STORES LIMITED
BRIDGEMONT, WNALEY BRIDGE, HIGH PEAK
DERBYSHIRE SK23 7NT

4. State the purpose for which the land or building is now used.

RETAIL

5. (a) Has the applicant an interest in the land?

YES/NO

(b) If NO, has the permission of the owner or of any other person entitled to give permission for the display of the advertisement, been obtained?
(see Note 5)

YES/NO*

* delete as appropriate

6. (a) State the nature of the advertisement

(eg hoarding, shop sign, projecting sign, etc)

WINDOW GRAPHICS, FASCIA SIGNS
GANNY SIGNS, VINYL ETC.

(b) Is the advertisement already being displayed?

YES/NO*

* delete as appropriate

7. Description of advertisement (see Note 4)

Size (m)

Illumination type

(i) } **AS DETAILED ON ATTACHED DRAWINGS**
(ii) }
(iii) }

(Continue on a separate sheet if necessary)

Period for which consent is sought (see Note 2)

5 YEARS

I enclose a cheque/money order for the appropriate fee of £

75

Signed

Dated

11/12/07

13 DEC 2007

SITE PLAN GENERAL NOTES

REPLACE / REPAINT ALL CAR PARK SIGNAGE TO CURRENT STANDARD.
ADD NEW SIGNAGE TO RECYCLING AREA.
REJUVENATION OF ALL WHITE LINING TO MAIN JUNCTIONS & PARKING BAYS.
ALL TROLLEY BAYS TO BE STEAM CLEANED.
REPLACE TROLLEY FLEET.
INSTALL TROLLEY RETENTION SYSTEM (INSTALL BY SURVEY).

CAR PARKING FIGURES	EXISTING	PROPOSED
STANDARD PARKING BAY	223	221
DISABLED PARKING BAY	16	16
PARENT & TODDLER PARKING BAY	10	10
TOTAL	249	247
OPEN TROLLEY BAY	06	06
COVERED TROLLEY BAY		
CAR PARK RATIO	1:12	1:12

AMENDMENTS	DATE
1. REFURBISH TROLLEY BAYS	11/07/07
2. INSTALL NEW AUTOMATED RECYCLING TOWER MACHINE	
3. REDUCE CUSTOMER COLLECT POINT	15/07/07
4. REVERT TO EXISTING CUSTOMER COLLECT POINT	15/09/07
5. RECYCLING REPLANNED	

HIGH PEAK BOROUGH COUNCIL
GLASSOP SITE
RECEIVED

13 DEC 2007

FILE REF
REPLY REC

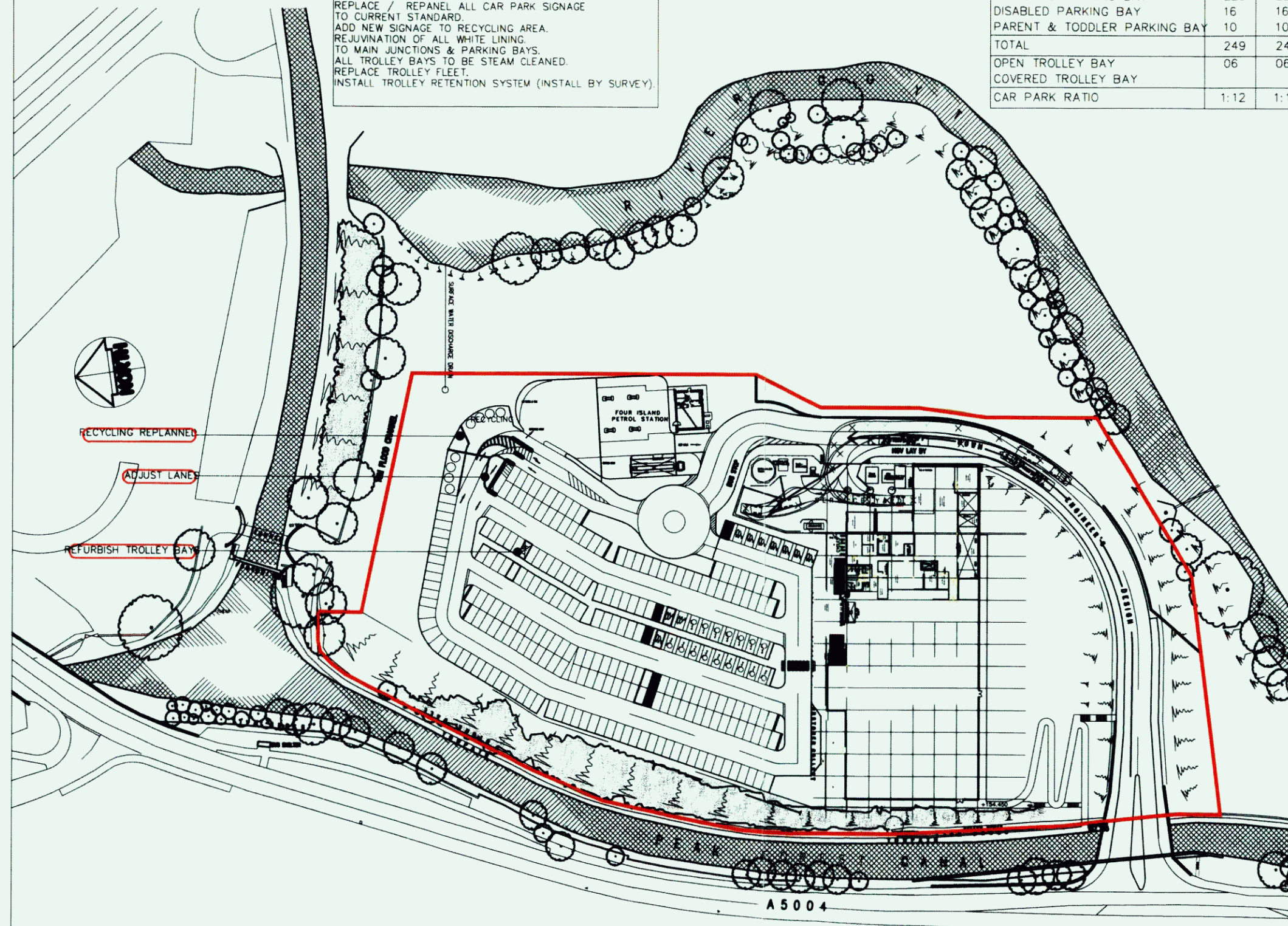

PROJECT
3412 F 23
WHALEY BRIDGE (16.2/1.9)

DESCRIPTION
FIVE YEAR REFRESH
PROPOSED SITE LAYOUT

DRAWING NO. 3412pag1C.dgn

PHASE 3 ISSUE 1C

SYSTEM ID No.

SCALE DATE
1:1250@A3 19.09.07

DRAWN HARVEY PHIPSON

TESCO
STORE PLANNING

TESCO STORES LIMITED
STORE PLANNING DEPARTMENT
PROPERTY SERVICES
P.O. BOX 400, GERRARD BUILDING, SHIRE PARK
WELWYN GARDEN CITY, HERTS AL7 1AB
TELEPHONE 01707 35150
FAX 01707 35151
E-MAIL: STORES@TESCO.COM