

I JOYCE BRYAN of 31 Reservoir Road, Whaley Bridge, High Peak SK23 7BL

DO SOLEMNLY AND SINCERELY DECLARE as follows:-

1. I have been a family friend of the late Mr. Charles William Gregory and the late Hilda Gregory for over 30 years. I have been a regular visitor over this time at the property 127 Bings Road Whaley Bridge High Peak SK23 7ND (hereinafter called "the Property")
2. The Property shown edged red on the plan annexed hereto marked plan ("Plan") has always to the best of my knowledge and belief been utilised for parking of visitors vehicles and family parking.
3. I confirm I have used the parking area marked shaded yellow on the plan attached marked Plan 2 (Plan 2) as the area I have parked upon when visiting the Property.

I MAKE THIS Solemn Declaration conscientiously believing the same to be true and by virtue of the Statutory Declarations Act 1835.

SWORN by JOYCE BRYAN  
At *Chapel-en-le-Frith*  
In the presence of

This *13<sup>th</sup>* day of *September* 2018

Cooper Sons Hartley and Williams  
Solicitors  
25 Market Street Chapel-en-le-Frith  
High Peak  
Derbyshire SK23 0HS  
Tel: 01298 812138 Fax: 01298 815097  
Email: legal@cshw.co.uk

This is the Exhibit marked 'Plan 1' referred to in the Statutory Declaration of  
Joyce Bryan Sworn before me this 13<sup>th</sup> day of September 2018

Solicitor

Cooper Sons Hartley and Williams  
Solicitors  
25 Market Street Chapel-en-le-Frith  
High Peak  
Derbyshire SK23 0HS  
Tel: 01298 812138 Fax: 01298 815097  
Email: legal@cshw.co.uk



HM Land Registry  
Official copy of  
title plan

Title number **DY515860**  
Ordnance Survey map reference **SK0181NE**  
Scale **1:1250** enlarged from 1:2500  
Administrative area **Derbyshire: High Peak**

© Crown copyright and database rights 2017 Ordnance Survey 100026316.  
You are not permitted to copy, sub-license, distribute or sell any of this data to third parties in any form.



Silk Hill Farm

139

125

82

80

111

105

83

'PLAN1'

**This official copy issued on 14 December 2017 shows the state of this title plan on 14 December 2017 at 15:04:38.**

It is admissible in evidence to the same extent as the original (s.67 Land Registration Act 2002).

This title plan shows the general position, not the exact line, of the boundaries. It may be subject to distortions in scale. Measurements scaled from this plan may not match measurements between the same points on the ground.

**This title is dealt with by HM Land Registry, Nottingham Office.**

This is the Exhibit marked 'Plan 2' referred to in the Statutory Declaration of  
Joyce Bryan Sworn before me this 13<sup>th</sup> day of September 2018

Solicitor

Cooper Sons Hartley and Williams  
Solicitors  
25 Market Street Chapel-en-le-Frith  
High Peak  
Derbyshire SK23 0HS  
Tel: 01298 812138 Fax: 01298 815097  
Email: legal@cshw.co.uk

PLAN 2'

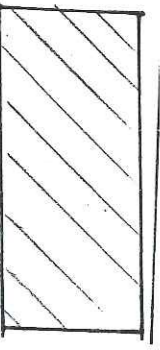
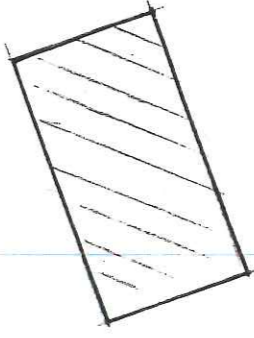
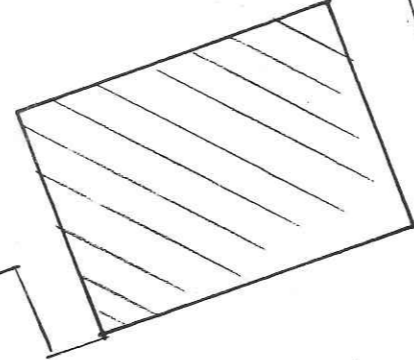
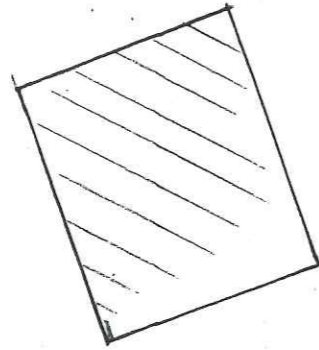
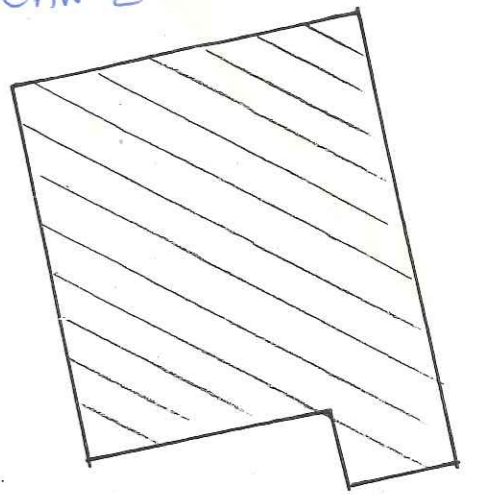
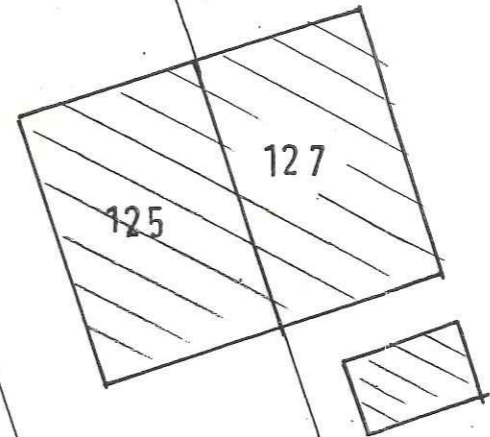
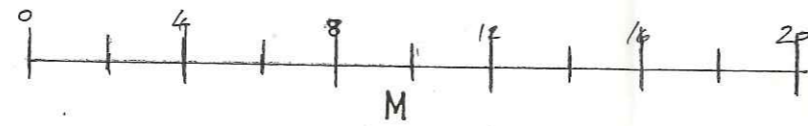

site plan

1 : 200