

EXISTING PLANS

SCALE 1:100

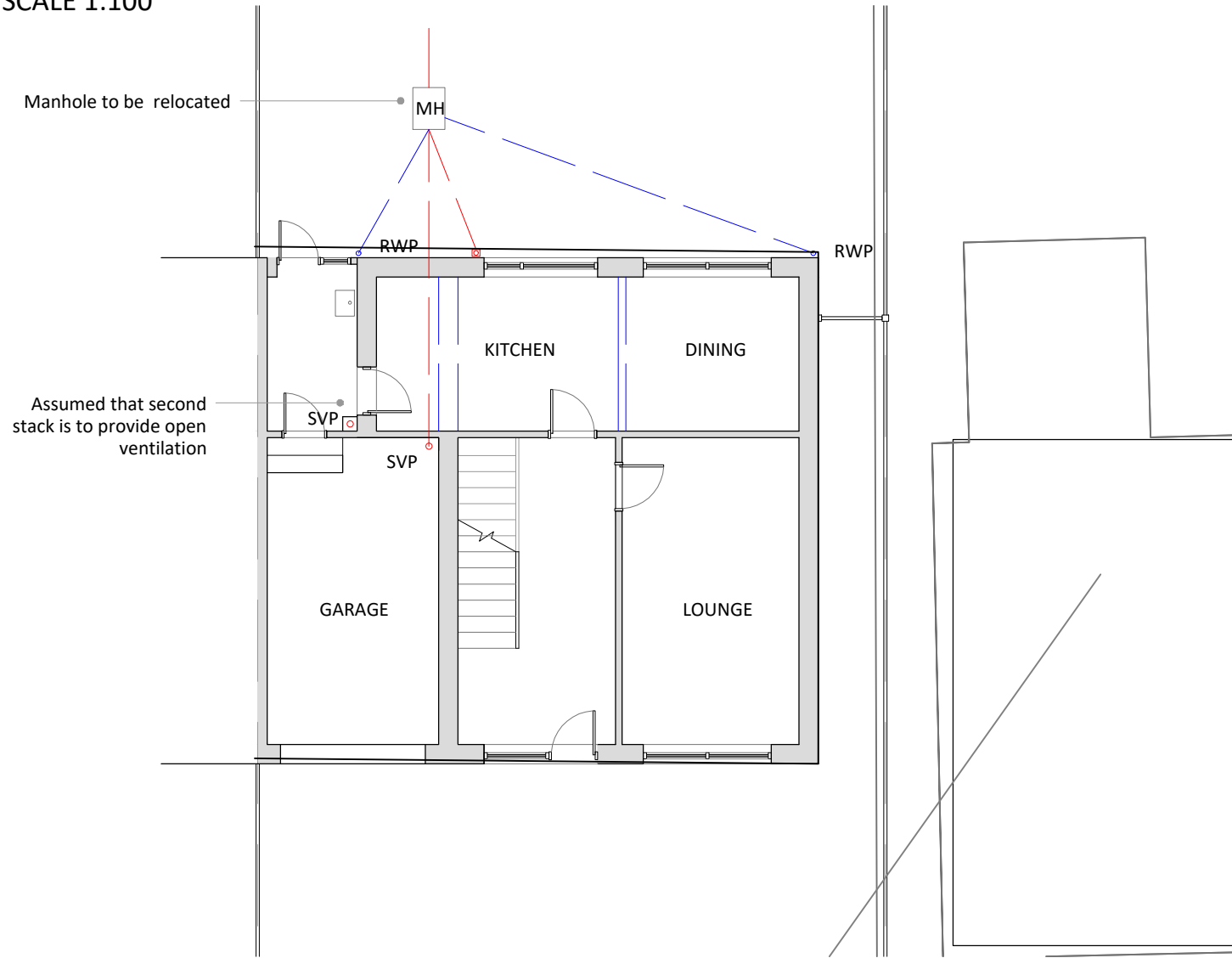

EXISTING ROOF PLAN

SCALE 1:100

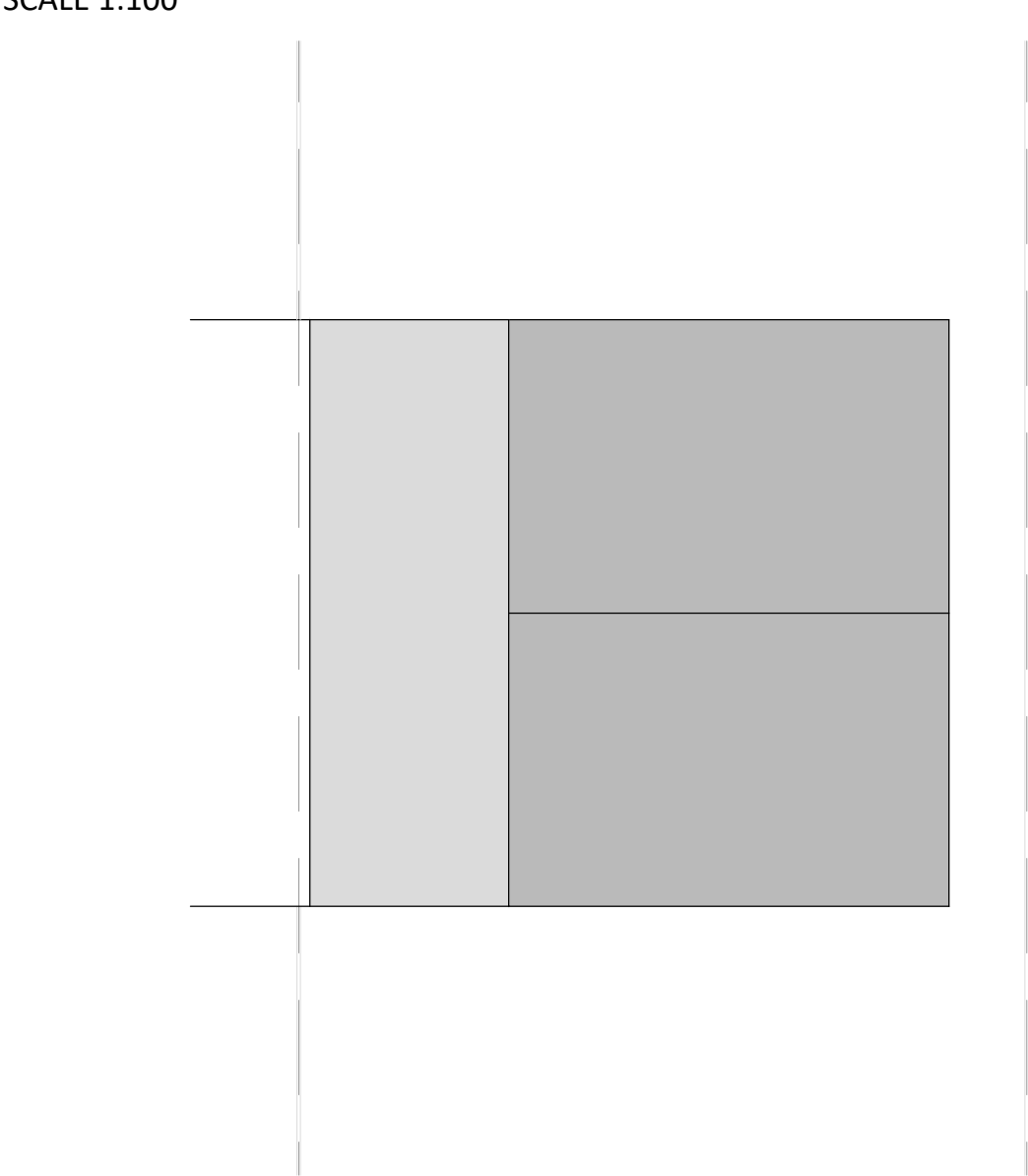

PROPOSED PLAN

SCALE 1:50

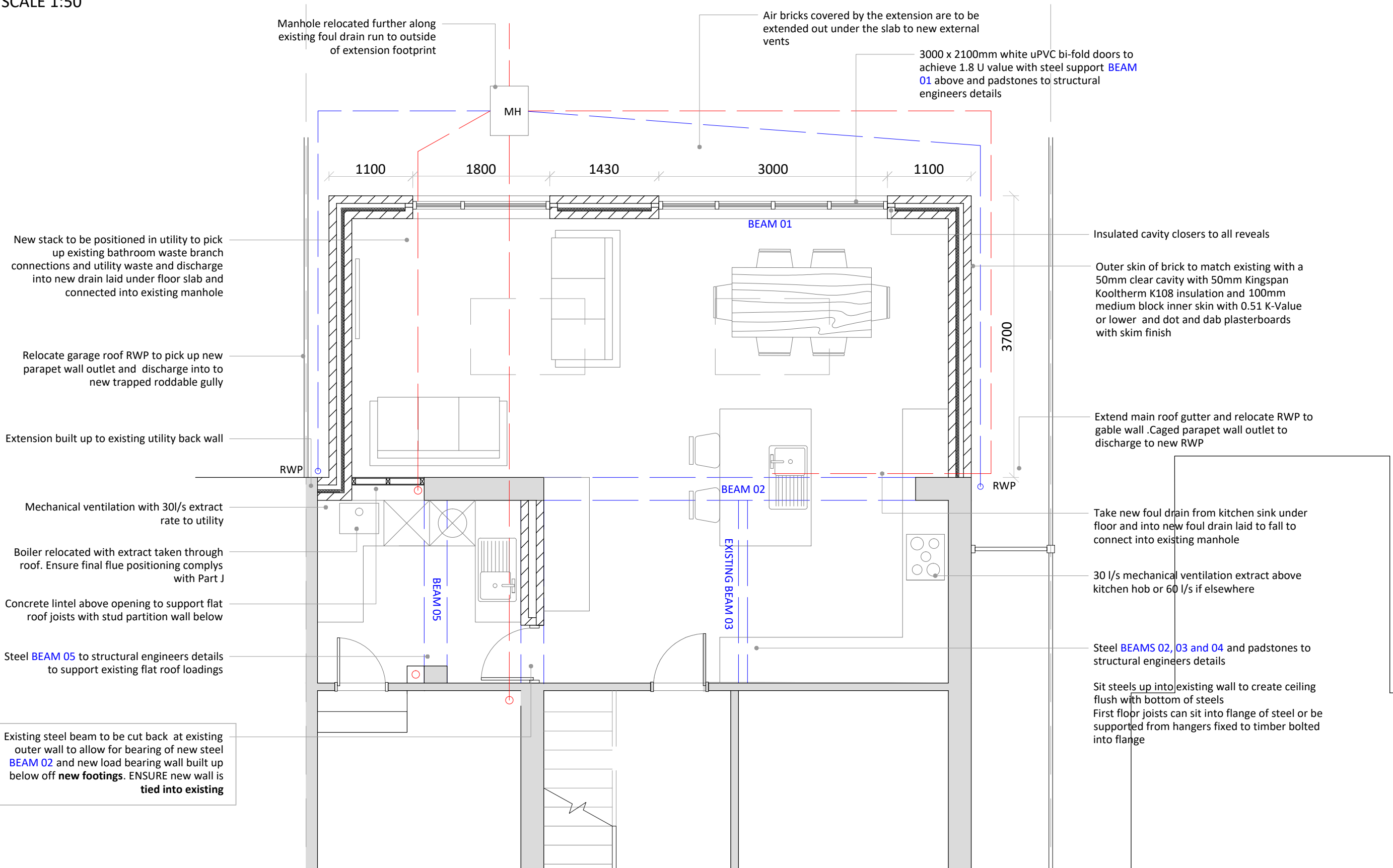

PROPOSED ROOF STRUCTURE PLAN

SCALE 1:50

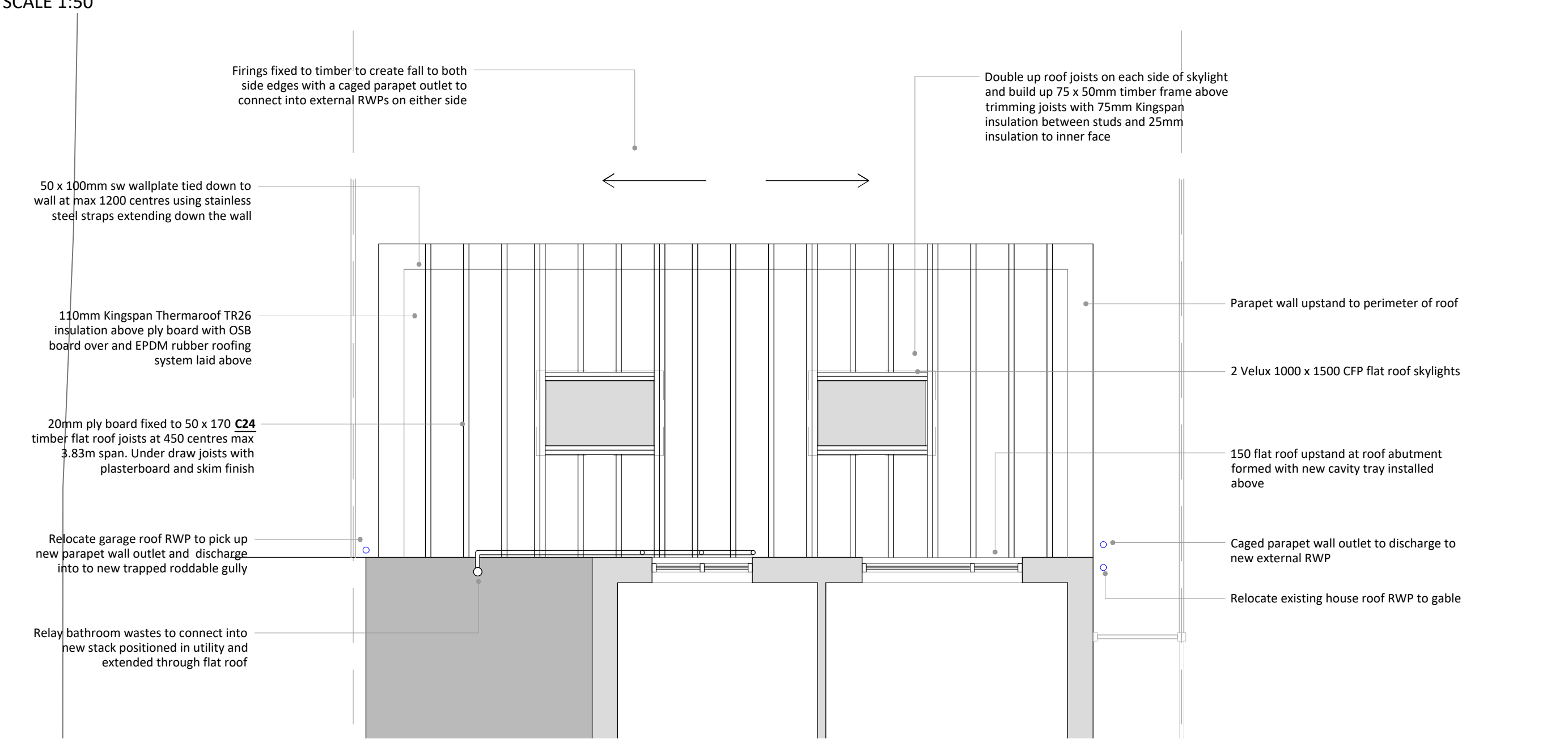

FLAT ROOF JUNCTION ABOVE UTILITY

SCALE 1:10

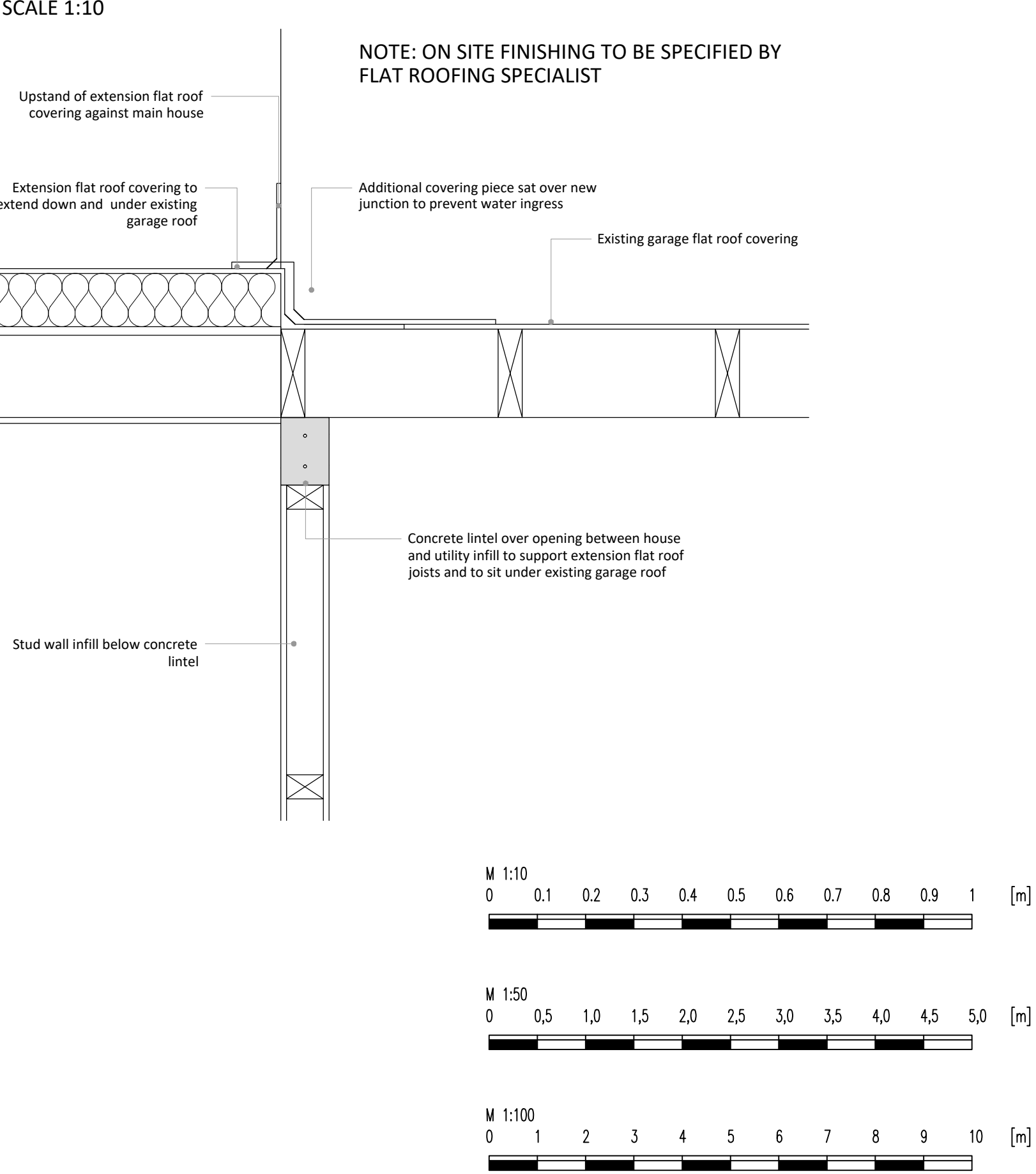

PLANS ARE TO BE READ IN CONJUNCTION WITH STRUCTURAL ENGINEERS DETAILS

IT IS THE RESPONSIBILITY OF THE CONTRACTOR TO CHECK ALL MEASUREMENTS ON SITE PRIOR TO WORK COMMENCING

PLEASE CONTACT PLAN DRAWER IF ANY ON SITE AMENDMENTS ARE TO BE MADE

Building Regulations Plans

Single-Storey Rear Extension

25 North Brook Road
Hadfield
Glossop
SK13 2EZ

Scale - 1:100 @ A1
unless stated
Drawn By - EH
Date - 08.2018

Rev	Description	Date
A	Depth reduced by 300mm	14/08

DRAWING REF: 25NB/BR/02/A

Plans & Design

Emma Hall MBEng BA honrs
www.plansanddesign.co.uk
07912 845 210

INTERNAL LOADBEARING MASONRY PARTITIONS

Construct load bearing internal masonry partitions using dense concrete blocks built off concrete foundation. Concrete mix to conform to BS EN 206-1. Depth to engineers details and dependent on ground conditions to be agreed with BCO. Wall tied at 225mm centres with proprietary steel profiles or block bonded to all internal and external walls. Walls faced throughout with 12.5mm plasterboard on dabs with skim plaster finish or 13mm lightweight plaster.

ELECTRICAL

All electrical work required to meet the requirements of Part P (electrical safety) must be designed, installed, inspected and tested by a competent person registered under a competent person self certification scheme such as BRE certification Ltd, BS, NICC/C, Certification Services or Zurich Ltd. An appropriate BS7671 Electrical Installation Certificate is to be issued for the work by a person competent to do so. A copy of a certificate will be given to Building Control on completion.

INTERNAL LIGHTING

Install low energy light fittings that only take lamps having a luminous efficiency greater than 45 lumens per circuit watt and a total output greater than 400 lamp lumens. Not less than three energy efficient light fittings per four of all the light fittings in the main dwelling spaces to comply with Part L of the current Building Regulations and the Domestic Building Services Compliance Guide.

HEATING

Extend all heating and hot water services from existing and provide new TVRs to radiators. Heating system to be designed, installed, tested and fully certified by a GAS SAFE registered specialist.

All work to be in accordance with the Local Water Authorities bye laws, the Gas Safety (Installation and Use) Regulations 1998 and IEE Regulations.

ROOF LIGHTS

Min U-value of 1.6 W/m²K.

Roof-lights to be double glazed with 16mm argon gap and soft low-E glass. Window Energy Rating to be Band C or better. Roof lights to be fitted in accordance with manufacturer's instructions with rafters doubled up to sides and suitable flashings etc.

NEW AND REPLACEMENT WINDOWS

New and replacement windows to be double glazed with 16mm argon gap and soft coat low-E glass. Window Energy Rating to be Band C or better and to achieve U-value of 1.6 W/m²K. The door and window openings should be limited to 25% of the extension floor area plus the area of any existing openings covered by the extension.

NEW AND REPLACEMENT DOORS

New and replacement doors to achieve a U-Value of 1.80W/m²K. Glazed areas to be double glazed with 16mm argon gap and soft low-E glass. Glass to be toughened or laminated safety glass to BS 6206, BS EN 14179 or BS EN ISO 12543-1:2011 and Part K (Part N in Wales) of the current Building Regulations.

BACKGROUND AND PURGE VENTILATION

Background ventilation - Controllable background ventilation via trickle vents to BS EN 13141-3 within the window frame to be provided to new habitable rooms at a rate of min 5000mm²; and to kitchens, bathrooms, WCs and utility rooms at a rate of 2500mm²

Purge ventilation - New Windows/rooflights to have openable area in excess of 1/20th of their floor area, if the window opens more than 30° or 1/10th of their floor area if the window opens less than 30°

Internal doors should be provided with a 10mm gap below the door to aid air circulation. Ventilation provision in accordance with the Domestic Ventilation Compliance Guide.

EXTRACT TO UTILITY & KITCHEN

Utility to have mechanical vent ducted to external air to provide min 30 litres / sec extraction. Vent to be connected to light switch and to have 15 minute over run if no window in room.

Kitchen to have mechanical ventilation with an extract rating of 60l/sec or 30l/sec if adjacent to hob to external air, sealed to prevent entry of moisture. Internal doors should be provided with a 10mm gap below the door to aid air circulation. Ventilation provision in accordance with the Domestic Ventilation Compliance Guide. Intermittent extract fans to BS EN 13141-4. Cooker hoods to BS EN 13141-3. All fixed mechanical ventilation systems, where they can be tested and adjusted, shall be commissioned and a commissioning notice given to the Building Control Body.

RAINWATER DRAINAGE

New rainwater goods to be new 110mm UPVC half round gutters taken and connected into 68mm dia UPVC downpipes. Rainwater taken to new soakaway, situated a min distance of 5.0m away from any building, via 110mm dia UPVC pipes surrounded in 150mm granular fill. Soakaway to be min of 1 cubic metre capacity (or to depth to Local Authorities approval) with suitable granular fill and with geotextile surround to prevent migration of fines. If necessary carry out a porosity test to determine design and depth of soakaway. Where this is not achievable connect into existing surface water drainage.

UNDERGROUND FOUL DRAINAGE

Underground drainage to consist of 100mm diameter UPVC proprietary pipe work to give a 1:40 fall. Surround pipes in 100mm pea shingle. Provide 600mm suitable cover (900mm under drives). Shallow pipes to be covered with 100mm reinforced concrete slab over compressible material. Provide rodding access at all changes of direction and junctions. All below ground drainage to comply with BS EN 1401-1: 2009.

INSPECTION CHAMBERS

Underground quality proprietary UPVC 450mm diameter inspection chambers to be provided at all changes of level, direction, connections and every 45m in straight runs. Inspection chambers to have bolt down double sealed covers in buildings and be adequate for vehicle loads in driveways.

ABOVE GROUND DRAINAGE

All new above ground drainage and plumbing to comply with BS EN 12056-2:2000 for sanitary pipework. All drainage to be in accordance with Part H of the Building Regulations. Wastes to have 75mm deep anti vac bottle traps and rodding eyes to be provided at changes of direction.

Size of wastes pipes and max length of branch connections (if max length is exceeded then anti vacuum traps to be used)

Wash basin - 1.7m for 32mm pipe 3m for 40mm pipe

Bath/shower - 3m for 40mm pipe 4m for 50mm pipe

W/c - 6m for 100mm pipe for single WC

All branch pipes to connect to 110mm soil and vent pipe terminating min 900mm above any openings within 3m.

Or to 110mm upvc soil pipe with accessible internal air admittance valve complying with BS EN 12380, placed at a height so that the outlet is above the trap of the highest fitting.

Waste pipes not to connect on to SVP within 200mm of the WC connection. Supply hot and cold water to all fittings as appropriate.

SOIL AND VENT PIPE

Svp to be extended up in 110mm dia UPVC and to terminate min 900mm above any openings within 3m. Provide a long radius bend at foot of SVP.

PIPEWORK THROUGH WALLS

Where new pipework passes through external walls form rocker joints either side wall face of max length 600mm with flexible joints with short length of pipe bedded in wall.

Alternatively provide 75mm deep pre-cast concrete plank lintels over drain to form opening in wall to give 50mm space all round pipe: mask opening both sides with rigid sheet material and compressible sealant to prevent entry of fill or vermin.