

PROPOSED SIDE (WESTERN) ELEVATION

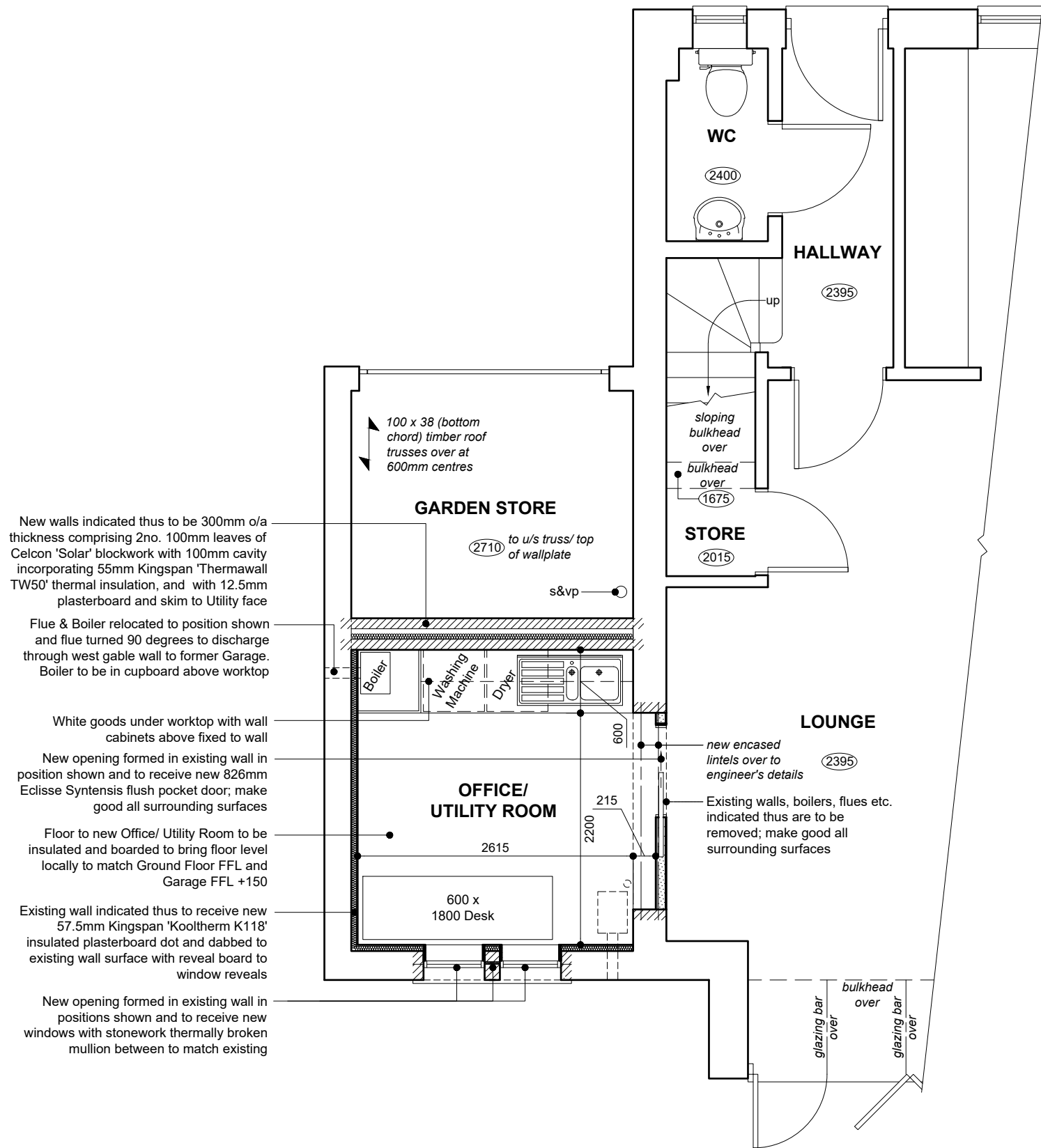

PROPOSED PART REAR (SOUTHERN) ELEVATION



PROPOSED PART GROUND FLOOR PLAN

NOTES
All dimensions are to be checked on site and any discrepancies referred to the designer prior to proceeding. All levels are to be confirmed on site prior to proceeding with the work. All discrepancies between information shown on the drawing and the information shown on the specification are to be referred to the designer prior to proceeding with the work. All component sizes and references to be checked prior to the ordering of materials. Positions of existing drain runs and associated installations to be confirmed prior to proceeding and drains checked as necessary. All relevant boundary positions to be checked prior to proceeding. Any on site design changes must be reported to the designer and agreed with the relevant authority prior to proceeding. Levels shown are related to an arbitrary datum and therefore not related to Ordnance datum.

A	13.02.18	Amended following client review
Revision	Date	Details

ra Grundy R.A Grundy Architectural Services 30, PARK ROAD, HADFIELD, GLOSSOP, DERBYSHIRE SK13 2AH TEL: 0774 501 3662 E-MAIL: info@grundy1@hotmail.co.uk	
Project:	Proposed Alterations to: 10 Mill Street Glossop Derbyshire SK13 9PT
Client:	Hannah Charlesworth
Drawing Title:	PROPOSED PLANS AND ELEVATIONS
Drawn by:	R.G.
Date:	10th January 2017
Drawing No.:	1803P.02
Scale:	1:50 @ A1
Revision:	A

