



General Notes

- DO NOT SCALE.
- This drawing is to be read in conjunction with all other relevant drawings and details.
- Should there be any conflict between the details indicated on this drawing and those indicated on other drawings the Engineer should be informed PRIOR to construction on site.
- Until technical approval has been obtained from the relevant Authority, it should be understood that all drawings issued are Preliminary and NOT for construction. Should the contractor commence site work prior to such approval being given, it is entirely at his own risk.
- All dimensions are in millimetres unless otherwise stated.
- The BSP Hazard Identification and Risk Assessment information for this project must be reviewed and understood by the contractor PRIOR to the commencement of any works on site.

Structural Steelwork Notes

- The steelwork is to be designed by the contractor. The location of members including bracing is to be as detailed.
- In the absence of a project specific specification the base Specification for structural steelwork shall be BS EN 1993 - 'Design of Steel Structures' and the 'National Steelwork Specification' produced by the B.C.S.A.
- Structural steelwork to be grade S355 JR for all internal steelwork and S355 J0 for all external steelwork unless noted otherwise.
- All beams/stanchions shall be located symmetrically on grid lines unless noted otherwise.
- All levels shown thus TOS (76.995) are to tops of beams or stanchions unless noted otherwise.
- All connections shall have a minimum of 4 No bolts and be designed for a minimum 75 kN (ultimate) reaction unless noted otherwise.
- For details of fire protection to steelwork refer to Architect's details.
- Design of all temporary works, propping and bracing shall be the responsibility of the Contractor.
- Where dissimilar steels are to be connected a suitable isolating material shall be incorporated.
- Unless otherwise noted in the project specific specification, protection treatment of steelwork shall be in accordance with Tata 'Prevention of Corrosion of Structural Steelwork' appropriate system. A minimum structural life of 50 years and a first major maintenance of 15 years is to be assumed.
- All steelwork faces above ground slab level which are hidden and therefore cannot be maintained (eg. steelwork built into cavity walls) is to be given 2 coats of RIW 'Liquid Asphaltic Compound' by the Principal Contractor. RIW not to be used on steel surfaces which receive intumescent or other coatings.
- The Contractor is to ensure that any shop or site applied primers are compatible with any finishing, intumescent or R.I.W. coatings which may be applied by the Principal Contractor.
- The Contractor shall submit copies of his drawings to both the Architect and Engineers for comments a minimum of 7 days prior to manufacture.
- Refer to the Architect for clear opening requirements to ensure no interference from bolts/nuts/shanks etc.

Site Survey

- All dimensions shown are to be confirmed and checked by the steelwork contractor prior to the manufacture of steelwork.
- Any major discrepancies between information given on this drawing and information gathered by the steelwork contractor must be reported to BSP engineer prior to manufacture of steelwork.

All dimensions marked thus * are to be established on site

An assumption of sound/solid brickwork of 20.5N/mm² for fixings. BSP Engineer to be notified if wall construction is not as expected.

The details included on this drawing are for temporary solution only.

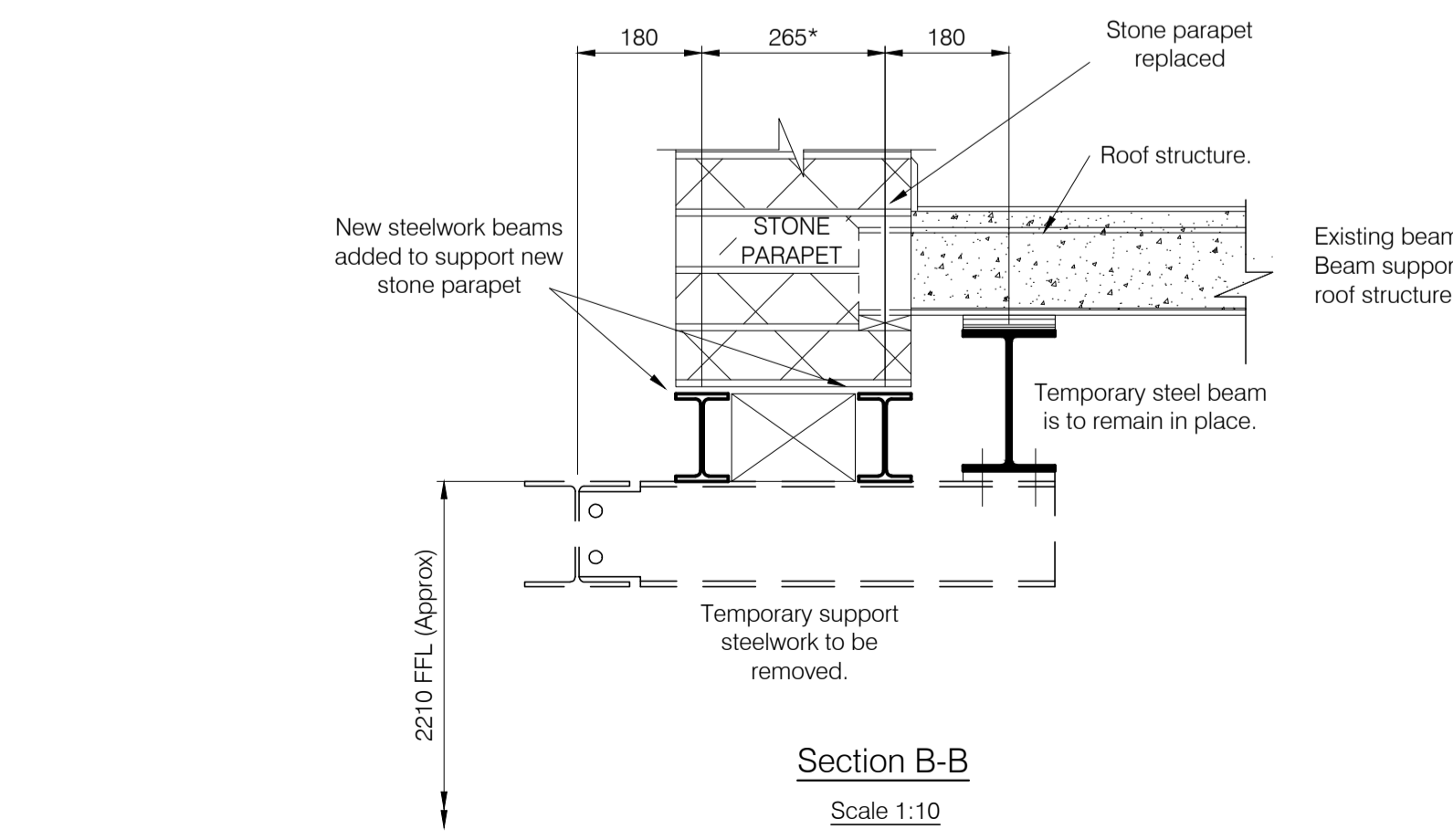
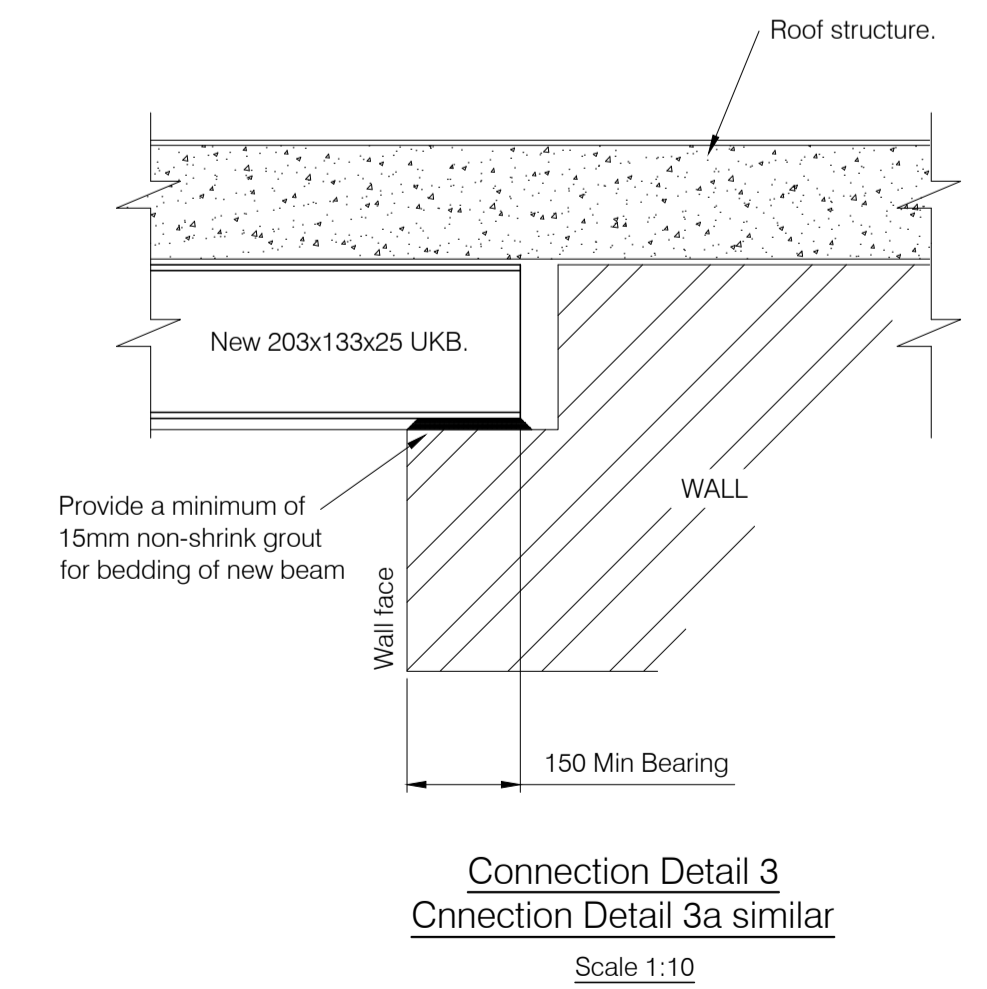
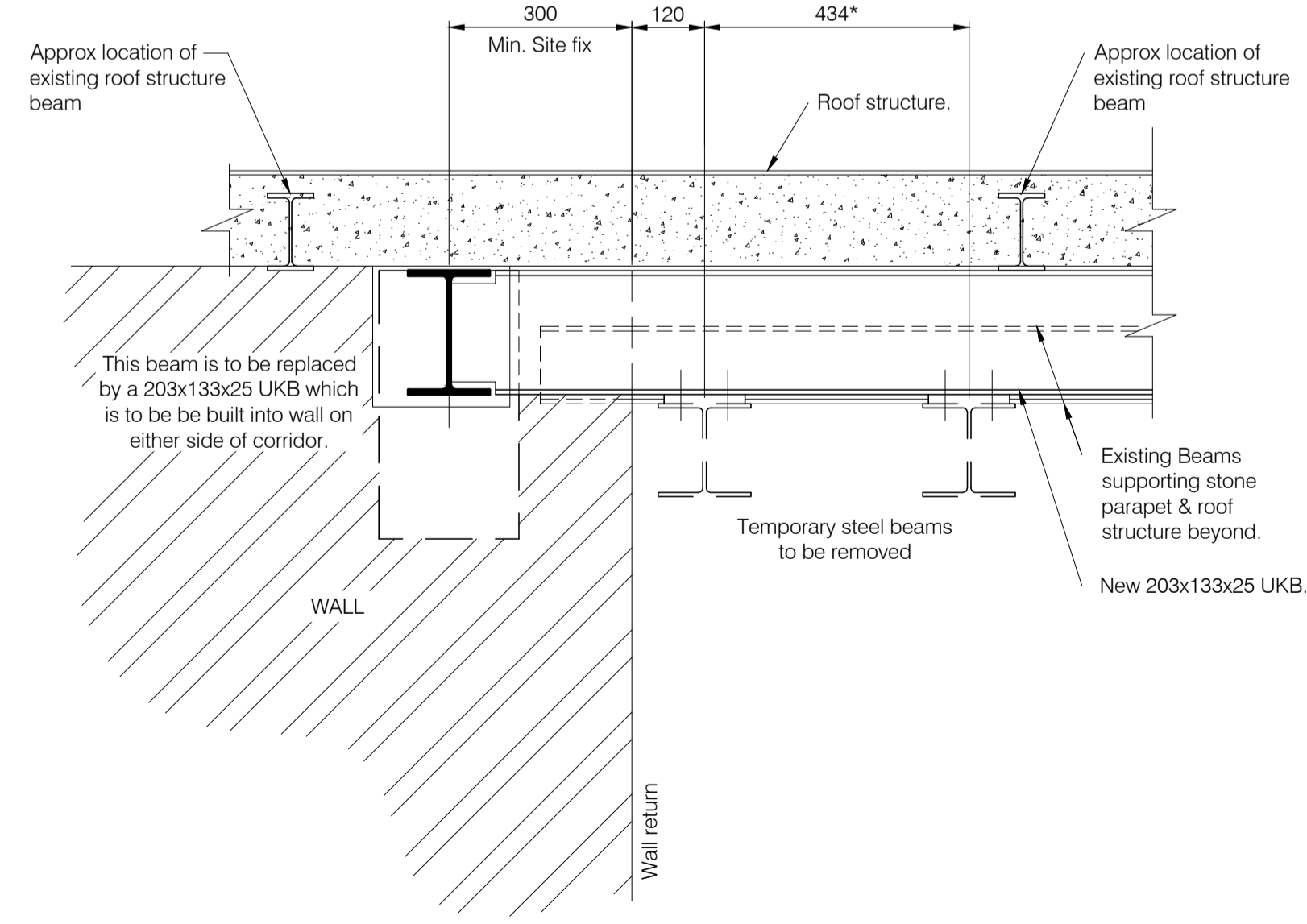
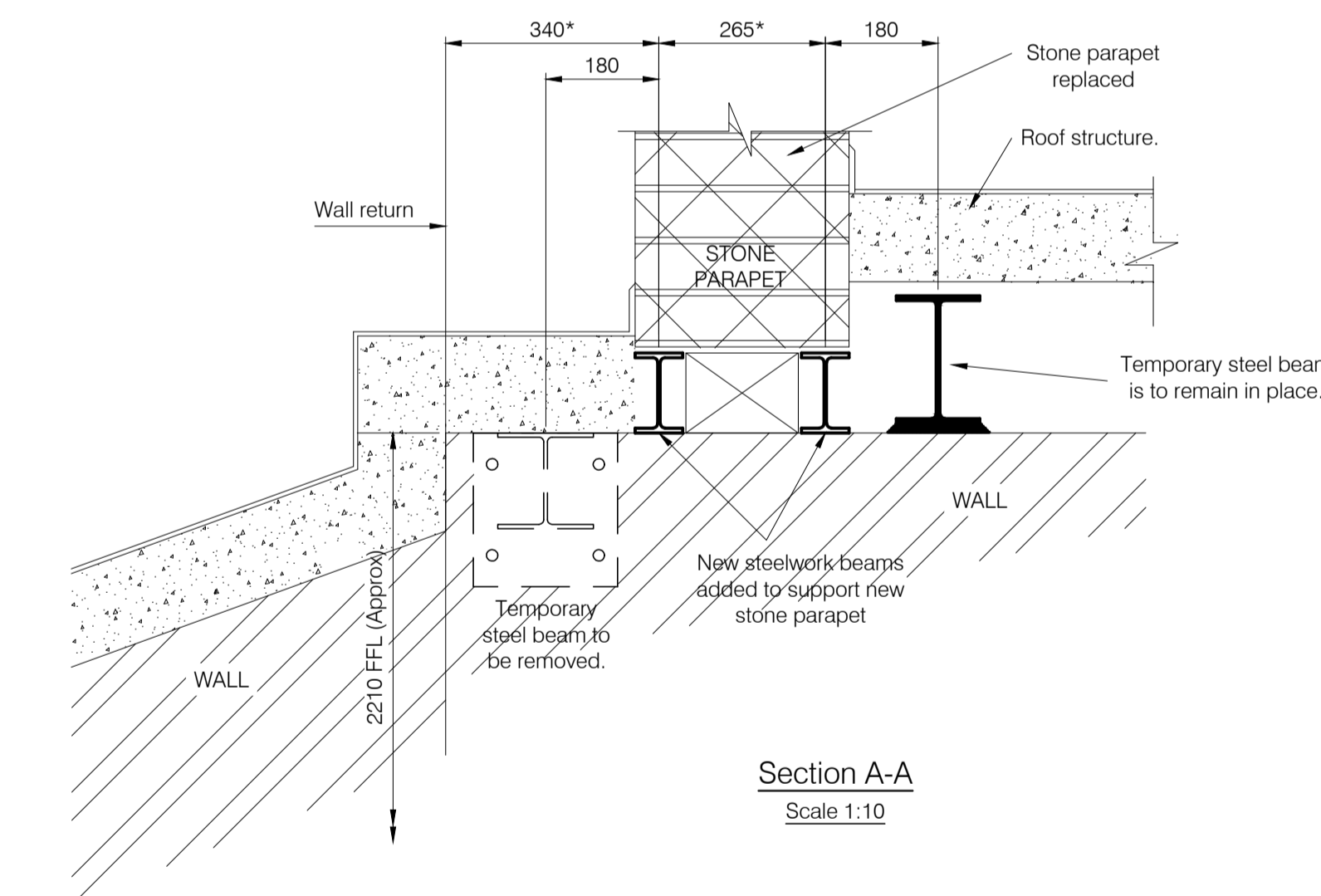
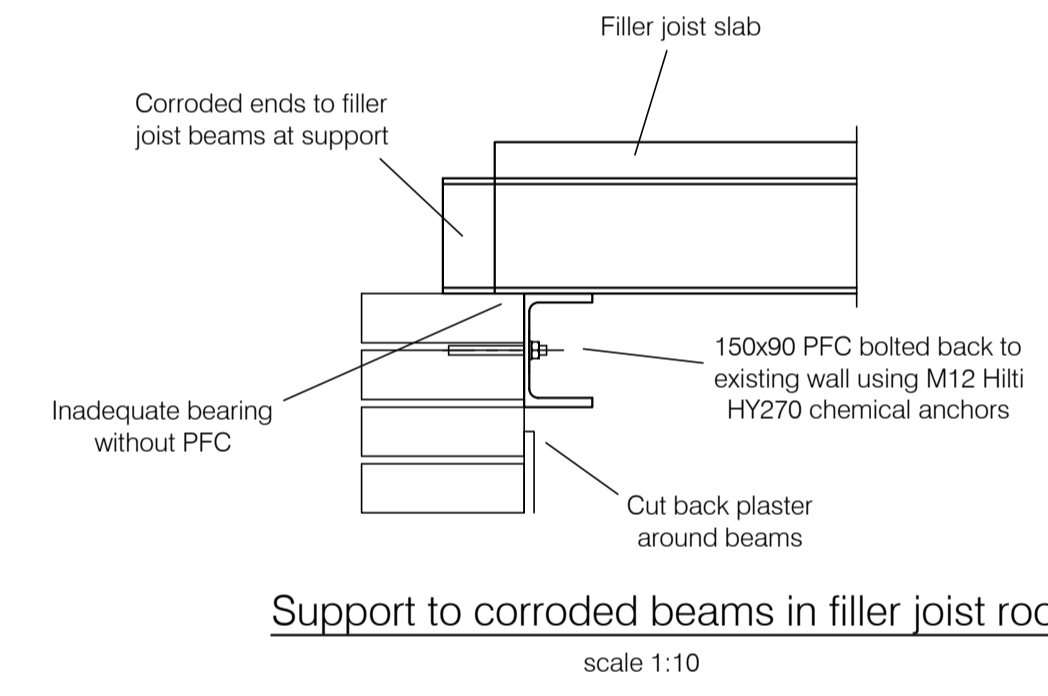
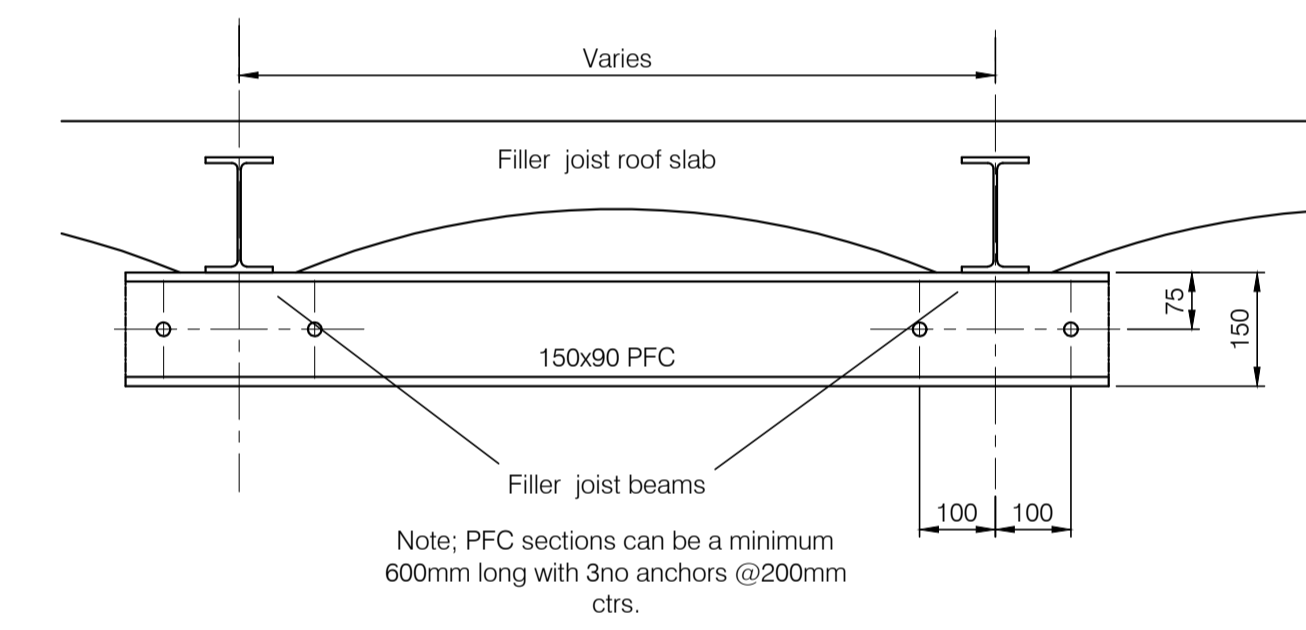
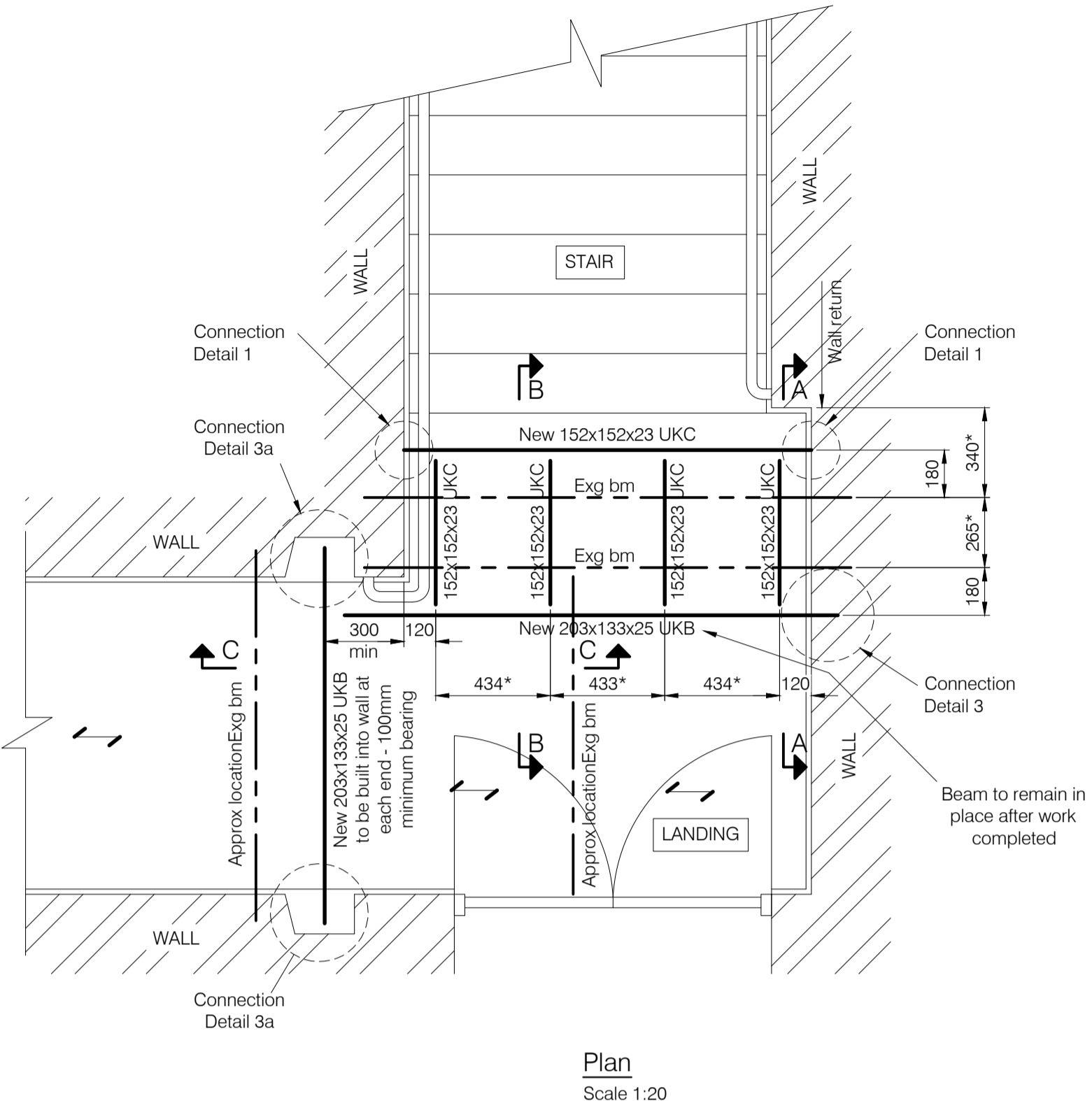
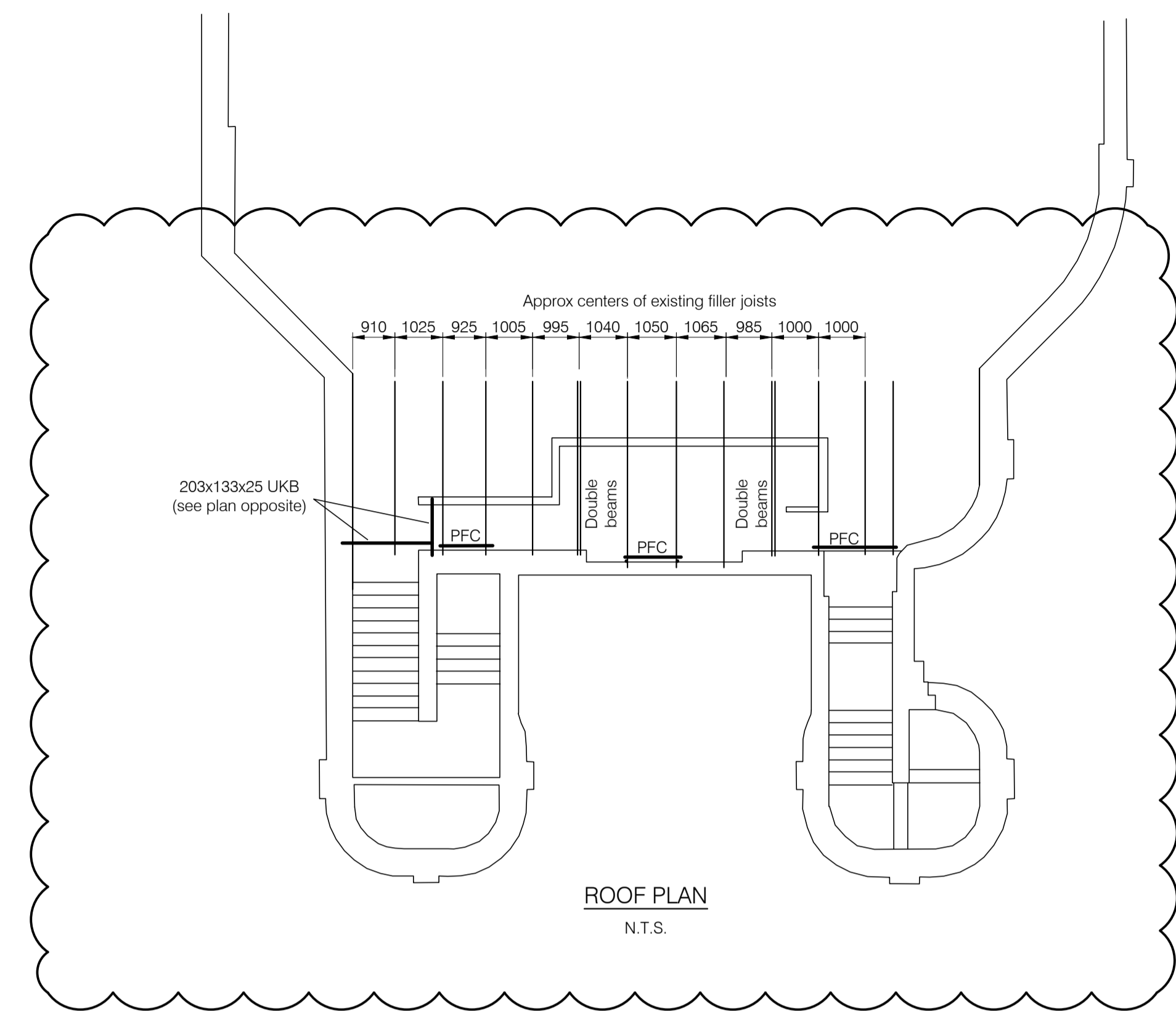

Rev.	Description	Date	Drawn	Appr.
C	AMENDED TO SUIT ARCHITECTS COMMENTS	05-10-2017	PKB	CR
B	REVISED TO INDICATE SUPPORT STEEL TO CORRODED ROOF FILLER JOISTS	04-10-2017	PKB	CR
A	Section size revised where clouded.	17-11-2016	SPM	MA
/	Preliminary Issue	16-11-2016	SPM	MA

bsp CONSULTING
5 Pride Point Drive, Pride Park, Derby, DE24 6BX
Tel: (01332) 374880 - Fax: (01332) 374889
e-mail: info@bsp-consulting.co.uk
Also offices in Nottingham, Leicester and Sheffield

PRELIMINARY

Client: T.A.D. Architects

Project Title: Buxton Opera House

Drawing Title: Temporary Strengthening Works General Arrangement & Details

Drawn By: SPM Checked By: MA Scale: 1:100/1:20
Project Engineer: MA Approved By: MA Date: November 2016
Drawing Number: 16379/ 300 Revision: C