

+ 143.700

This drawing is prepared for application for planning permission. All copies are for information about the application only and may not be used for other purposes, including construction, without the express permission of the Architect. Copyright of the drawings and design remains the Architect's. This drawing has in part been prepared from information supplied, and whilst this appears to be reasonably accurate all dimensions are to be checked for exactness. It is not intended that the drawings are sufficiently accurate for other purposes. Critical dimensions to be taken from the building, not drawings. No inspection has been made of the structural integrity of the walls, foundations, beams, floor, nor any other material, nor of the connections between them. Information on these matters should be obtained from a structural engineer.

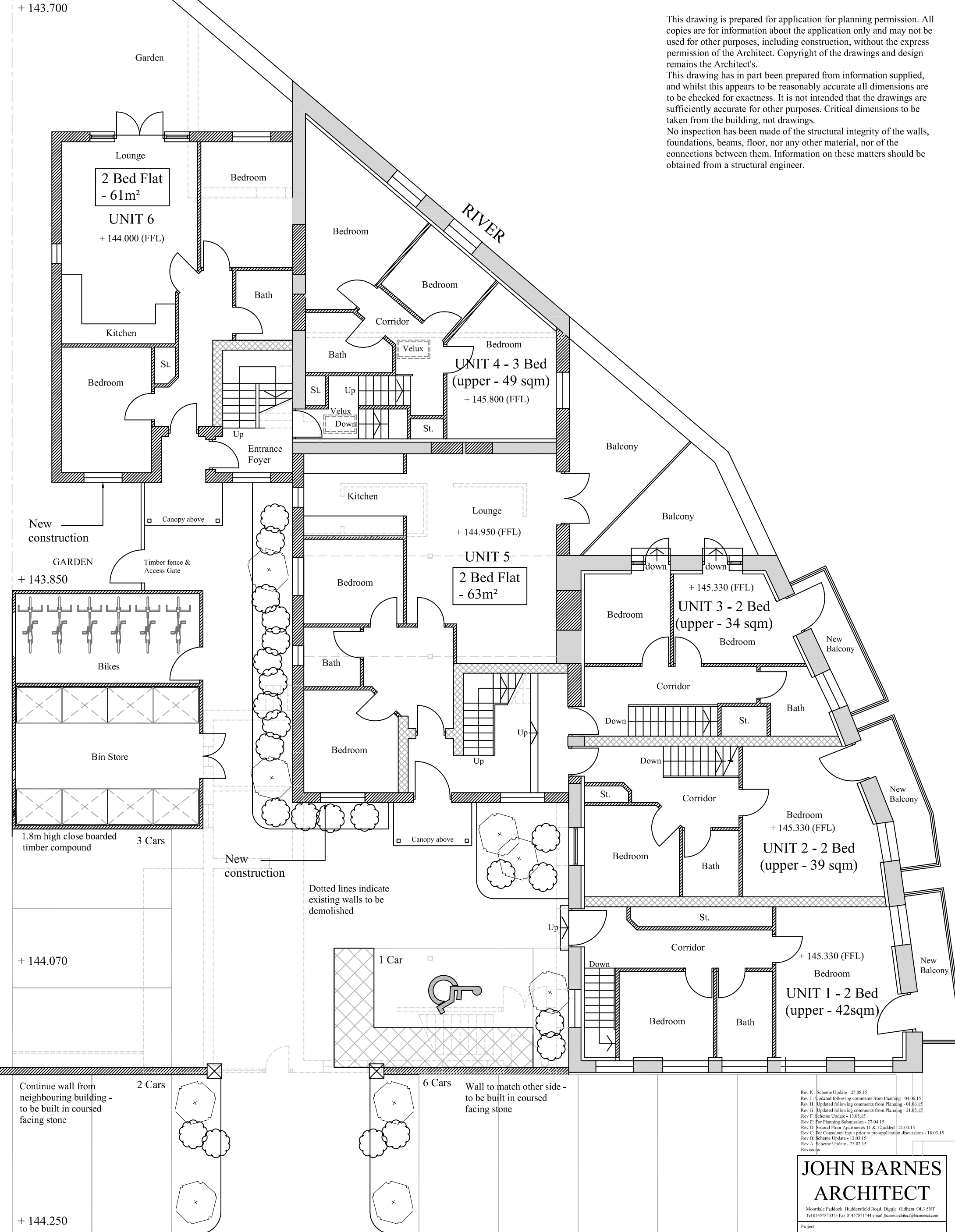

PROPOSED GROUND FLOOR PLAN

This drawing should be printed at A3 size in order to be read at 1:100 as indicated. Check scale bar to confirm printed scale before using any scale rule.

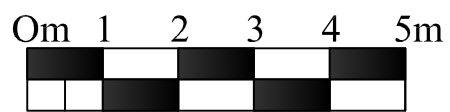

- Rev K: Scheme Update - 25.08.15
- Rev J: Updated following comments from Planning - 04.06.15
- Rev H: Updated following comments from Planning - 01.06.15
- Rev G: Updated following comments from Planning - 21.05.15
- Rev F: Scheme Update - 13.05.15
- Rev E: For Planning Submission - 27.04.15
- Rev D: Second Floor Apartments 11 & 12 added - 21.04.15
- Rev C: For Consultant input prior to pre-application discussions - 18.03.15
- Rev B: Scheme Update - 12.03.15
- Rev A: Scheme Update - 25.02.15
- Revisions

JOHN BARNES ARCHITECT
 Moordale Paddock, Huddersfield Road, Diggle, Oldham, OL3 5NT
 Tel: 01457873373 Fax: 01457871744 email: johnbarnesarchitect@btconnect.com

Project: Riverside Mill, George Street, Glossop

Drawing: Ground Floor Plan as Proposed

Scale: 1:100@A3	Drawing No: 08K
Date: OCT 2014	

© Copyright John Barnes Do not scale off this drawing