

STATUTORY DECLARATION AS TO THE HISTORIC AND CONTINUED USE OF LAND AT TONGUE
LANE INDUSTRIAL ESTATE

By

David Melody

I, David Melody, of 20 WINDSOR PARK ROAD FAIRFIELD BUXTON SK17 7NP

do solemnly and sincerely declare, that:

1. I have worked for Lomas Distribution Limited as a HGV driver since 29 June 1998. Lomas Distribution Limited provides drivers to LD Transport Services Limited (**LDTS**) to drive vehicles operated by LDTS out of the site known as Unit 15 Tongue Lane Industrial Estate as shown outlined red on Exhibit 1 to this statutory declaration (the **Site**).
2. For in excess of 10 years I have been based at the Site where I would park my HGV vehicle and HGV trailer. In addition, drivers would also park their cars at the Site and regular maintenance and repair would be undertaken on the HGV vehicles and HGV trailers.
3. I can confirm that for in excess of 10 years LDTS and Irene Warnock trading as JWA (Antiques) Transport (**JWA**) have operated HGV vehicles and HGV trailers from the Site.
4. For in excess of 10 years the Site has always been used on a continuous and uninterrupted basis with access 24/7 and 365 days each year without limitation.

and I make this solemn declaration conscientiously believing the same to be true, and by virtue of the provisions of the Statutory Declarations Act 1835.

SIGNED and DECLARED AT

This 30 day of March 2017

By David Melody

Before me

COOPER & SONS HARTLEY & WILLIAMS
9 TERRACE ROAD
BUXTON
DERBYSHIRE SK17 0BU

SER - 0024

Land Registry
Current title plan

Title number **DY339661**
Ordnance Survey map reference **SK0773NW**
Scale **1:1250**
Administrative area **Derbyshire : High Peak**



EXHIBIT 1

©Crown Copyright. Produced by Land Registry. Reproduction in whole or in part is prohibited without the prior written permission of Ordnance Survey. Licence Number 100026316.

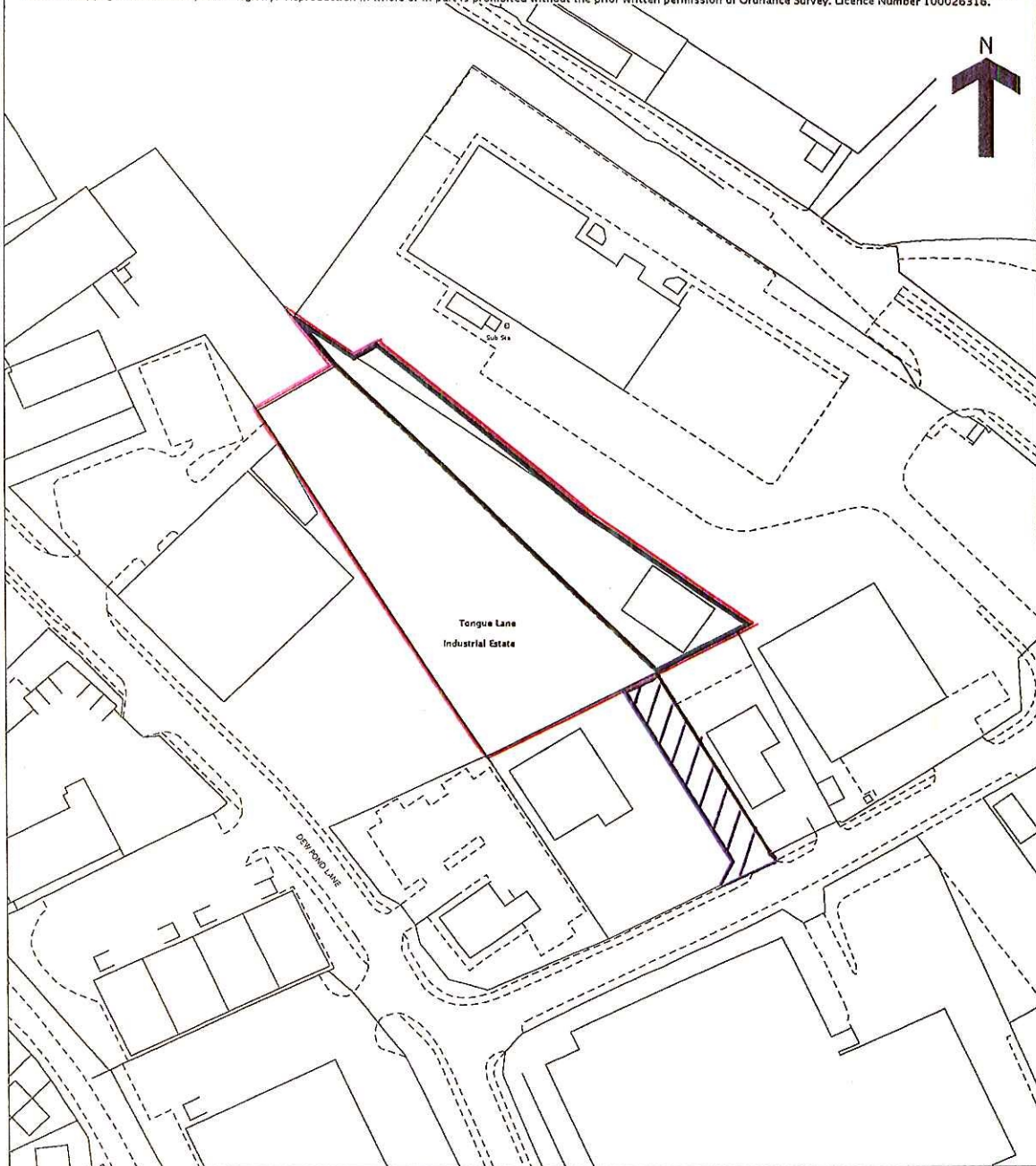

This is a copy of the title plan on 16 AUG 2016 at 12:36:05. This copy does not take account of any application made after that time even if still pending in the Land Registry when this copy was issued.

This copy is not an 'Official Copy' of the title plan. An official copy of the title plan is admissible in evidence in a court to the same extent as the original. A person is entitled to be indemnified by the registrar if he or she suffers loss by reason of a mistake in an official copy. If you want to obtain an official copy, the Land Registry web site explains how to do this.

The Land Registry endeavours to maintain high quality and scale accuracy of title plan images. The quality and accuracy of any print will depend on your printer, your computer and its print settings. This title plan shows the general position, not the exact line, of the boundaries. It may be subject to distortions in scale. Measurements scaled from this plan may not match measurements between the same points on the ground.

This title is dealt with by Land Registry, Nottingham Office.