

- Notes:
- 1. Do not scale from this drawing
 - 2. This drawing is copyright and may not be copied or given to a third party without written authority from Ashley Helme Associates Ltd
 - 3. Subject to detailed design
 - 4. Based upon digitised OS plan and topographical survey

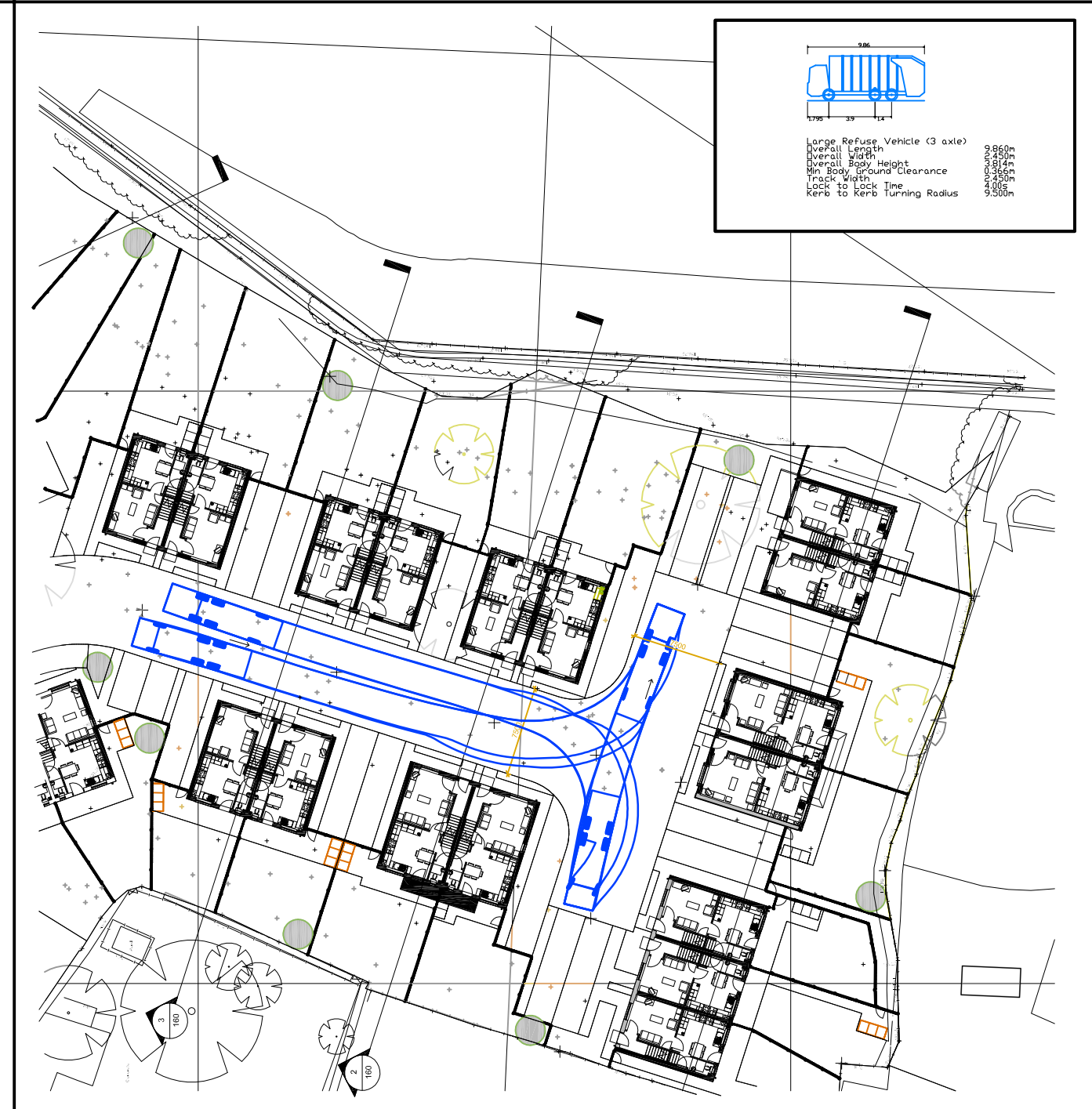
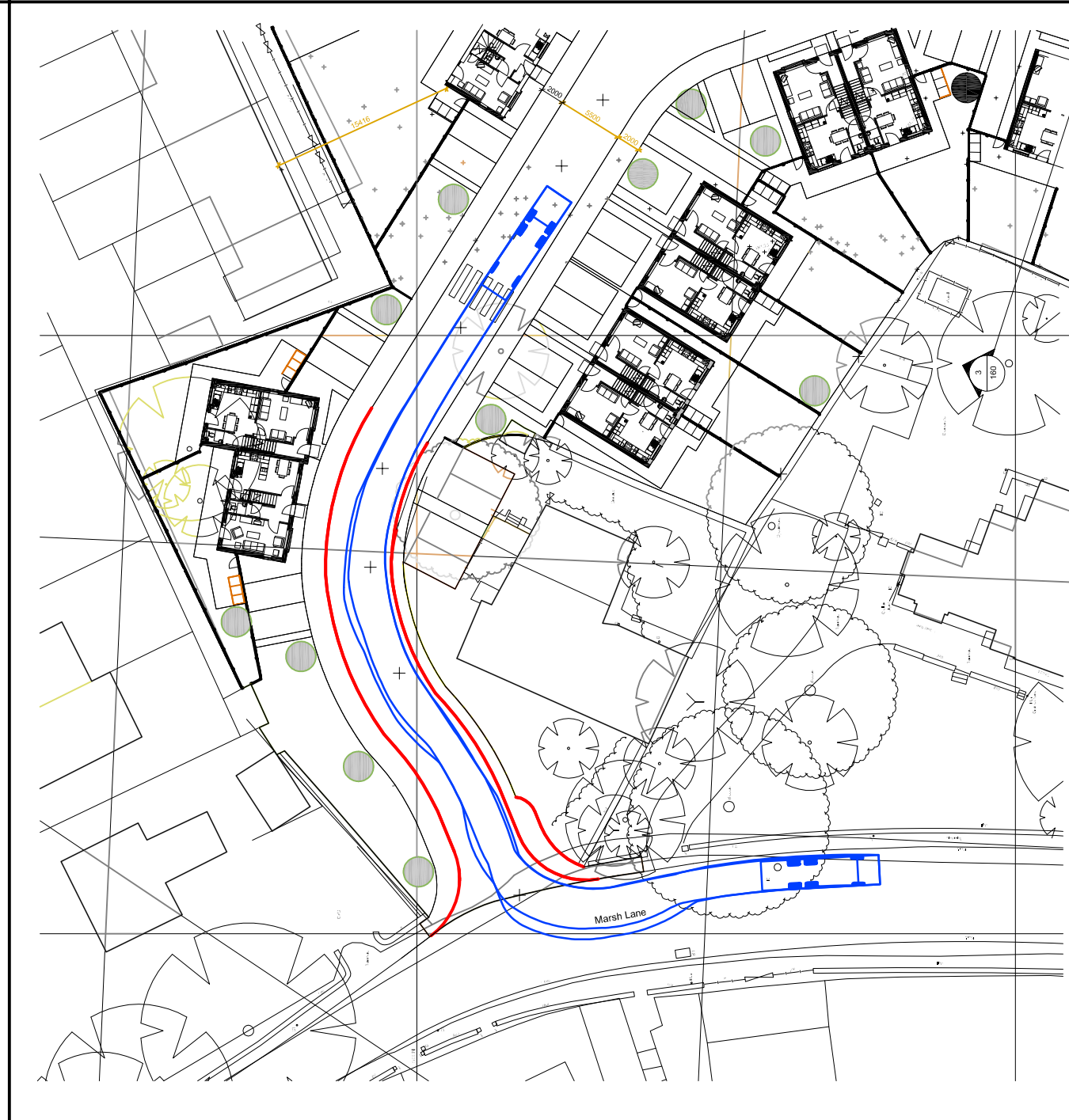
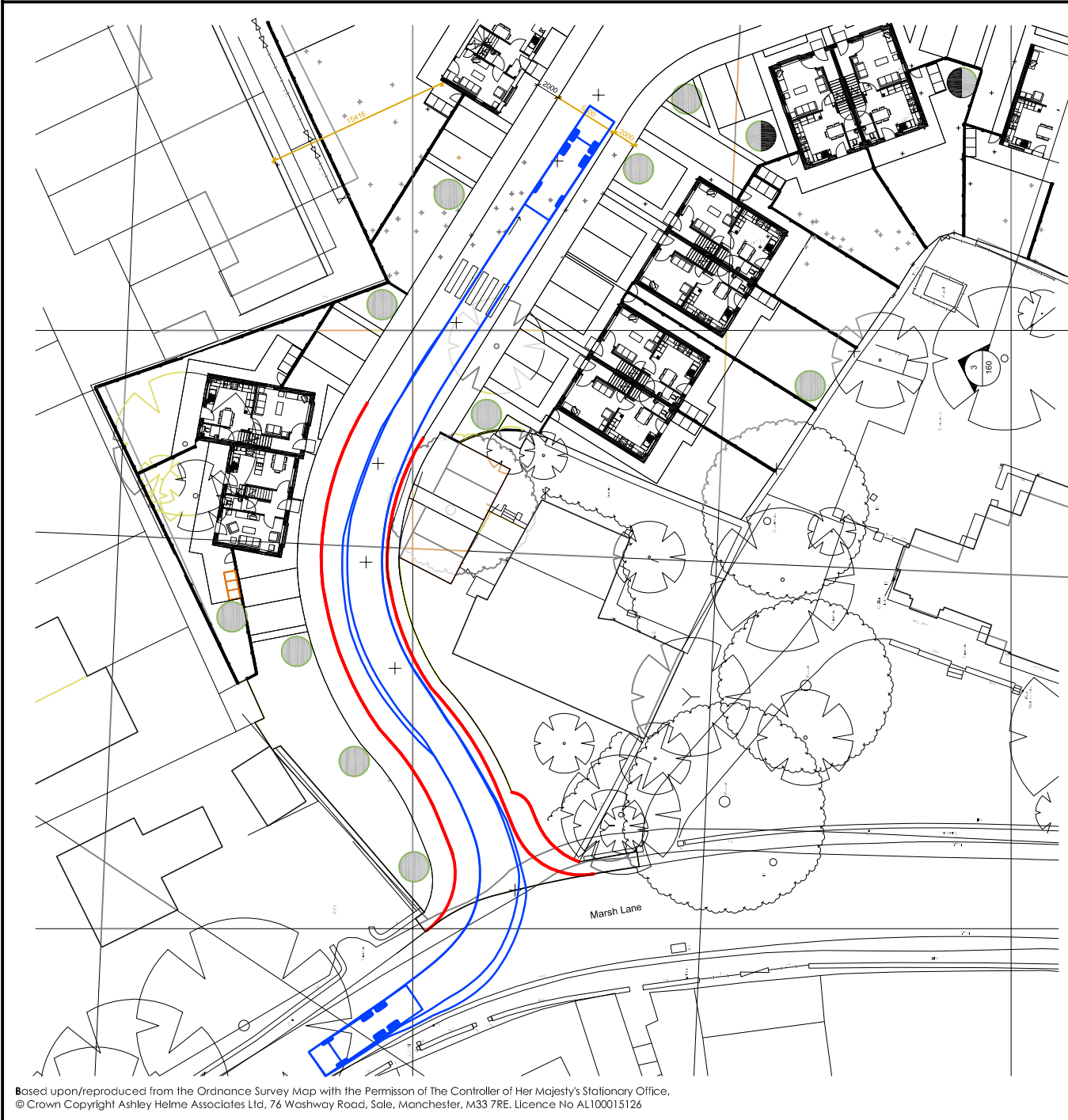

Large Refuse Vehicle (3 axle)

Overall Length	17.0m
Overall Body Height	3.0m
Min Body Ground Clearance	0.25m
Track Width	2.5m
Lock to Lock Time	10.0s
Turn to Turn Turning Radius	10.0m

Based upon/reproduced from the Ordnance Survey Map with the Permission of The Controller of Her Majesty's Stationary Office.
© Crown Copyright Ashley Helme Associates Ltd, 76 Washway Road, Sale, Manchester, M33 7RE. Licence No AL100015126

Project	MARSH LANE, NEW MILLS
Client	FORREST & GUINNESS PARTNERSHIP

Title	SWEPT PATH ANALYSIS: LARGE REFUSE VEHICLE
-------	---

 76 washway road, sale, manchester, m33 7re e: aha@ashleyhelme.co.uk t: 0161 972 0552 f: 0161 972 0553	Drig No	725/SP/02/A	Rev
	Date	NOVEMBER 2016	Scale 1:500@A2