

Refer to Structural Engineer's drawing  
16379/301 for permanent beam details  
and fixings

Allow for painting new boxings and  
adjacent walls and ceilings in colour  
to match existing. NBS M60/110

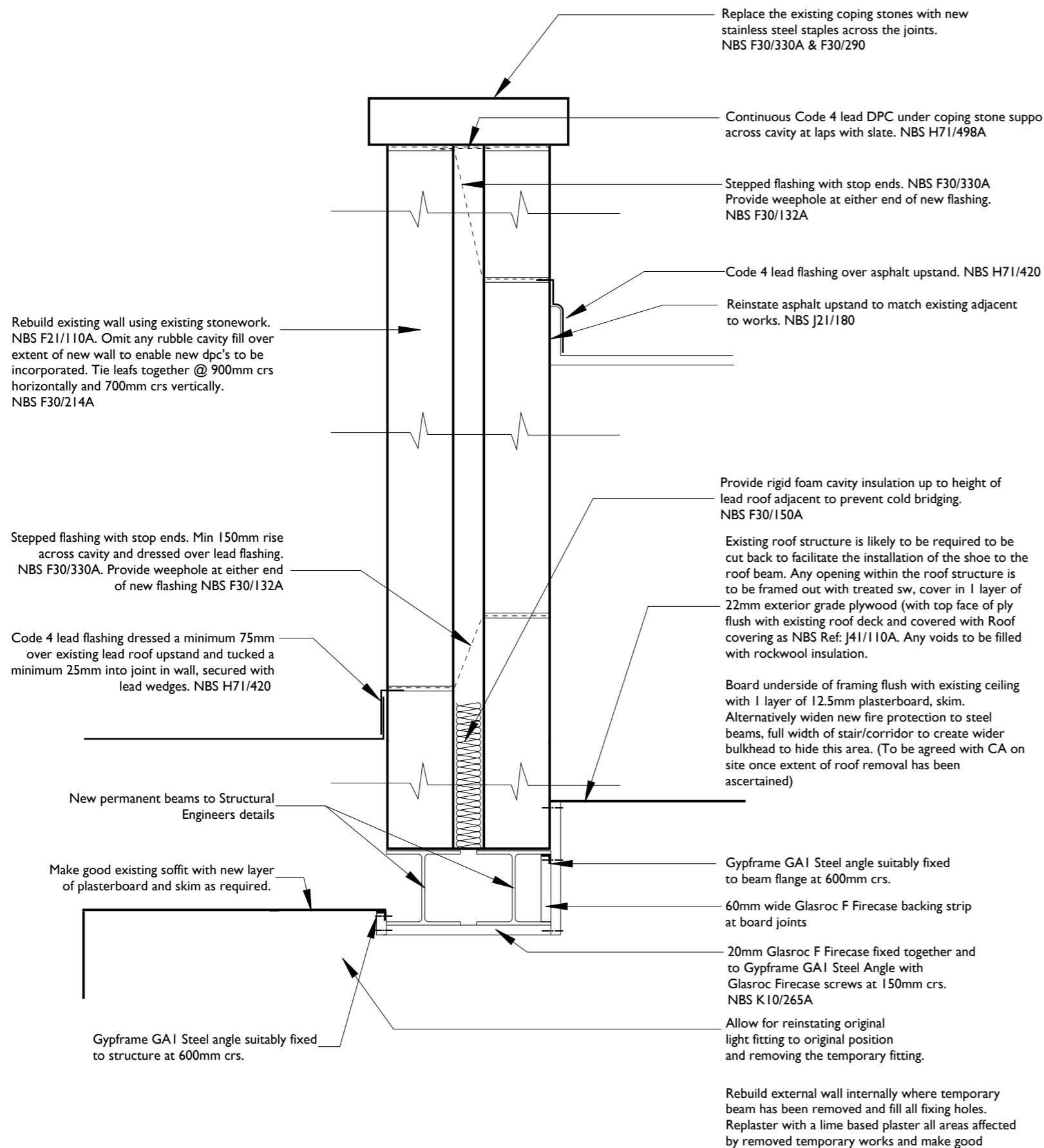

Section A-A

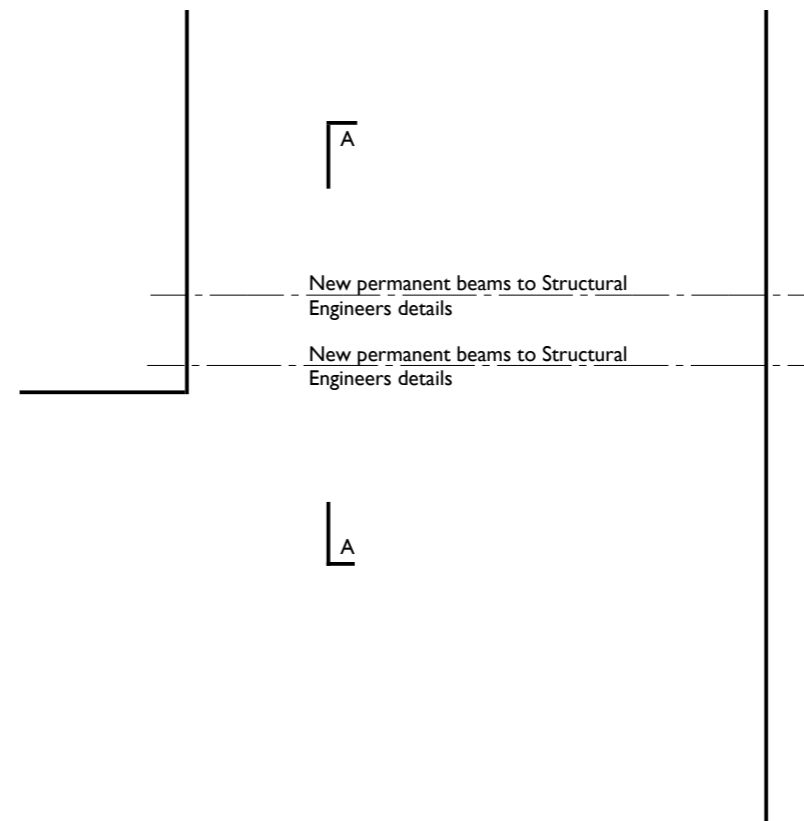

Plan 1:20

Revision	Description	Drawn	Checked	Date
B	Additional notes on roof structure added			12.01.17
A	Notes on decorations added			12.01.17

Current Status: **TENDER**



ARCHITECTS

T.A.D. Architects  
Smithy Wood House,  
Smithy Wood Crescent,  
Sheffield, S8 0NU

Tel: 0114 250 9600  
Fax: 0114 258 3681  
Email: enquiries@tadarchitects.co.uk  
www.tadarchitects.co.uk

Project:  
**Buxton Opera House  
Water Street, Buxton,  
Derbyshire SK17 6XN**

Drawing Title:  
**Fire Protection of Permanent Beams And  
Details Of Rebuilding Of Stone Wall Over**

DO NOT SCALE FROM DRAWING

Scale	Date	Drawn	Checked
1:20, 1:10 @ A3	20/12/16	PH	-

Drawing Number	Revision
<b>1635/A/(00)203</b>	<b>B</b>

CAD Reference:xxxxxGDS FILESxxxx xxx(0) © T.A.D. Architects