

**TREE SCHEDULE**

- T1: Betula Pendula 10-12cm Root-Balled
- T2: Prunus Amanogawa 8-10cm Root-Balled
- T3: Crataegus Monogyna Stricta 10-12cm Root-Balled
- T4: Sorbus Aria Lutescens 10-12cm Root-Balled
- T5: Crataegus Laevigata Paul's Scarlet 10-12cm Root-Balled
- T6: Acer Campestre Liena 12-14cm Root-Balled / Container Growth
- T7: Acer Platanoides 10-12cm Root-Balled
- T8: Carpinus Betulus 10-12cm Root-Balled
- T9: Prunus Avium 10-12cm Root-Balled

**LANDSCAPE FINISHES**

- drive: tarmac
- path: block paving
- patio: block paving
- lawn: grass for calcareous geology
- 1.8m fence: All treated timber, vertical posts with horizontal rails and vertical feather edged boards
- 1.1m fence: All treated timber, vertical posts with wire mesh fence
- garden fence: Concrete vertical posts with waney lap timber fence on 300mm concrete gravel board from house rear elevation first section 1800mm high and 1800mm long, second section 1500mm high and 3000mm long and, remaining section 1200mm high garden backs to be 1800mm high house sides to be 1800mm high

**SHRUB SCHEDULE**

- S1: Aucuba Japonica Variegata 30-40cm 3L pot 3/sqm
- S2: Buddleia Davidii Royal Red 60-80cm 2L pot 3/sqm
- S3: Euonymus Fortunei 'Emerald n' Gold' 20-25cm 2L pot 5/sqm
- S4: Lonicera Nitida 'Maygreen' 30-40cm 2L pot 3/sqm
- S5: Prunus Laurocerasus 'Rotundifolia' 40-50cm 2L pot 3/sqm
- S6: Dogwood, Hazel, Holly mix
  - 30% cornus sanguinea (dogwood) 45-60cm BR 3/sqm
  - 30% corylus avellana (hazel) 45-60cm BR 3/sqm
  - 40% ilex aquifolium (holly) 30-45cm 2L 3/sqm
- S7: Prunus Spinosa 40-50cm 2L pot 3/sqm
- S8: Rhamnus Frangula 40-50cm 2L pot 3/sqm
- S9: Lonicera Periclymenum 40-50cm 2L pot 3/sqm
- S10: Symphoricarpos 40-50cm 2L pot 3/sqm

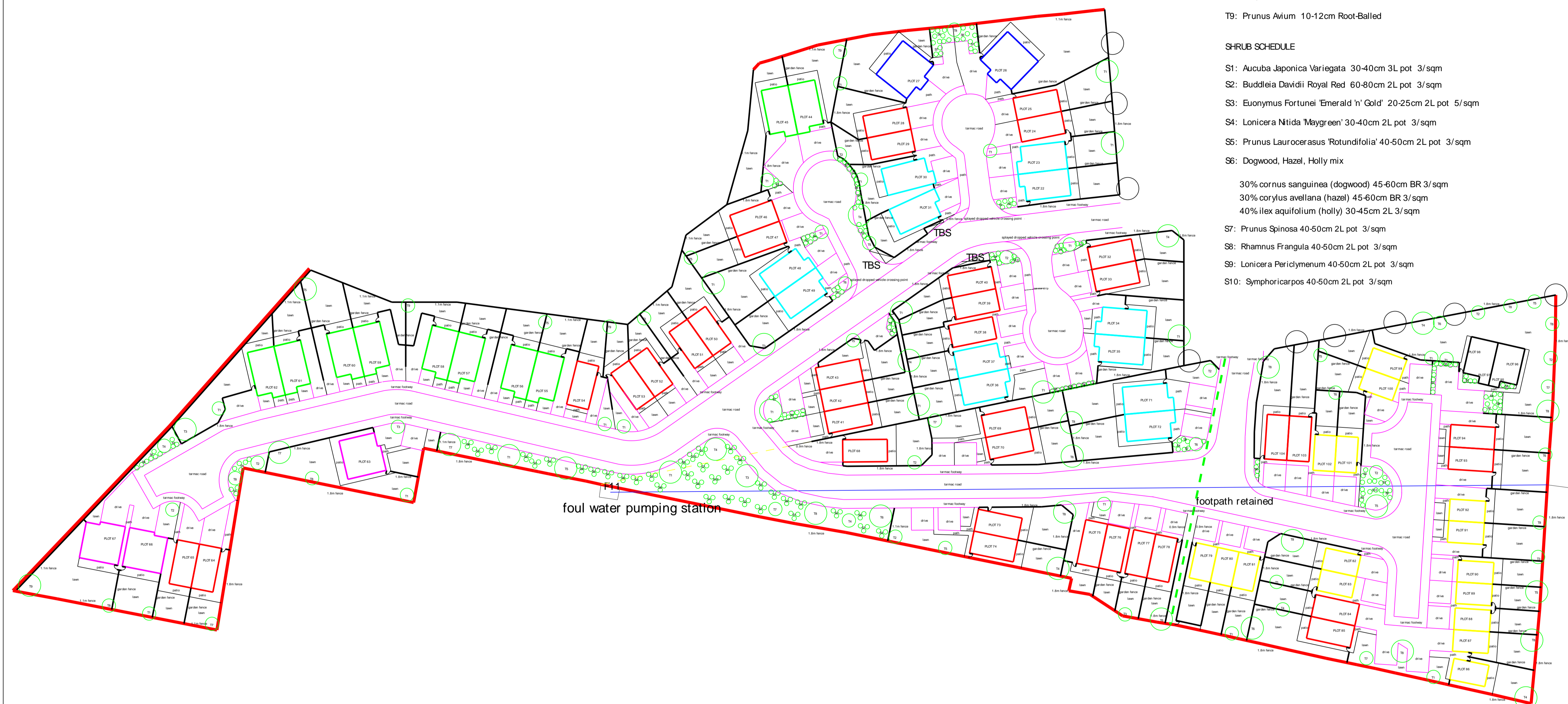
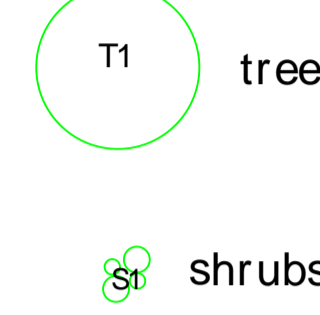

Revision A Date 30-08-16 Additional shrub mix and fencing spec

**LEE ARCHITECTS LTD**  
 Leepark House  
 449 Chester Road  
 Manchester M16 9HA  
 T 0161 873 7788  
 M 07710 539748  
 E info@leearchitects.co.uk  
 copyright reserved

**CLIENT**  
 HOPWOOD HOMES LTD

**PROJECT**  
 Land to rear of Hallsteads  
 Hallsteads (A6)  
 Dove Holes  
 Buxton SK17

**DRAWING**  
 Landscaping Plan  
 Phase 2

**DRAWING NUMBER**  
 L558 / 54RevA

**DATE** 18-08-16 **SCALE** 1:500 @A1

