

Notes :

1. This drawing is to be read in conjunction with all relevant Architects, Engineer's and specialists' drawings and specifications.
2. Do not scale from this drawing in either paper or digital form. Use written dimensions only. To check that this drawing has been printed to the intended scale this bar should be 50mm long @ A1 or 25mm long @ A3.
3. Health & Safety :
All specific drawing notes are to be read in conjunction with the project "Information Pack" and "Site Rules".
4. All new steelwork had dipped galvanised and painted in accordance with the specification.
5. * - To be confirmed following inspection of position of existing rafter cut.
6. All sizes, dimensions and details on this drawing are the assumed likely repair details, they may need to be changed following full opening up works. Do not order materials until full opening up has been done and inspected, and any alterations instructed. Allow for sufficient time in the contract for the inspection and preparation of any revised details.
7. Existing column heads to be tied to scaffolding prior to removal of existing structure.
8. Existing column heads to be fitted back to remove all corrosion product. Column tops to be inspected and wall thicknesses measured with ultrasonics.

TENDER ISSUE
NOT FOR CONSTRUCTION

| | | | |
|-----|----------|-----------|--|
| | | | |
| 3 | 16.8.16 | NW | SW |
| 2 | 16.8.16 | NW | SW |
| 1 | 11.12.16 | NW | SW |
| Ver | Date | Drawn | Eng |
| | | Amendment | |
| | | | Position of ventilation holes revised. |
| | | | Flange plates revised |
| | | | Issued for Tender |
| | | | Issued for Information |

THE OCTAGON
PAVILION GARDENS

RING BEAM REPAIR
DETAILS
SHEET 4

Status
FOR INFORMATION
NOT FOR CONSTRUCTION

| | | | |
|------------|----------------|-----|----|
| Drawn | NW | Eng | SW |
| Scales | As noted at A1 | | |
| Drawing No | | Ver | |
| 23765/23 | | 3 | |

PRICE&MYERS

Consulting Engineers
1 Kayes Walk, Nottingham NG1 1PY
Tel: 0115 950 7977 Fax: 0115 950 0302
E-mail: notes@pricemyers.com www.pricemyers.com

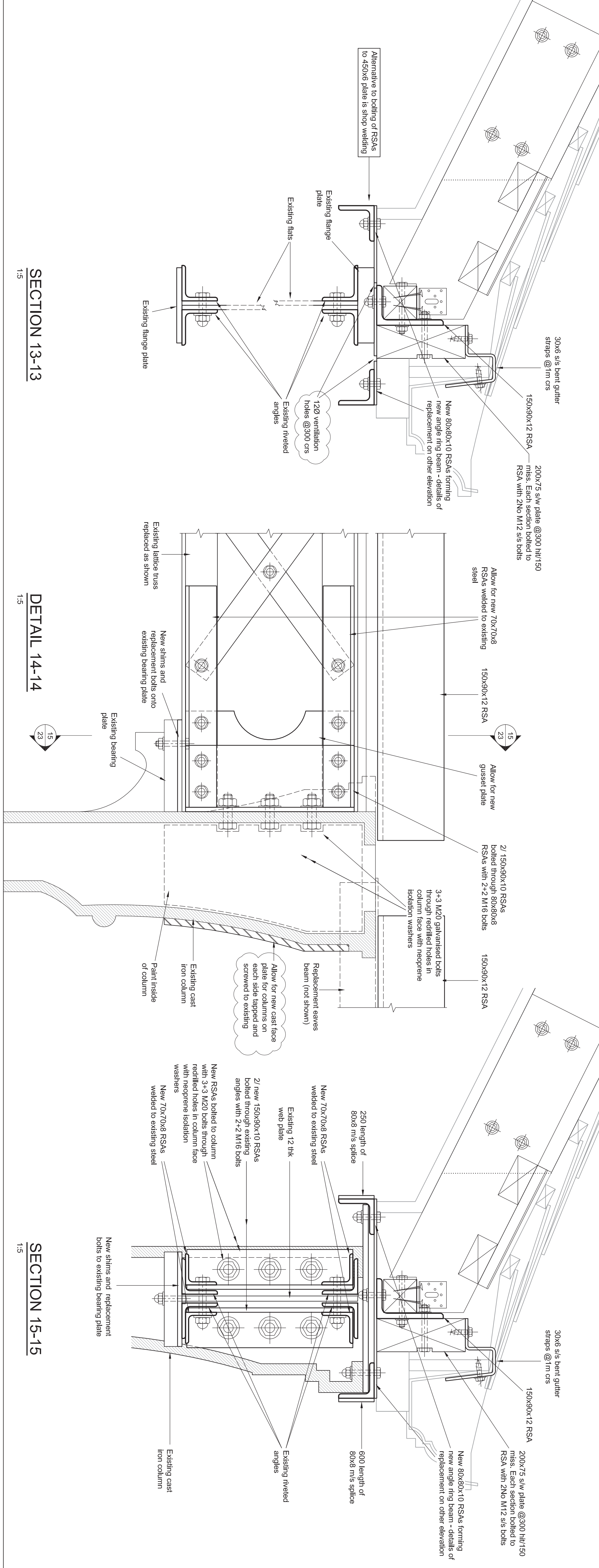
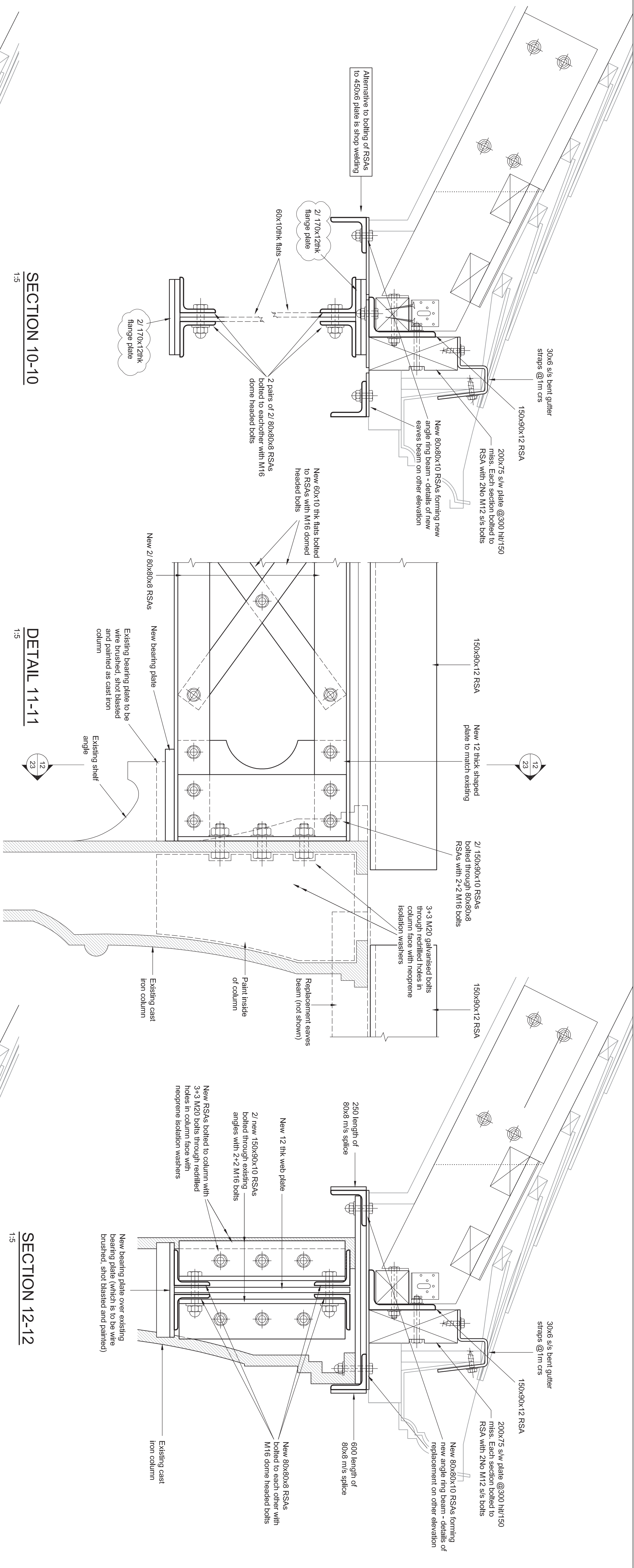

SECTION 13-13

1:5

DETAIL 14-14

1:5

SECTION 10-10

1:5

DETAIL 11-11

1:5

SECTION 12-12

1:5

SECTION 15-15

1:5