

PROPOSED FOUNDATION PLAN 1:50

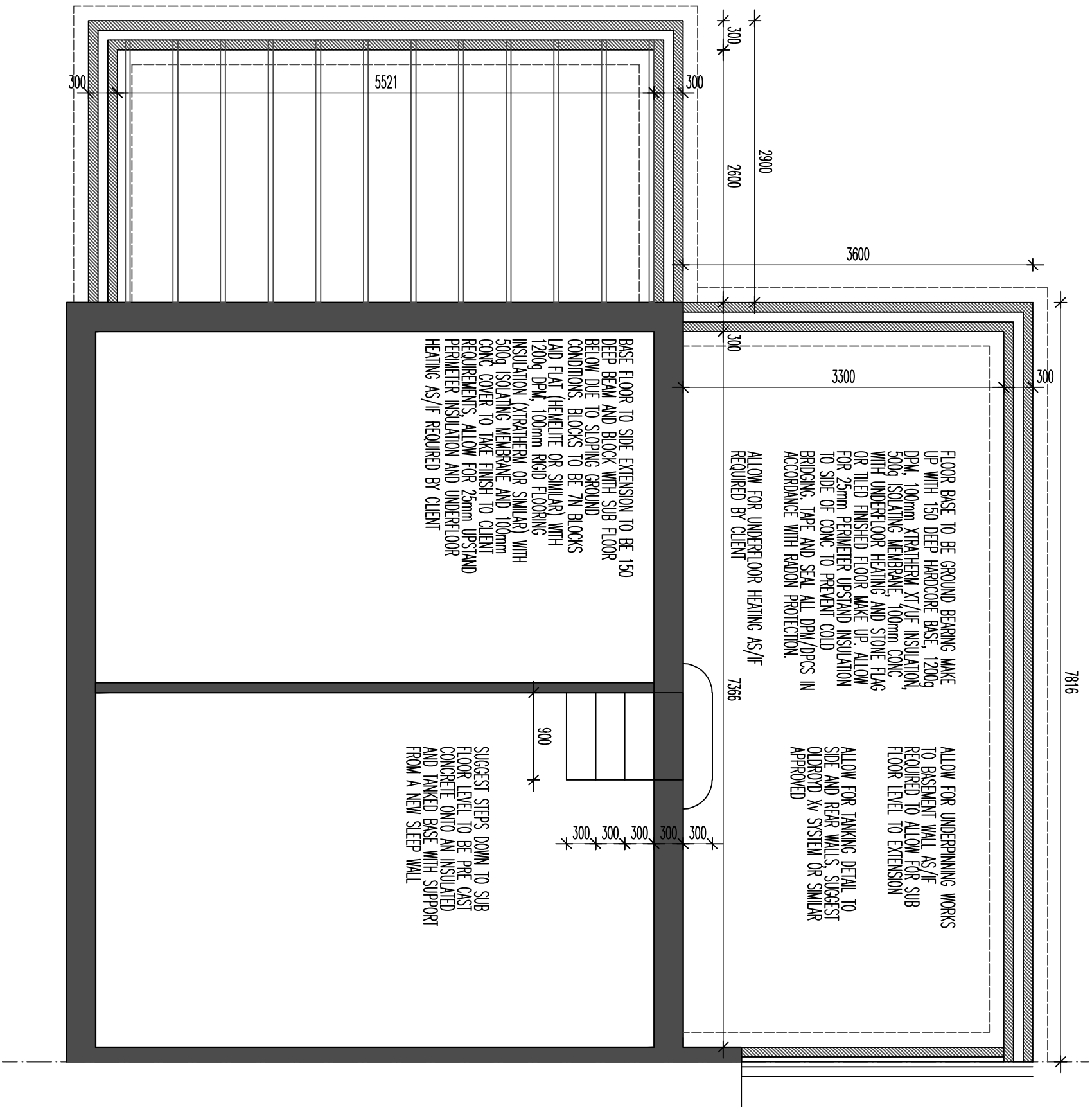

THE PURPOSE OF THE APPLICATION IS TO PROVIDE A CONTINUOUS REAR EXTENSION ACROSS 54 AND 52 CORBAR ROAD (STEPPED DOWN INTO THE GARDEN LEVEL) AND A TWO STOREY SIDE EXTENSION TO NUMBER 54 TO PROVIDE THE REQUIRED EXTRA LIVING SPACE FOR THE NEW OWNERS.

THESE TWO SEMI DETACHED PROPERTIES WERE BUILT IN THE LATE 50'S AND DO NOT PARTICULARLY RELATE TO THE STRONG STONE BUILT CHARACTER THAT IS OFTEN FOUND ON THIS ROAD BEING DASHED RENDERED IN ELEVATION WITH TILED ROOF COVERINGS. THE DWELLINGS DO HOWEVER SIT IN VERY GOOD SIZED PLOTS THAT SLOPE CONSIDERABLY AWAY TO THE REAR WITH SUFFICIENT ROOM FOR EXPANSION TO THE SIDE OF THE PLOTS. THE DISTANCE TO SURROUNDING DWELLINGS AND THE LARGE GARDENS TO THE REAR ALSO MEANS THAT OVERLOOKING ISSUES ARE NOT RELEVANT. WHILST ELEVATED POSITION OF THE DWELLING MEANS THE MAN HOUSE AND THE REAR EXTENSION AFFORD IMPRESSIVE VIEWS OVER THE TOWN.

THE SIDE EXTENSION IS TO BE TWO STOREY WITH A SLIGHTLY STEPPED BACK ELEVATION FROM THE FRONT UP TO A ROOF PITCH TO FOLLOW THE LINE OF THE MAIN BUILDING WITH A SLIGHTLY STEPPED ROOF LINE. THE SIDE EXTENSION IS TO BE BUILT UP OFF STRIP FOOTINGS WITH A 150 DEEP BEAM AND BLOCK SUSPENDED FLOOR TO TAKE INTO ACCOUNT THE DROPPED GROUND LEVELS WHILST THE FLOOR TO THE REAR EXTENSION IS HOPEFULLY TO BE A GROUND BEARING SLAB. IN BOTH CASES, 1200q DPM WILL BE IN PLACE WITH 100mm XTHATHEN XT/UF INSULATION, 500q ISOLATING MEMBRANE AND 100mm CONC COVER TO TAKE FINISH TO CLIENT REQUIREMENTS. 25mm PERIMETER INSULATION TO PREVENT COLD BRIDGE AND UNDERFLOOR HEATING TO BE ALLOWED FOR IN THE MAKE-UP AS/IF REQUIRED.

EXTERNAL WALLS ARE TO BE 300mm O/A WITH 100mm 7N BLOCK CAVITY BLOCK WITH 60mm XTRATHERM INSULATION TO THE CAVITY OR SIMILAR APPROVED. SEE MAIN SPEC FOR WALL TIE INFO ETC. WALLS BUILT UP TO WALLPLATE HEIGHT TO MATCH EXISTING.

FIRST FLOOR CONSTRUCTION IS TO BE POSITIONED TO LINE THROUGH WITH THE EXISTING WITH 200x65 C16 JOISTS AT 450c/c's ON HANGERS WITH MID SPAN NOGGINs. JOISTS TO BE INSULATED WITH 100mm ISOVER, UNDERBRAIN WITH 15 PBD AND SKIM AND FINISHED TO FLOOR WITH 22mm I&G CHIPBOARD.

ROOF TO THE SIDE EXTENSION IS TO BE 150-56 C24 GRADE RATHERS AT 450cits WITH MID SPAN PURLIN SUPPORT WHILST THE REAR EXTENSION IS TO BE 175-75 C24 GRADE AT 450cits. THE MAIN ROOF IS TO HAVE 350 ROCKWOOL WHILST THE REAR IS TO BE 2 LAYERS OF 50mm SUPERROLL ABOVE AND BELOW RATER LINE. BOTH ROOF FINISHES ARE TO BE TILES TO MATCH WITH TYVEK BREATHABLE MEMBRANES WITH AN ONDULITE SYSTEM TO THE REAR DUE TO THE LOW PITCH.

ALL NEW MAIN WINDOWS ARE TO BE WHITE UPVC WITH U VALUE OF 1.2 W/M²K WHILST THE REAR BI-FOLD IS TO BE HIGH PERFORMANCE ALUMINIUM DOUBLE OR TRIPLE GLAZED UNIT IN WHITE.

1:50	CHECKED:
DATE: MAR'16	DRAWN:

DWG: PROPOSED
54 CORBAR ROAD
BUXTON

REVISIONS:

THIS DRAWING AND THE BUILDING WORKS DEPICTED ARE THE COPYRIGHT OF AJS ARCHITECTURE
AND MAY NOT BE REPRODUCED OR AMENDED EXCEPT BY WRITTEN PERMISSION. NO LIABILITY WILL BE ACCEPTED
FOR AMENDMENTS MADE BY OTHER PERSONS. - DO NOT SCALE OFF DRAWING. CONFIRM ALL DIMS ON SITE



h: 01298 26062
m: 07794 400237

**32 carr road
buxton
derbyshire
sk17 6w1**

PROPOSED 03

54 CORBAR ROAD