

KERB DETAIL AT VEHICULAR DROP CROSSING

1:10 @ A1
1:20 @ A3

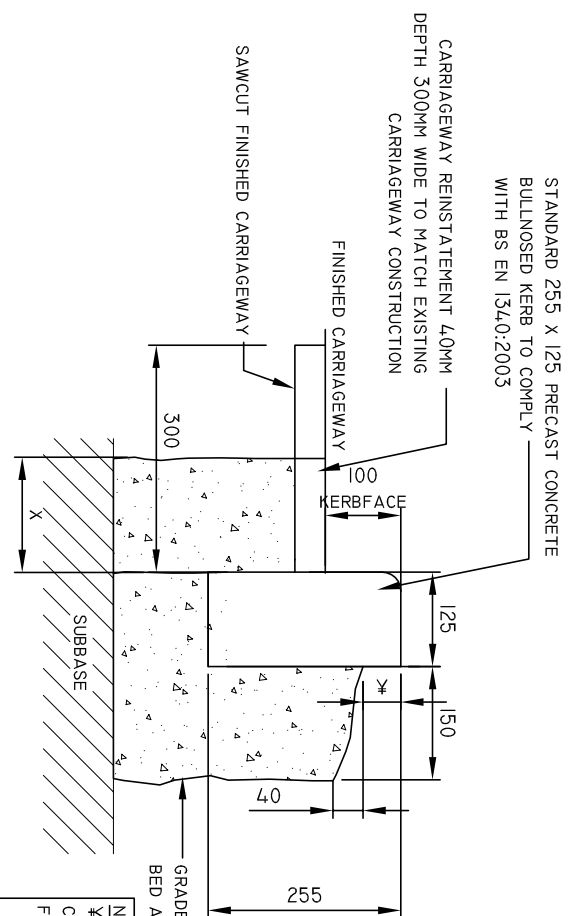

TYPICAL KERB DETAIL K2
(NEW CARRIAGEWAY CONSTRUCTION, EXISTING CARRIAGEWAY ON EXISTING & WIDENED ALIGNMENT)

1:10 @ A1
1:20 @ A3

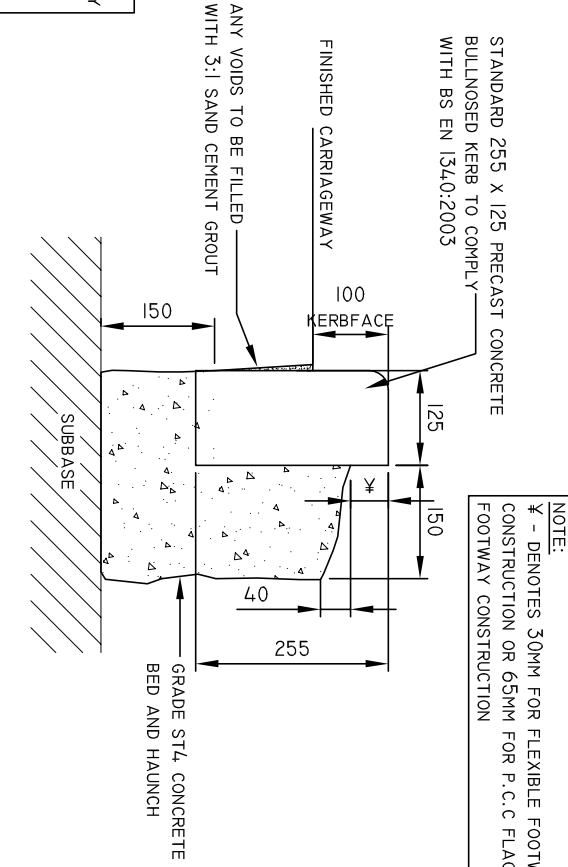

TYPICAL KERB DETAIL K1
(NEW CARRIAGEWAY CONSTRUCTION, EXISTING CARRIAGEWAY ON EXISTING ALIGNMENT)

1:10 @ A1
1:20 @ A3

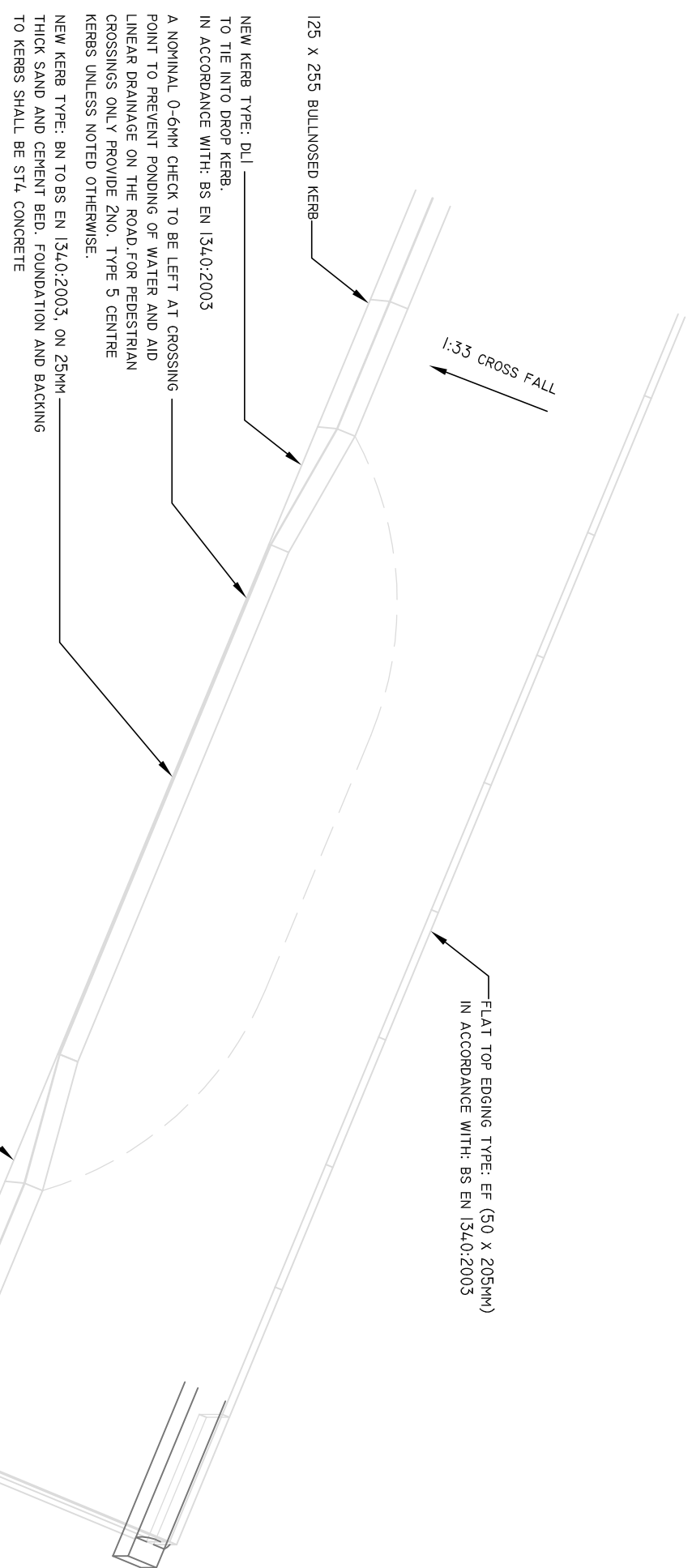

ISOMETRIC VIEW OF DROPPED KERB CROSSING POINT

1:20 @ A1
1:40 @ A3

EDGING KERB 'EX' DETAIL
1:10 @ A1
1:20 @ A3

MATERIALS SPECIFICATIONS FOR CARRIAGEWAY (DRIVEWAY FROM RUMBLE STRIP)

- SURFACE COURSE : 30mm CLOSE GRADED MACADAM (100MM AGGREGATE) (MCHW CLAUSE 912)
- BINDER COURSE : 60mm DENSE BITUMEN MACADAM (MCHW CLAUSE 906)
- BASE COURSE : 80mm DENSE MACADAM BASE (MCHW CLAUSE 903)
- SUB BASE : 150mm TYPE 1 GRANULAR FILL (LIMESTONE OR APPROVED RECYCLED)

FOR ROAD GULLEY DETAIL, REFER TO DRAWING J4032 EX02

ALL WORKS TO ADOPTED HIGHWAY/FOOTPATH TO BE IN ACCORDANCE WITH DERBYSHIRE COUNTY COUNCIL'S STANDARD DETAILS, AND AS AGREED WITH DERBYSHIRE COUNTY COUNCIL'S APPOINTED REPRESENTATIVE

FOR NOTES ON KERBING AND EDGING, PUBLIC OR PRIVATE UTILITY NOTES AND FURTHER NOTES, SEE DRAWING J3432 HN01

CAPPING LAYER : THICKNESS TO BE CONFIRMED FOLLOWING CBR TEST OF SUB GRADE. ALLOW FOR 225mm AT TENDER STAGE, 6f/2 OR 6f/5 - MATERIAL TO BE APPROVED

MATERIALS SPECIFICATIONS FOR CARRIAGEWAY (DALE ROAD)

- SURFACE COURSE : 45mm ROLLED ASPHALT SURFACE COURSE (HRA 35) 1/4 SURF 4/0 6/0 TO BS EN 13105-4, (MCHW CLAUSE 910)
- BINDER COURSE : 60mm DENSE BITUMEN MACADAM (MCHW CLAUSE 906)
- BASE COURSE : 60mm DENSE MACADAM BASE (MCHW CLAUSE 903)
- SUB BASE : 150mm TYPE 1 GRANULAR FILL (LIMESTONE OR APPROVED RECYCLED)

CAPPING LAYER : THICKNESS TO BE CONFIRMED FOLLOWING CBR TEST OF SUB GRADE. ALLOW FOR 225mm AT TENDER STAGE, 6f/2 OR 6f/5 - MATERIAL TO BE APPROVED

NOTES ON CARRIAGEWAY MARKINGS:

- CARRIAGEWAY MARKINGS SHALL CONSIST OF CONTINUOUS OR INTERMITTENT LINES, LETTERS, FIGURES, ARROWS OR SYMBOLS CONFORMING WITH THE REQUIREMENTS OF THE TRAFFIC SIGNS REGULATIONS AND GENERAL DIRECTIONS 2002 AND AMENDMENTS THEREOF.
- ALL ROAD MARKINGS SHALL BE LAID IN ACCORDANCE WITH DOT SPEC. CLAUSE 1212.8
- ALL HOT THERMOPLASTIC MATERIALS TO COMPLY WITH BS EN 1871 & BS EN 1426
- ALL WHITE MARKINGS SHALL BE REFLECTORISED WITH GLASS BEADS INCORPORATED INTO THE ROAD MARKING MIXTURE AND TO THE WEI SURFACE OF MARKING.
- THE ROAD MARKING CONTRACTOR SHALL BE CERTIFIED TO BS ISO 9000 "QUALITY FOR ASSURANCE" FOR THE APPLICATION OF MATERIALS.

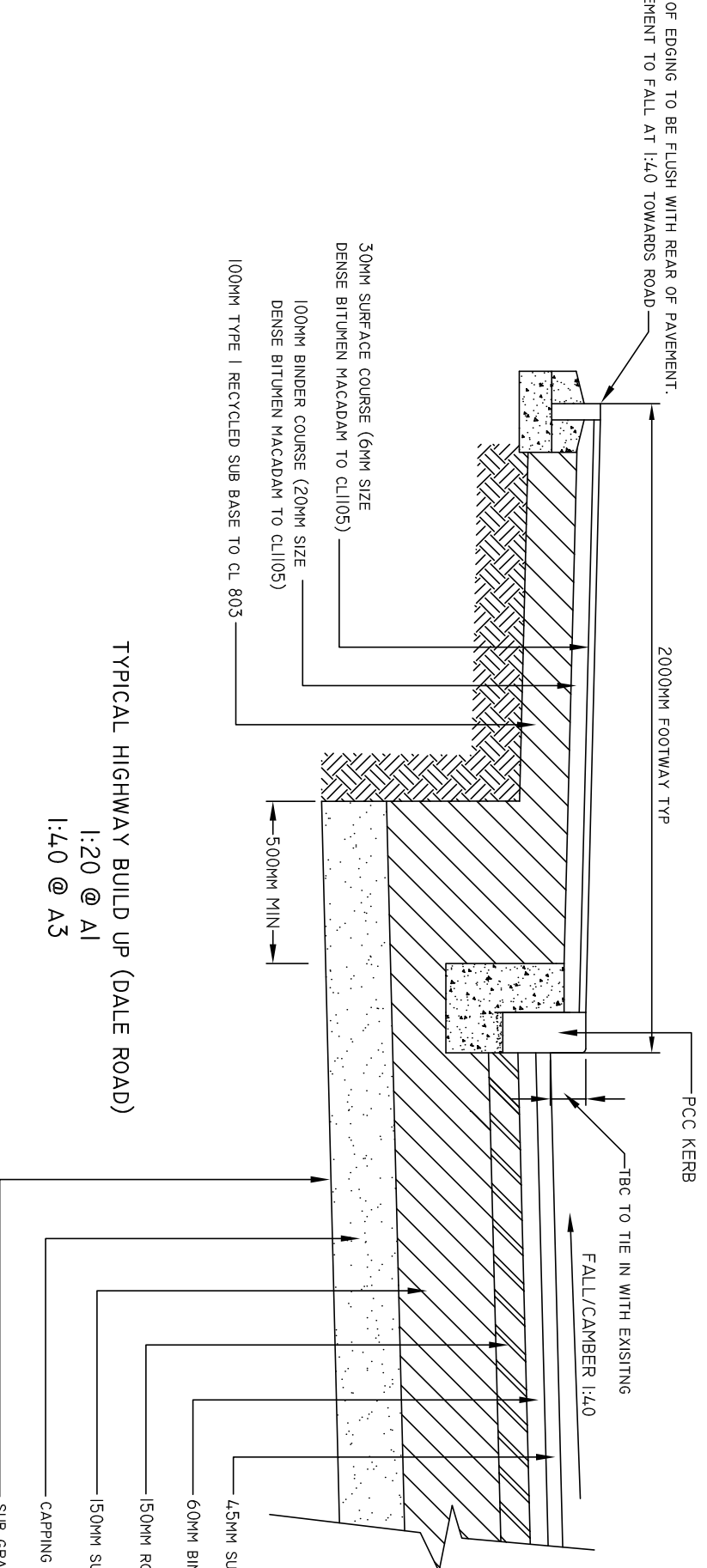

TYPICAL HIGHWAY BUILD UP (DALE ROAD)
1:20 @ A1
1:40 @ A3

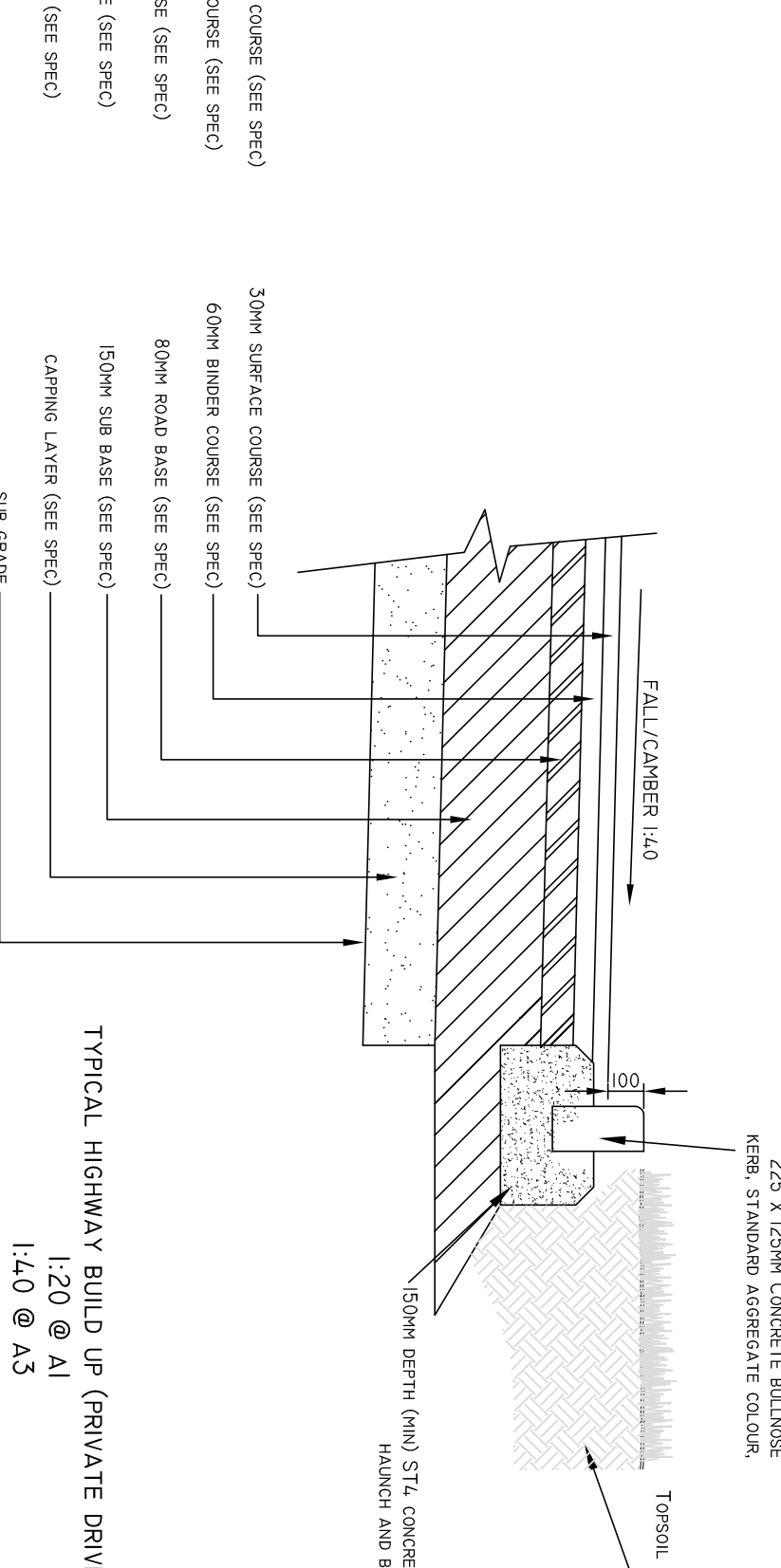

TYPICAL HIGHWAY BUILD UP (PRIVATE DRIVE)
1:20 @ A1
1:40 @ A3

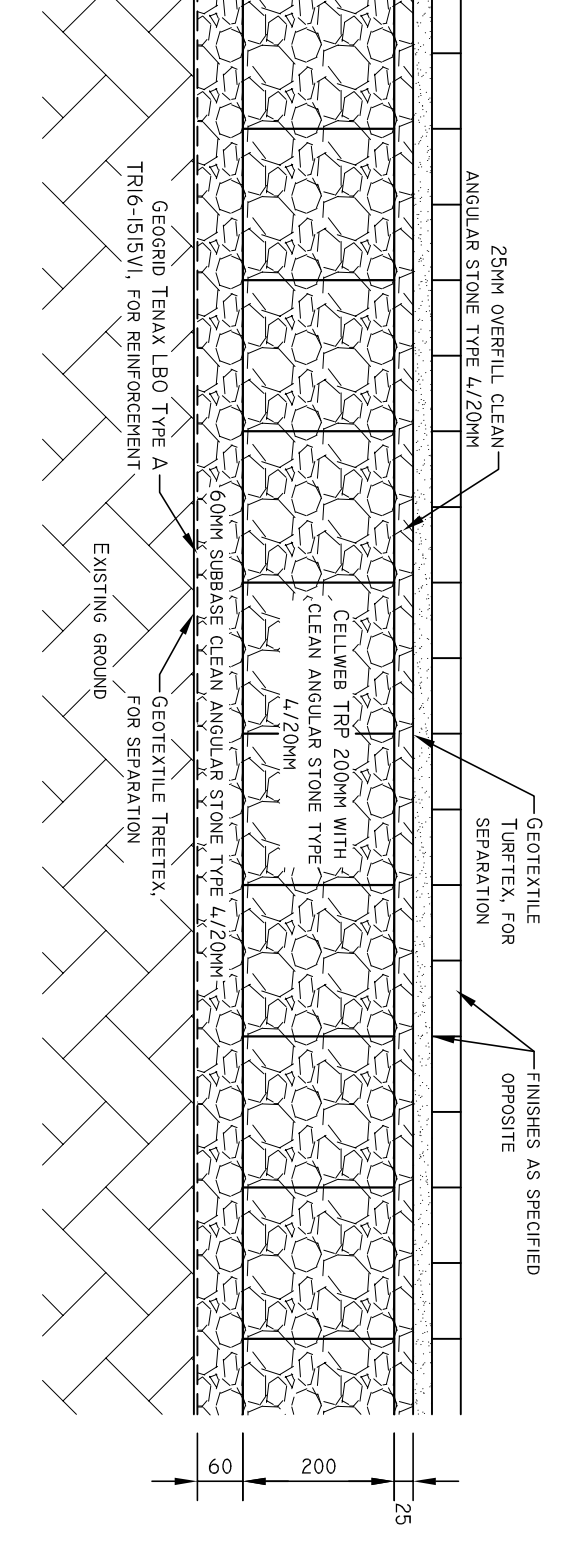

TREE ROOT PROTECTION DETAIL
1:10 @ A1
1:20 @ A3

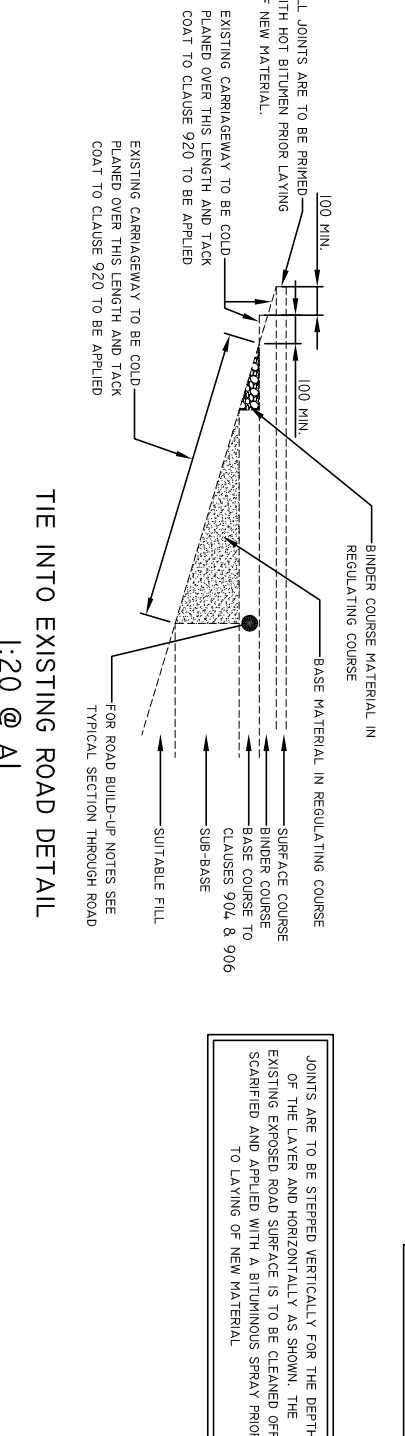

TIE INTO EXISTING ROAD DETAIL
1:20 @ A1
1:40 @ A3

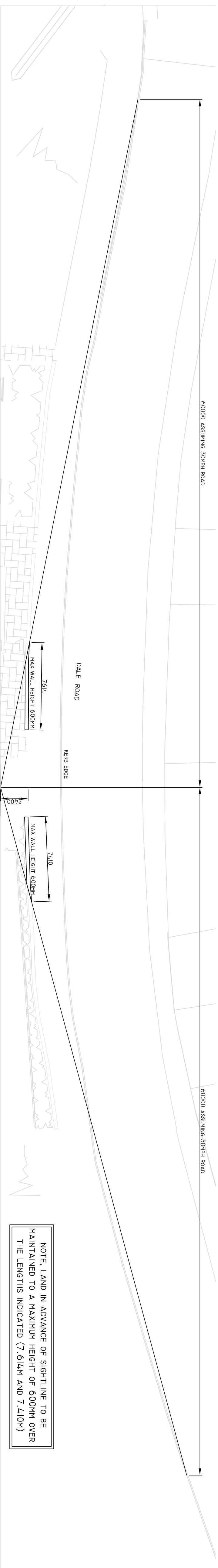

NOTE. LAND IN ADVANCE OF SIGHTLINE TO BE MAINTAINED TO A MAXIMUM HEIGHT OF 600mm OVER THE LENGTHS INDICATED (7.614m AND 7.410m)

NOTES:

- THIS DRAWING IS COPYRIGHT AND THE PROPERTY OF BELL MUNRO CONSULTING LTD. THE DRAWING MUST NOT BE REPRODUCED IN PART OR IN WHOLE WITHOUT PRIOR WRITTEN AUTHORITY.
- THIS DRAWING MUST NOT BE SCALED BY EITHER CONTRACTORS OR OTHER CONSULTANTS ANY DIMENSIONAL OR SETTING - OUT DISCREPANCIES ARE TO BE REPORTED TO BELL MUNRO CONSULTING PRIOR TO CONSTRUCTION / FABRICATION COMMENCING.
- THIS DRAWING MUST BE READ IN CONJUNCTION WITH THE RELEVANT BNC SPECIFICATIONS TOGETHER WITH THE APPROPRIATE ARCHITECTS AND SERVICES CONSULTANTS DRAWINGS AND SPECIFICATIONS.
- ALL PRECAST CONCRETE KERBS AND GUARDRAILS SHALL BE TO DOT SPEC. CLAUSE 1101 & BS7263, IN PRESSED CONCRETE WITH HARDBONE AGGREGATE.
- TYPE A DROPPED KERBS ON RADIUS OF LESS THAN 12000 SHALL BE 125 X 150 BULBROSE OF THE APPROPRIATE RADIUS LAD TO 25 OR 6 FACE, AND TRANSITIONS 125 X 225 X 12.5 DEC PLAY OF THE APPROPRIATE RADIUS CUT TO FIT. TRANSITION KERBS TO BE PROVIDED EITHER SIDE OF DROPPED KERBS.
- MINIMUM LENGTH OF KERB TO BE 4.50mm
- HANDLING AND LAYING OF KERBS AND CHANNELS - THE CONTRACTOR SHALL AVOID THE MANUAL HANDLING OF PRECAST CONCRETE KERBS AND CHANNELS BY USING PURPOSE-SHADE MECHANICAL LIFTING EQUIPMENT FOR THEIR HANDLING, LIFTING AND LAYING
- ALL TRAFFIC SIGNS TO COMPLY WITH BS8173 AND TO BE IN ACCORDANCE WITH TRAFFIC SIGNS REGULATIONS AND GENERAL DIRECTIONS 1994.
- ALL CARRIAGEWAY MARKINGS SHALL CONFORM TO THE REQUIREMENTS OF TRAFFIC SIGNS REGULATIONS AND GENERAL DIRECTIONS 1994.