

**Notes**  
Do not scale from this drawing all dimensions to be checked on site and architect notified of any discrepancies  
copyright reserved.  
  
Curious Architecture owns the copyright of this drawing, which must not be reproduced in whole or part without the written permission of Curious Architecture.

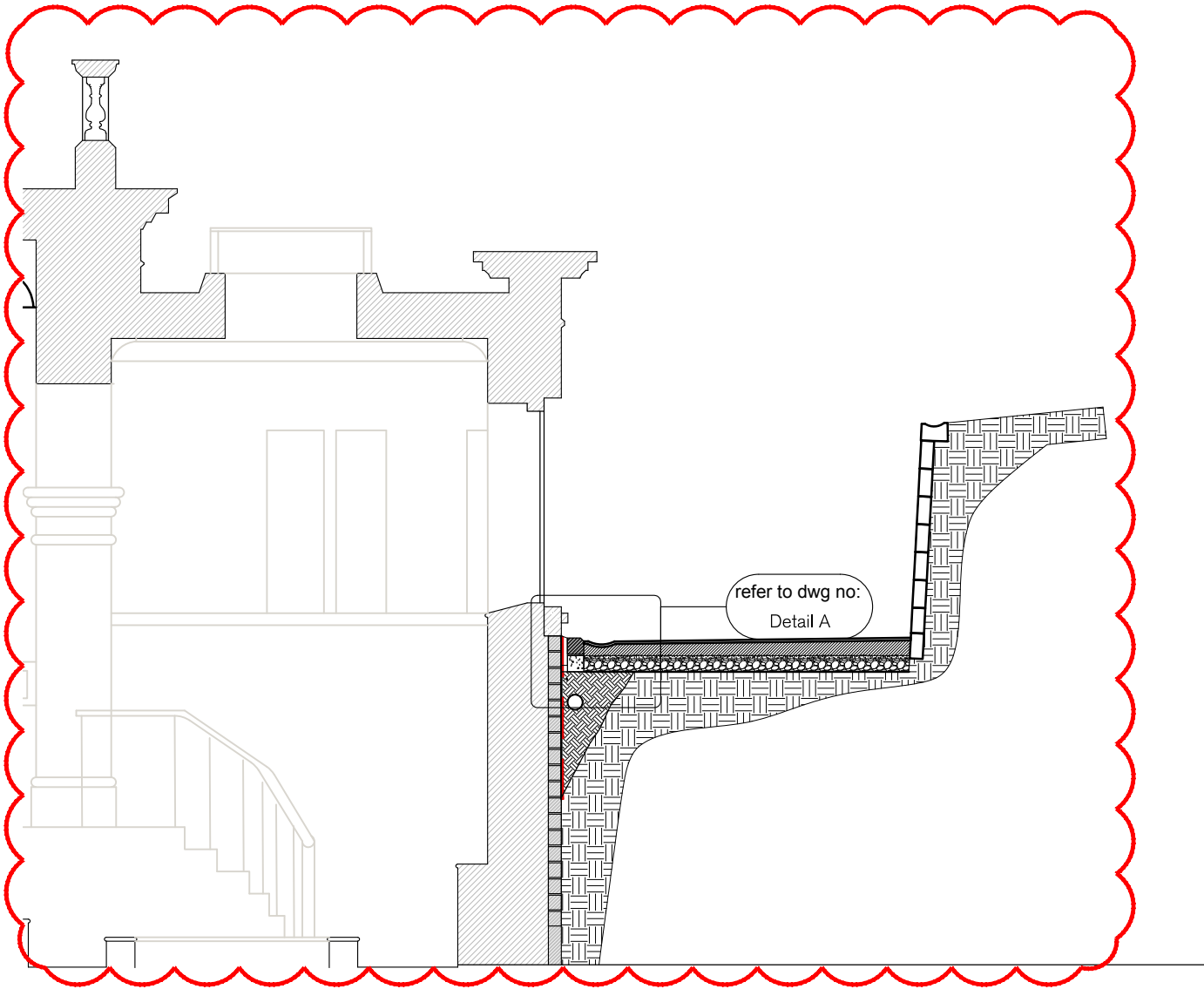

Section thro Rear Drainage Path

Scale 1:50

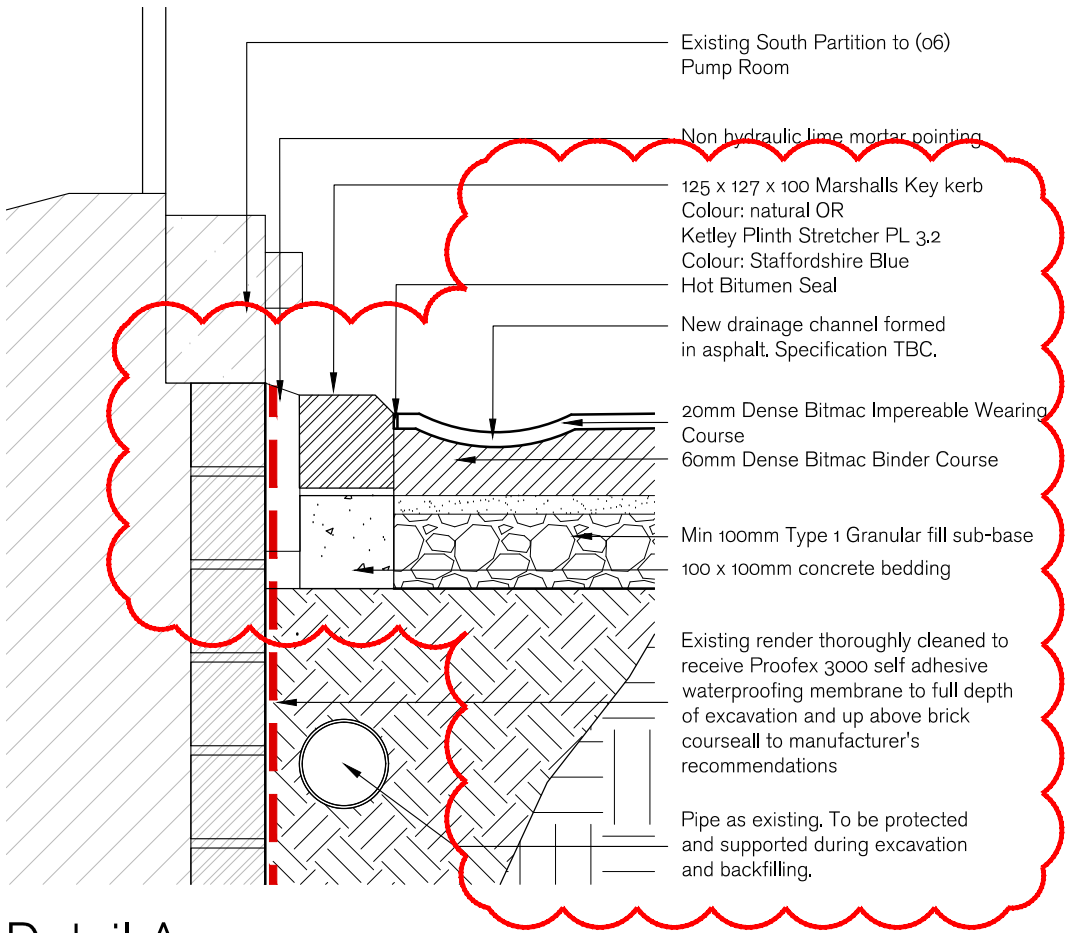

Detail A

Scale 1:10

B	22/12/15	Drainage path revised. Channel formed in asphalt. Half battered straight kerb omitted and replaced with either Marshalls Key kerb colour: natural OR Ketley Brick Staffordshire Blue Issued for construction	IGC	JW		
A	18/11/15			pd	JW	
rev:	date:	description:	dm:	chk:	apd:	
PURPOSE			FOR COMMENT			

**Curious**  
it all begins with the idea

client: BUXTON CRESCENT HOTEL AND THERMAL SPA COMPANY LTD

project: HOTEL AND SPA DEVELOPMENT  
THE CRESCENT  
BUXTON

title: (06) PUMP ROOM  
Section through rear drainage path  
As Proposed

scale:	date:	drawing stage:
As Shown	22/12/2015	
drawn:	checked:	approved:
JF		

project no:	drawing no:	rev:
20046	(06)AL(2)104	B

**Curious**  
Architecture & Interior Design  
64 Waterloo Street Glasgow G2 7DA  
0141 582 1582  
www.thinkcurious.com