

**PROPOSED CONSTRUCTION OF A 'WHEELED BIN'  
STORE AND CANOPY ON THE EAST SIDE ELEVATION OF  
THE BLOCK OF APARTMENTS AT HARDWICK GARDENS,  
HARDWICK MOUNT, BUXTON, DERBYSHIRE. SK17 6PL.**

HPK/2015/0558

**SHEET 1A.**

**SCALE 1: 50. OCTOBER 2015.**

15 OCT 2015

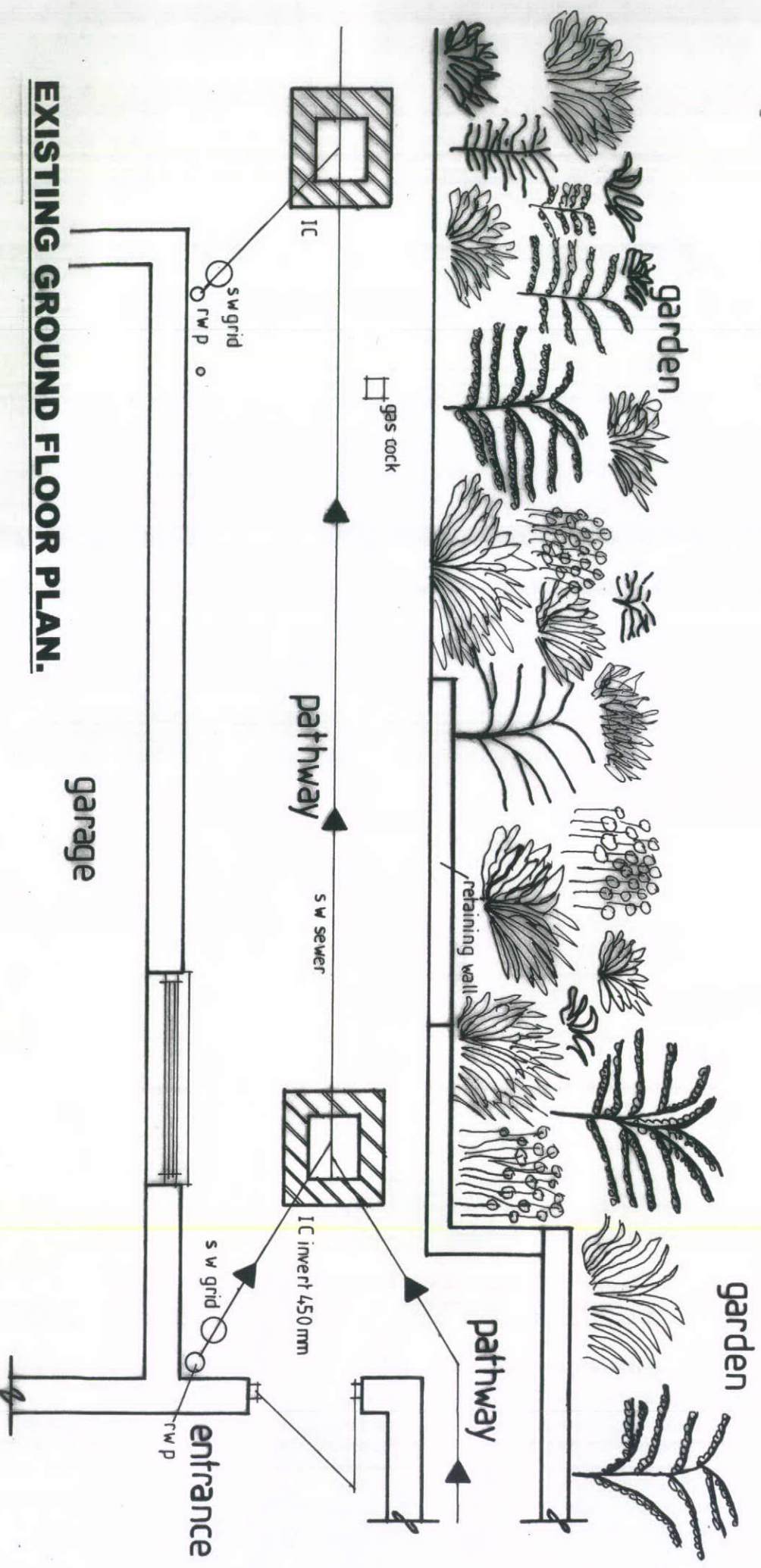

**EXISTING GROUND FLOOR PLAN.**

**EXISTING NORTH ELEVATION.**

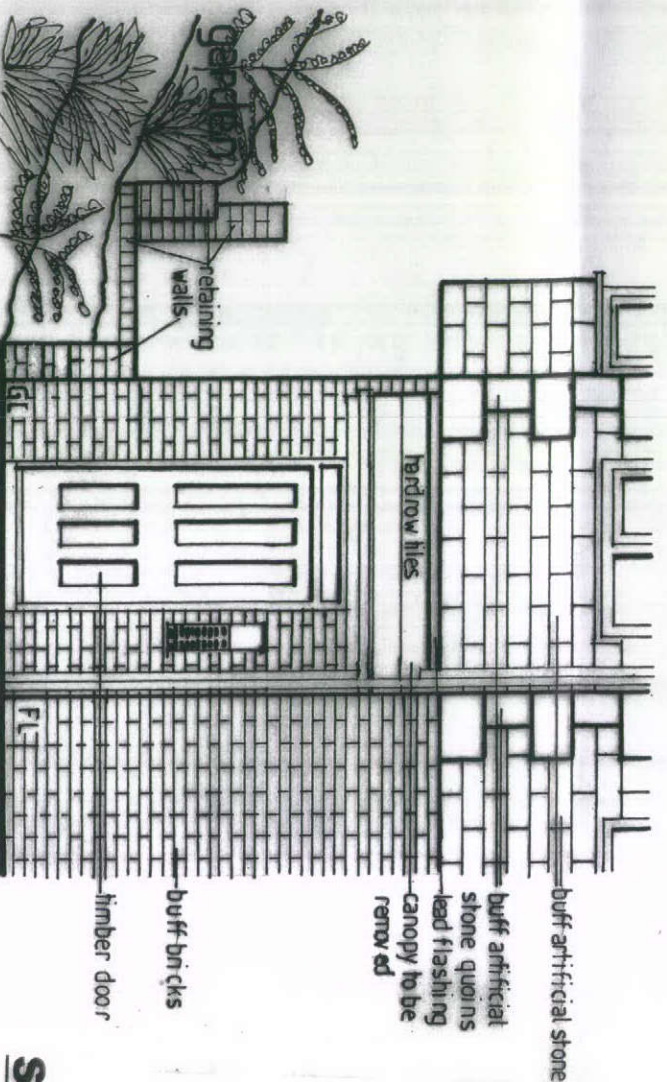

**NOTES.**

1. Whilst it is proposed that the 250mm thick masonry walls of the bin store will sit on 300mm deep by 600mm wide concrete footings it may be necessary construct a concrete raft to build the store off if rock is encountered during the excavations for the footings.
2. The walls below ground level will be constructed using 450 x 215 x 150mm solid concrete blocks laid flat, face to face on three elevations and buff artificial stone blocks to match the existing for the outer skin above ground level having a 50mm cavity having an inner skin of 450 x 215 x 100mm solid concrete blocks.
3. A sheet of bituthene will be incorporated on the exterior face of the wall below ground level and lapped into the Visqueen membrane under the concrete floor to provide a waterproof membrane.
4. The reinforced concrete floor to the bin store will have a slight slope towards the access openings to assist the with the cleaning of the storage area.
5. The roof is to have a pitch of 25° being formed with 50 x 125mm rafters at 400mm centres secured to 75 x 100mm wall plates secured with 35 x 900mm bat straps at around 1100mm centres to the blockwork.
6. Two 75 x 200mm timbers or similar are to be used as shown on the plans to support the canopy over the east gable entrance door.
7. The roof is to be covered with sound reclaimed Hardrow tiles obtained from the main roof of the block when it is re-roofed in the next few months nailed with galvanised nails to tanalised laths on grade one roofing felt.

**SECTION PROPOSED BIN STORE.**

