

ARBORICULTURAL SURVEY

REC'D
3 JUN 2015
PK/2015/0347

105

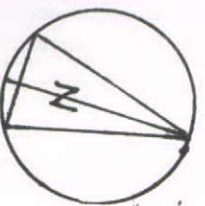

SCALE 1:200

THH

B55837 2005 Trees in relation to construction - Categories and definitions

Trees for removal

11 Identification on Plan - 'R/C' - Those in such a condition that any existing value would be lost within 10 years and which should in the current context, be removed for reasons of sound Arboricultural management.

Criteria

Trees that have a serious, irreparable, structural defect, such that their early loss is expected due to collapse, including those that will become unstable after removal of other R category trees (ie where, for whatever reason, the loss of companion shelter cannot be mitigated by pruning)

Trees that are dead or are showing signs of significant, immediate, and irreversible overall decline

Trees infected with pathogens of significance to the health and/or safety of other trees nearby (e.g. Dutch elm disease) or very low quality trees suppressing adjacent trees of better quality

NOTE: Habitat reinstatement may be appropriate (e.g. R category tree used as a bat roost; installation of bat box in nearby tree)

Trees to be considered for retention

12 Identification on Plan - 'R/H' - Those of high quality and value in such a condition as to be able to make a substantial contribution (a minimum of 40 years is suggested)

13 Identification on Plan - 'M/R' - Those of moderate quality and value: those in such a condition as to make a significant contribution (a minimum of 20 years is suggested)

14 Identification on Plan - 'G/T' - Those of low quality and value: currently in adequate condition to make a contribution but need pruning (a minimum of 10 years is suggested), or young trees with a stem diameter below 150mm

Category C trees will usually not be retained where they would impose a significant constraint on development. Young trees with a stem diameter of less than 150 mm should be considered for retention. Category A and B trees will normally be retained

Criteria - Subcategories

The following subcategories are applied. Trees may be allocated more than one subcategory, but this will not increase their overall value

1. Mainly Arboricultural values

A1. Trees that are particularly good examples of their species, especially if rare or unusual, or essential components of groups, or formal or semi-formal Arboricultural features (e.g. the dominant and/or principal trees within an avenue)

B1. Trees that might be included in the high category, but are downgraded because of impaired condition (e.g. presence of remediable defects including unsympathetic past management and minor storm damage)

C1. Trees not qualifying in higher categories

2. Mainly landscape values

A2. Trees, groups or woodlands which provide a definite screening or softening effect to the locality in relation to views into or out of the site, or those of particular visual importance (e.g. avenues or other Arboricultural features assessed as groups)

B2. Trees present in numbers, usually as groups or woodlands, such that they form distinct landscape features, thereby attracting a higher collective rating than they might as individuals but which are not individually, essential components of formal or semi-formal Arboricultural features (e.g. trees of moderate quality within an avenue that includes better. A category specimen), or trees situated mainly internally to the site, therefore individually having little visual impact on the wider locality

C2. Trees present in groups or woodlands, but without this conferring on them significantly greater landscape value, and/or trees offering low or only temporary screening benefit

3. Mainly cultural values, including conservation

A3. Trees, groups or woodlands of significant conservation, historical, commemorative or other value (e.g. veteran trees or wood pasture)

B3. Trees with clearly identifiable conservation or other cultural benefits

C3. Trees with very limited conservation or other cultural benefits

KEY:



Surveyed tree
- category A



Surveyed tree
- category B



Surveyed tree
- category C



Surveyed tree
- category U



Surveyed tree
- extent of root protection area (RPA)

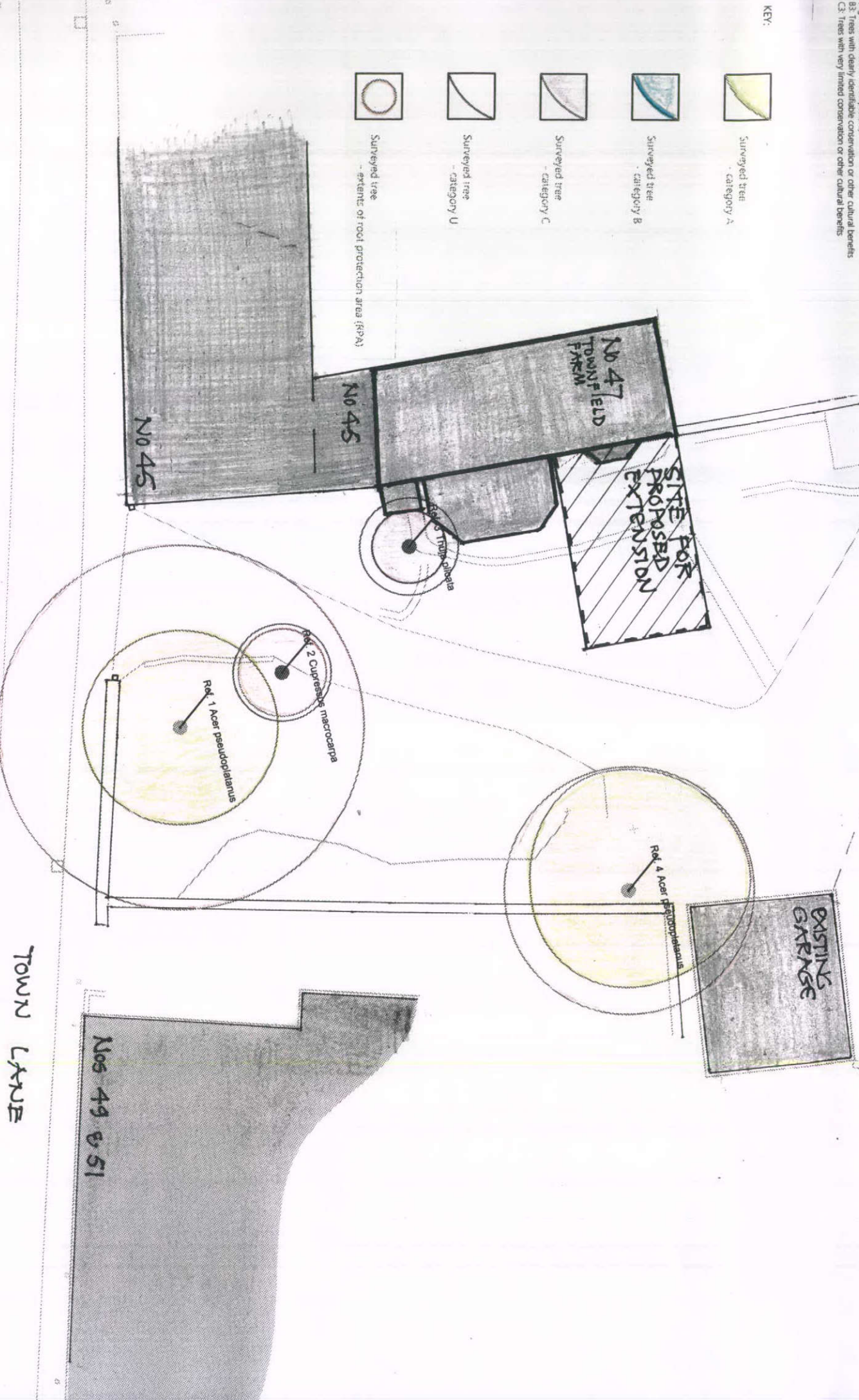

TERENCE SULLIVAN DIP ARCH ARIBA

ARCHITECT, SURVEYOR
BRITISH HERITAGE CONSULTANT

6 AMHERST GARDENS · HASTINGS · TN34 1TU

TEL: 01424 435812

MOB: 07450 381458

EMAIL: TERENCE.SULLIVAN83@BTINTERNET.COM

REVISION/RECORD
DRAWN 105
MAY 2015

October 2014
17/05/13/15