

AREAS IN RED DASHED BOXES REQUIRE PATCH REPAIR TO CARPET

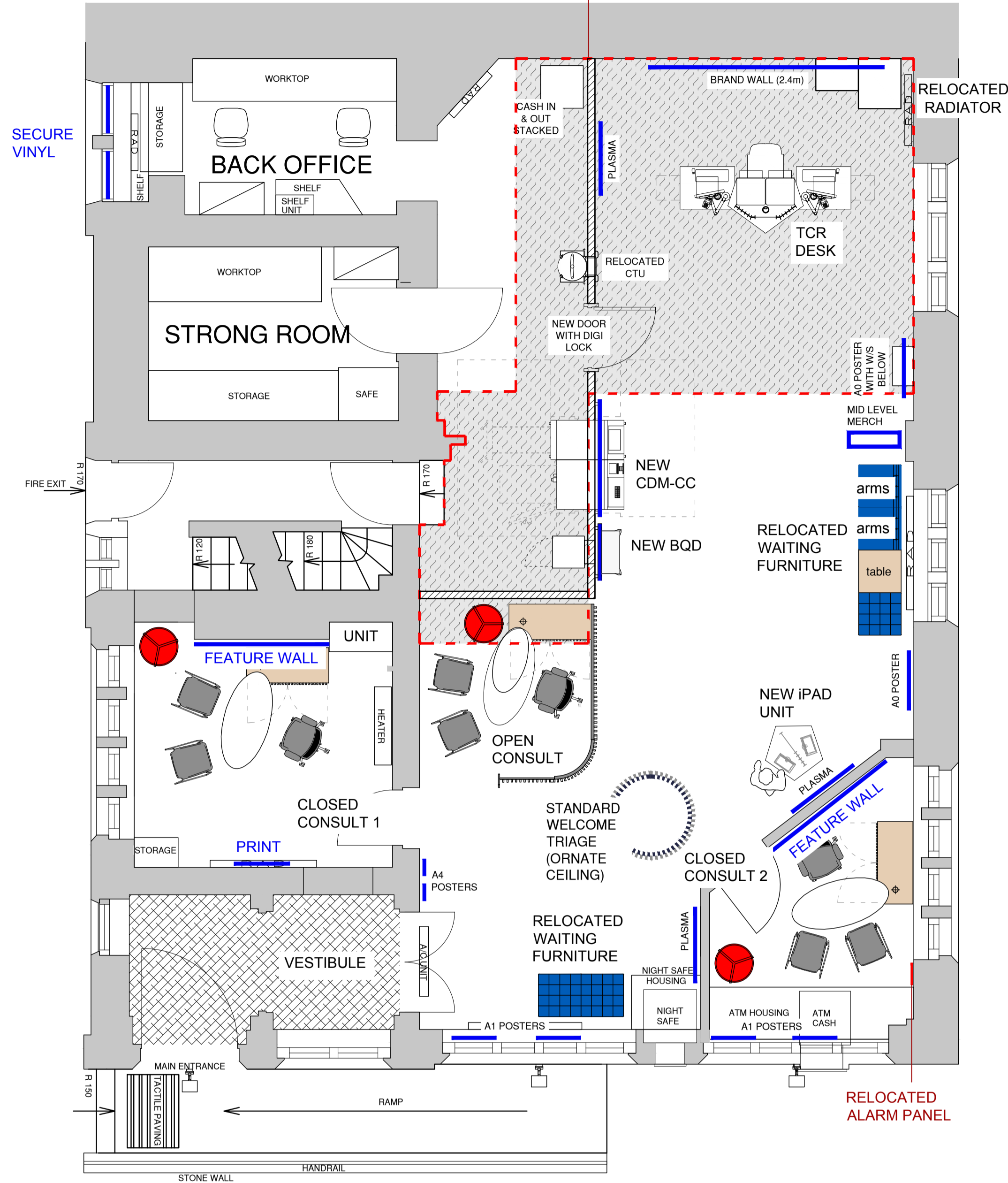

VESTIBULE:

- CLEAN STAIN GLASS WINDOW
- DEEP CLEAN EXISTING BARRIER MATTING
- DEEP CLEAN INTERNAL STONEWORK WALLS
- REMOVE EXISTING MERCHANDISING
- DOOR FRAMES AND ARCHITRAVES: PAINT FINISH: RETAIN AND REDECORATE
- RE-VARNISH TIMBER DOOR FRAMES AND ARCHITRAVES
- REMOVE EXISTING PLANTS
- REMOVE EXISTING BLUEBERRY VINYL DOTS ON AUTOMATIC BI-FOLDING DOORS AND REPLACE WITH DUSTED CRYSTAL CHEVRONS
- RUB DOWN AND REDECORATE TIMBER FRAMES TO STAIN GLASS WINDOWS

BANKING HALL:

- WALLS: CLEAN AND RE-DECORATE TO SECOND DATUM LINE (ORNATE DETAIL ABOVE SECOND DATUM LINE TO BE LEFT UNTOUCHED)
- WALLS: CLEAN STONEWORK WALLS INTERNALLY
- FLOOR: PATCH REPAIR EXISTING CARPET TO MATCH EXISTING TO SUIT NEW LAYOUT - MILLIKEN CARPET TILES & CLEAN EXISTING
- CEILING: ORNATE CEILING TO BE LEFT UNTOUCHED
- LIGHTING: CLEAN AND RE-LAMP EXISTING
- LIGHTING: RECONFIGURE PENDENT TO SUIT NEW LAYOUT (TBC)
- SKIRTING: PAINTED FINISH: REDECORATE
- DOOR FRAMES AND ARCHITRAVES: PAINTED FINISH: REDECORATE
- DOORS: PAINT FINISH: RETAIN AND RE-PAINT
- DOOR IRONMONGERY: REPLACE WITH NEW LAIDLAW CENTURION RANGE IF EXISTING DOESNT MATCH NEW SPEC
- KICKPLATE'S: REPLACE WITH NEW
- WINDOWS/CILLS: TIMBER FINISH: MAKE GOOD AND VARNISH INCLUDE BUILT IN CUPBOARD UNDER WINDOW
- RADIATORS/PIPEWORK: CLEAN AND REDECORATE WITH HEAT RESISTANT PAINT
- REMOVE 1NO RADIATOR AND RELOCATE 1NO RADIATOR
- SOCKETS/SWITCHES: REPLACE EXISTING WITH WHITE PLASTIC
- ELECTRICAL TRUNKING: RETAIN AND MAKE GOOD, REPLACE ANY DAMAGED OR BLACK WITH WHITE
- ENQUIRES DESK: REMOVE EXISTING AND ASSOCIATED FIXTURES AND FITTINGS
- QUEUE SYSTEM: REMOVE EXISTING
- RETAIN EXISTING WAITING FURNITURE AND RELOCATE TO SUIT NEW LAYOUT
- OPEN CONSULT: INSTALL NEW CURVED SLATTED SCREEN WITH NEW TRIPOD LAMP, NEW BOSS CUSTOMER CHAIRS OPERATORS CHAIR, NEW INTERVIEW ROOM DESK COMPLETE WITH ALL ASSOCIATED RELOCATION OF DATA / POWER OUTLETS & CABLING
- INSTALL 1NO IPAD DESK WITH ALL ASSOCIATED DATA/POWER OUTLETS & CABLING TO ACCOMMODATE 2 IPADS WITH PRIVACY FIN.
- INSTALL NEW CLOCK
- REMOVE OLD SPEC INTERNAL SIGNAGE AND MERCHANDISING INCLUDING SUSPENDED SIGNAGE
- CLEAN AIR CONDITIONING AND VENTS
- NIGHT SAFE AND ATM HOUSING: RETAIN AND VARNISH
- REMOVE QD PAY IN BOX
- REMOVE 2NO WRITING SHELF AND RELOCATE
- RELOCATE EXISTING ALARM PANEL FROM BEHIND QUEUES DESK
- REMOVE PARTITION AND DOOR OF EXISTING CORNER CLOSED CONSULT IN BANKING HALL AND MAKE GOOD WALLS
- COUNTERS: REMOVE EXISTING COUNTERS, GLAZED SCREEN, ANTI CLIMB GLAZING, CTU AND ALL ASSOCIATED SIGNAGE, DATA & CABLING
- DEMOLISH EXISTING PARTITIONS WITHIN BANKING WALL AND MAKE GOOD WALLS
- FORM NEW STUD PARTITION WITH RETURN TO TO FORM NEW CLOSED CONSULT FROM AND INSTALL NEW DOOR (3200MM HIGH TBC)
- INSTALL 1NO SECURE DOORS WITH NEW IRONMONGERY SEPC AND LOCKS WITH 1NO KEYPADS TO NEW SECURE LOBBY. (RBS SECURITY TO CONFIRM SECURE LOBBY DOOR SPEC)
- INSTALL NEW CDM-CC
- INSTALL NEW CTU
- INSTALL NEW BQD WITH FLOATING PANEL AND

- RESTATE RELOCATED EXISTING WRITING SHELF
- REMOVE 2NO SECURITY CAMERA TO EITHER SIDE OF EXISTING TELLERS INCLUDING CCTV MONITOR - RBS SECURITY TO CONFIRM NEW LOCATION

CLOSED CONSULTS 1:

- WALLS: CLEAN AND RE-DECORATE (REMOVE EXISTING FEATURE WALL)
- REMOVE EXISTING NATWEST LOGO ON EXISTING FEATURE WALL AND INSTALL NEW
- WALLS: 1NO FEATURE WALL PER CLOSED CONSULT
- LIGHTING: REMOVE UP LIGHTS, CLEAN AND RE-LAMP EXISTING CEILING LIGHTS
- REMOVE UP LIGHTS AND MAKE GOOD WALL
- SKIRTING: PAINTED FINISH: REDECORATE
- REMOVE TRUCKING AND INSTALL NEW TO SUIT NEW POWER AND DATA
- RELOCATE AIR CONDITION UNIT (RBS TO CONFIRM)
- DOOR FRAMES AND ARCHITRAVES: PAINTED FINISH: REDECORATE
- DOORS: CLEAN GLAZING AND REDECORATE PAINT FINISH
- SOCKETS/SWITCHES: RELOCATE TO SUIT NEW DESK LOCATION AND REPLACE IF REQUIRED
- ELECTRICAL TRUNKING: RETAIN AND MAKE GOOD, REPLACE ANY DAMAGED OR BLACK WITH WHITE
- NEW 1NO TRIPOD LAMP PER CONSULT ROOM
- NEW INTERVIEW ROOM DESKS COMPLETE WITH ALL ASSOCIATED RELOCATION OF DATA / POWER OUTLETS & CABLING PER CONSULT ROOM
- CLEAN EXISTING 2NO BOSS CUSTOMER CHAIRS AND INSTALL 1NO NEW OPERATORS CHAIR PER CONSULT ROOM
- INSTALL POWER AND DATA FEEDS FOR VIDEO CONFERRING FACILITIES AND RELATED EQUIPMENT IN CLOSED CONSULT 1

CLOSED CONSULTS 2:

- WALLS: CLEAN AND RE-DECORATE EXISTING WALLS TO SECOND DATUM LINE (ORNATE DETAIL ABOVE SECOND DATUM LINE TO BE LEFT UNTOUCHED)
- WALLS: 1NO FEATURE WALL PER CLOSED CONSULT
- FLOOR: PATCH REPAIR EXISTING CARPET TO MATCH EXISTING TO SUIT NEW LAYOUT - MILLIKEN CARPET TILES - ESSENTIALS DESIGN LAYLINES 5158
- CEILING: ORNATE CEILING TO BE LEFT UNTOUCHED
- LIGHTING: CLEAN AND RE-LAMP EXISTING
- LIGHTING: RECONFIGURE PENDENT TO SUIT NEW LAYOUT (TBC)
- SKIRTING: PAINTED FINISH: REDECORATE
- DOOR FRAMES AND ARCHITRAVES: PAINTED FINISH: PAINT TO MATCH EXISTING
- DOORS: NEW CONSULT DOOR
- DOOR IRONMONGERY: NEW LAIDLAW CENTURION RANGE
- RADIATORS/PIPEWORK: CLEAN AND REDECORATE WITH HEAT RESISTANT PAINT
- SOCKETS/SWITCHES: REPLACE EXISTING WITH WHITE PLASTIC
- ELECTRICAL TRUNKING: RETAIN AND MAKE GOOD, REPLACE ANY DAMAGED OR BLACK WITH WHITE
- NEW 1NO TRIPOD LAMP PER CONSULT ROOM
- CLEAN EXISTING 2NO BOSS CUSTOMER CHAIRS AND INSTALL 1NO NEW OPERATORS CHAIR PER CONSULT ROOM
- NEW INTERVIEW ROOM DESKS COMPLETE WITH ALL ASSOCIATED RELOCATION OF DATA / POWER OUTLETS & CABLING PER CONSULT ROOM

BOH OFFICE:

- WALLS: CLEAN AND RE-DECORATE
- CEILING: REDECORATE PLASTERBOARD CEILING
- LIGHTING: CLEAN AND RE-LAMP EXISTING
- SKIRTING: PAINTED FINISH: REDECORATE
- DOOR FRAMES AND ARCHITRAVES: PAINT FINISH: REDECORATE
- DOORS:TIMBER FINISH: CLEAN AND VARNISH
- WINDOWS/CILLS: PAINTED FINISH: REDECORATE
- RADIATORS/PIPEWORK: CLEAN AND REDECORATE WITH HEAT RESISTANT PAINT
- DEEP CLEAN EXISTING DESKS AND CHAIRS

MERCHANDISING (INTERNAL)	
QTY	DESCRIPTION
4	(WINDOWS) A1 BRAND POSTER: CONTENT TBC
2	A0 BRAND POSTER: CONTENT TBC
2	A4 BRAND POSTER: CONTENT TBC
1	BRAND WALL
1	FLOATING PANEL FOR BQD
1	FLOATING PANEL FOR CDM-CC
1	FREESTANDING UNIT (LOW)
2	FEATURE PAINTED WALL IN CONSULT ROOM WITH 3D NATWEST LOGO
1	TCR DESK SIGNAGE (TBC)
1	IPAD DESK SIGNAGE (TBC)
3	WALL MOUNTED LCD SCREEN (55" and 46")
1	HERITAGE PRINT - SUPPLIED BY NOVOGRAF

FURNITURE (GROUND)	
QTY	DESCRIPTION
1	IPAD UNIT (ACCOMMODATING 2NO IPADS)
1	TCR DESK (DOUBLE DESK)
1	TCR DESK COIN STORAGE WITH HOUSING
1	TCR DESK STORAGE UNIT
7	STAFF CHAIR
1	BAG TABLE
1	WRITING SHELF
2	CONSULT ROOM TABLE TYPE 1
2	CONSULT PEDESTAL
1	CLOCK
2	STANDARD LAMP

PARTITION KEY	
	NEW STANDARD STUD PARTITION
	NEW G2 RATED PARTITION

ALL NEW PARTITIONS TO BE TAKEN FULL HEIGHT TO UNDERSIDE OF STRUCTURAL SOFFIT.

FLOOR FINISHES KEY	
	BARRIER MATTING 3M NOMAD OPTIMA 9920-17 RECESSED BARRIER MATTING COLOUR: ANTHRACITE BLACK
	NEW MILLIKEN CARPET ESSENTIALS DESIGN LAYLINES 5158
	BANKING HALL VINYL FLOOR AMTICOXTRA 'GOLDEN OAK' TIMBER FLOORING, REF: AROW 7510
	NO WORKS HATCH

RBS SECURITY TO CONFIRM IF NEW ANTI CLIMB GLAZING SHOULD BE INSTALLED

EXISTING CASH DELIVERY ROUTE - FRONT OF HOUSE THROUGH CTU

SCHEME SUBJECT TO RBSG SECURITY APPROVAL

PAINT FINISHES	
CONSULT FEATURE WALL: DULUX DIAMOND MATT EMULSION 802R666	
WALL: DIAMOND MATT EMULSION DULUX 30YY 69/048	
CEILING: SPRAY WHITE RAL9010	
SKIRTINGS: SATIN DULUX 43/083	
DOOR FRAMES & ARCHITRAVES: SATIN DULUX 20YY 43/083	
WINDOW FRAMES & CILLS: SATIN DULUX 20YY 43/083	
RADIATORS & PIPES: HEAT RESISTANT PAINT DULUX 30YY 69/048	

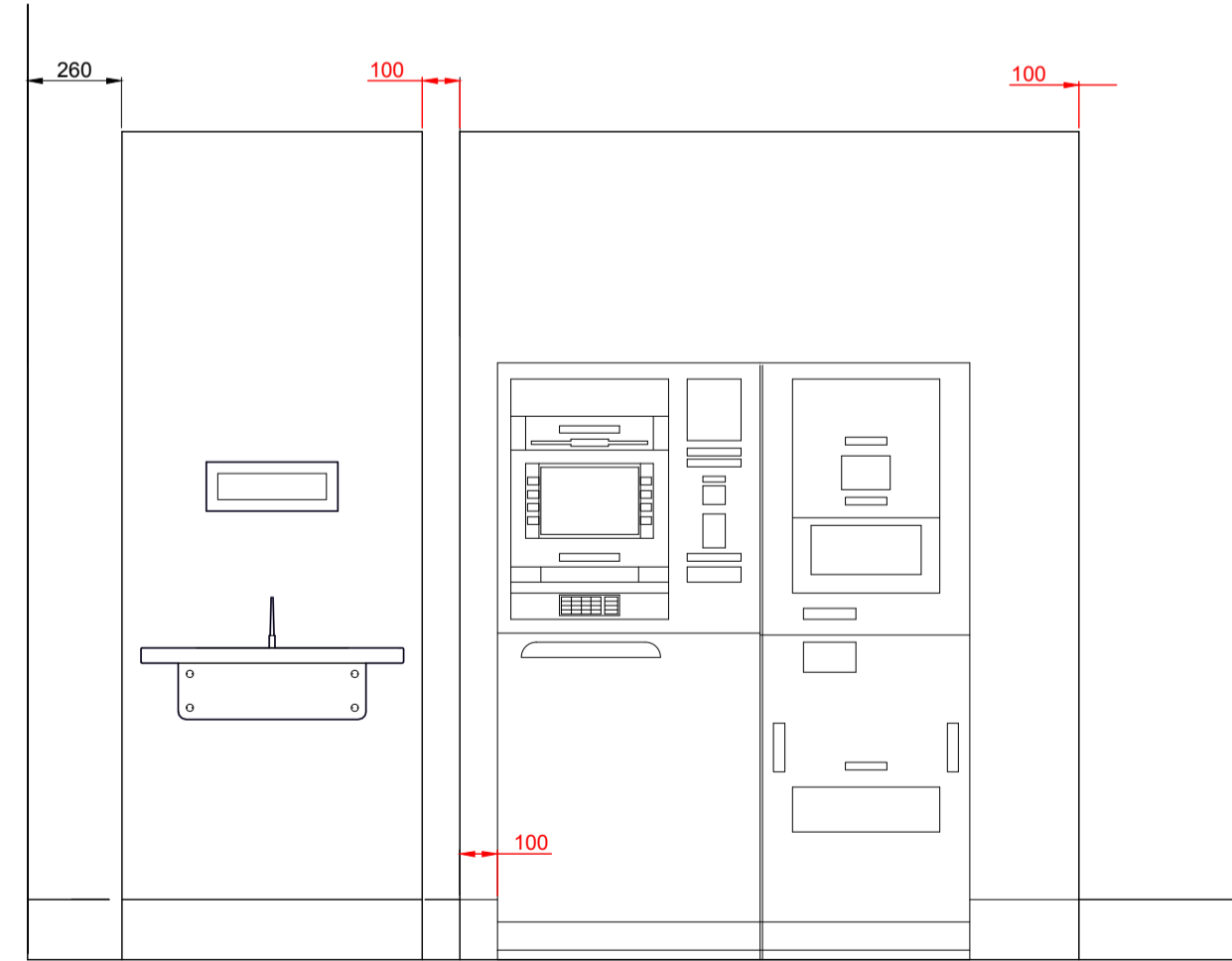

AUTOMATION WALL ELEVATION SCALE 1:20

rev.	date	details	by	rev.	date	details	by	notes
P1	05.03.14	First Issue for Costing	KR					

NW Glossop
Norfolk St, Glossop
SK13 8BR

drawing number	revision	drawing title	scale
HBR20.AR(PL)008	P1	Scoping Drawing Proposed GROUND FLOOR	1:50 date 05.03.14 drawn KR format A1
status Planning			