

FOR RAFTER AND CEILING DETAILS
SEE ROOF CONSTRUCTION NOTES &
ROOF PLAN

ROOF TILES TO BE SUITABLE FOR
PITCH (CONFIRM WITH
MANUFACTURERS) CONTRACTOR
TO SET ROOF PITCH AND
FLASHING LEVEL OUT AT EARLIEST
POSSIBLE DATE

CODE 4 LEAD
FLASHING AND CAVITY
TRAY AT ABUTMENT

EAVES VENT REQUIRED

PROPRIETARY CAVITY
CLOSER AND DPC
HORIZONTALLY AND
VERTICALLY TO WINDOW
AND DOOR REVEALS

DOUBLE DPC CAVITY
TRAY DETAIL AT
DOOR THRESHOLD

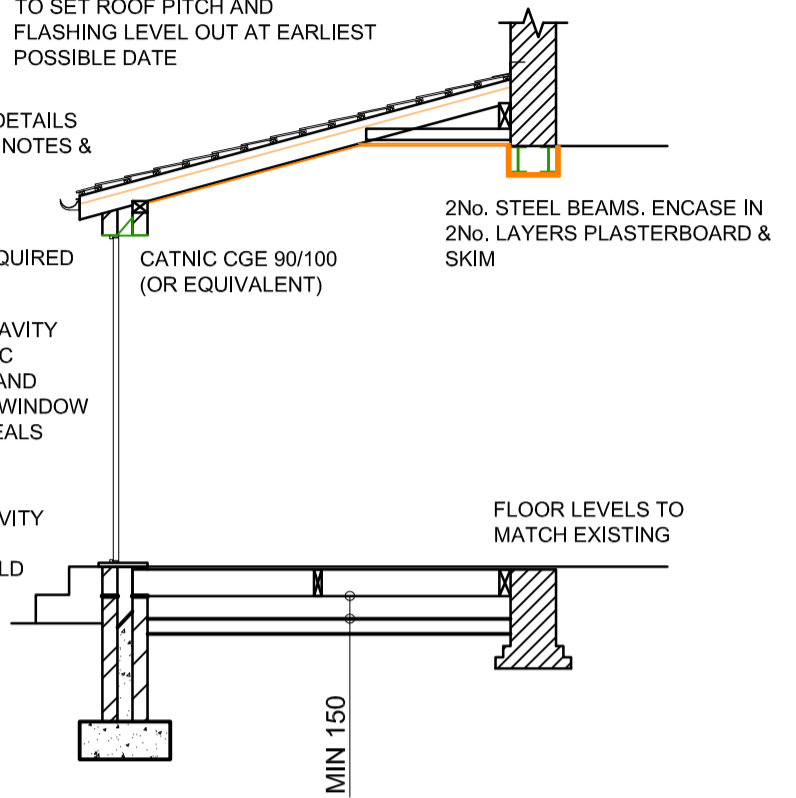

TYPICAL SECTION

PROPOSED GROUND FLOOR PLAN



DENOTES POSITION OF HEAT DETECTOR -MAINS
OPERATED-INTER LINKED WITH BATTERY BACK UP
POSITIONED AT A MINIMUM OF 300mm FROM WALL AND
CEILING LIGHT FITTINGS AND IN ACCORDANCE WITH
AD-B1-PARAGRAPHS 1.10 TO 1.18.

THERMABATE INSULATED CAVITY CLOSERS (OR
EQUIVALENT) AROUND WINDOW AND DOOR OPENINGS

POSITION OF SWITCHES, SOCKETS RADIATORS ETC TO
BE CONFIRMED WITH CLIENT ON SITE. ANY NEW
RADIATORS TO BE FITTED WITH THERMOSTATICALLY
CONTROLLED VALVES. LIGHT FITTINGS TO BE ENERGY
EFFICIENT TYPES

ELECTRICAL WORK TO IEE 17th EDITION, DESIGNED,
INSTALLED AND TESTED BY A PERSON COMPETENT TO
DO SO AND WHO IS REGISTERED WITH A PART P
COMPETENT PERSONS SCHEME. COMMISSIONING
CERTIFICATES SHOULD BE PROVIDED IN ACCORDANCE TO BS 7671.

ALL PLUMBING WORK TO BE CARRIED OUT BY GAS SAFE
(FORMERLY CORGI) REGISTERED CONTRACTOR

NOTES:

1. DO NOT SCALE FROM THIS DRAWING.
2. THIS DRAWING TO BE READ IN CONJUNCTION WITH ALL RELEVANT DESIGN DRAWINGS AND SPECIFICATION NOTES- PARTICULARLY THE 'GENERAL PLAN NOTES'.
3. ALL DIMENSIONS TO BE CONFIRMED ON SITE.

| | |
|--------------------------------------|--|
| CLIENT | MR C HOPWOOD |
| PROJECT | REAR EXTENSION 12 BINGSWOOD AVENUE WHALEY BRIDGE |
| TITLE | G.F. PLAN & SECTION |
| SCALE: | 1:50 |
| PLANS & SOLUTIONS DESIGN PRACTICE | DATE APR 2014 SHEET SIZE A3 Tel. 07919 191751 DWG No. B04 |
| Email : plansandsolutions@gmail.com | |