



Construction Safety Consultants, CDM Co-ordinators and Asbestos Surveyors
www.eurosafek.co.uk

SURVEY FOR ASBESTOS CONTAINING MATERIALS

7 High Street West

Glossop
SK13 8AL



Client: William Hill

Version: 1

Project No: ES/51356

First Surveyed: 30 August 2013

EUROSAFE UK LTD. Co. Reg. No. 3262851
EurosafE House, Tribune Way, Centurion Park, Clifton Moor, York. YO30 4RY

Email: eurosafek@eurosafek.co.uk

EurosafE House
Centurion Park, Tribune Way
Clifton Moor, York YO30 4RY

Tel: 01904 691515 Fax: 01904 691066

Weston House
Bradgate Park View, Chellaston
Derby, DE73, 5UJ

Tel: 01332 690306 Fax: 01332 705364

Hamilton House, Mabledon Place
Bloomsbury
London WC1H 9BB

Tel: 0800 158 3093

Contents

- 1 Executive Summary**
- 2 Summary of Asbestos Incidence by Type**
- 3 Introduction**
- 4 Version History**
- 5 Declaration of Conformity**

APPENDIX A: Register of Asbestos Containing Materials

APPENDIX B: Register of Non-Asbestos Containing Materials

APPENDIX C: Summary of Asbestos Containing Samples

APPENDIX D: Summary of Non-Asbestos Containing Samples

APPENDIX E: Actions Required in Priority Order

APPENDIX F: Register of Asbestos Removals

APPENDIX G: Drawings

APPENDIX H: Bulk Reports

1 Executive Summary

1.1 Location of Asbestos Containing Materials

- ES/51356/01 - B/R004 - Basement - Drop room - To pipework
- ES/51356/02 - B/R004 - Basement - Drop room - To walls and ceiling adjacent to pipework
- ES/51356/08 - GF/R005 - Ground Floor - Shop floor - Above boiler
- ES/51356/04 - B/R003 - Basement - Rear store - To wall
- ES/51356/05 - B/R002 - Basement - Store off stairs - To walls
- ES/51356/03 - B/R004 - Basement - Drop room - To floor
- ES/51356/18 - GF/R011 - Ground Floor - Stairs to first floor - To steps
- ES/51356/11 - GF/R005 - Ground Floor - Shop floor - To floor below large radiators on the right hand side
- ES/51356/21 - 2F/R020 - 2nd Floor - Toilet - To wall
- ES/51356/10 - GF/R005 - Ground Floor - Shop floor - To surrounds of 2 small radiators
- ES/51356/15 - GF/R005 - Ground Floor - Shop floor - To main body of boiler
- ES/51356/23 - E/R099 - External - External areas - To main pitched roof
- ES/51356/09 - GF/R005 - Ground Floor - Shop floor - To floor below 2 small radiators
- ES/51356/14 - GF/R005 - Ground Floor - Shop floor - To boiler pilot light glass

1.2 No Access (therefore the area is presumed to contain asbestos)

- Limited survey to shop front boxings due to listed status
- Limited survey to ceiling in ground floor sales area due to listed status
- Limited inspection behind timber panelling and boxing in stock room and consultation room due to listed status

1.3 High Risk Asbestos Containing Materials

- ES/51356/01 - Pipe insulation - B/R004 - Basement - Drop room - To pipework
- ES/51356/02 - Insulation residue - B/R004 - Basement - Drop room - To walls and ceiling adjacent to pipework
- ES/51356/03 - Insulation debris - B/R004 - Basement - Drop room - To floor

1.4 Actions which must be undertaken

- ES/51356/01 - Pipe insulation - B/R004 - Basement - Drop room - To pipework - Remove
- ES/51356/02 - Insulation residue - B/R004 - Basement - Drop room - To walls and ceiling adjacent to pipework - Remove
- ES/51356/03 - Insulation debris - B/R004 - Basement - Drop room - To floor - Environmental clean
- ES/51356/09 - Insulating board - GF/R005 - Ground Floor - Shop floor - To floor below 2 small radiators - Remove
- ES/51356/10 - Insulating board debris - GF/R005 - Ground Floor - Shop floor - To surrounds of 2 small radiators - Remove

- ES/51356/11 - Insulating board - GF/R005 - Ground Floor - Shop floor - To floor below large radiators on the right hand side - Remove
- ES/51356/14 - Gaskets - GF/R005 - Ground Floor - Shop floor - To boiler pilot light glass - Remove
- ES/51356/15 - Gaskets - GF/R005 - Ground Floor - Shop floor - To main body of boiler - Remove

2 Summary of Asbestos Incidence by Type

2.1 Asbestos Coatings (Licensed Contractors usually required)

None identified

2.2 Asbestos Insulation (Licensed Contractors usually required)

- ES/51356/01 - B/R004 - Basement - Drop room - To pipework
- ES/51356/02 - B/R004 - Basement - Drop room - To walls and ceiling adjacent to pipework
- ES/51356/03 - B/R004 - Basement - Drop room - To floor

2.3 Asbestos Insulating Board, Millboard, Gaskets, Rope and Paper (Licensed Contractors usually required)

- ES/51356/04 - B/R003 - Basement - Rear store - To wall
- ES/51356/05 - B/R002 - Basement - Store off stairs - To walls
- ES/51356/09 - GF/R005 - Ground Floor - Shop floor - To floor below 2 small radiators
- ES/51356/10 - GF/R005 - Ground Floor - Shop floor - To surrounds of 2 small radiators
- ES/51356/11 - GF/R005 - Ground Floor - Shop floor - To floor below large radiators on the right hand side

2.4 Asbestos Gaskets, Rope and Paper (Competent Contractors usually required)

- ES/51356/14 - GF/R005 - Ground Floor - Shop floor - To boiler pilot light glass
- ES/51356/15 - GF/R005 - Ground Floor - Shop floor - To main body of boiler

2.5 Textured Coating (Competent Contractors usually required)

None identified

2.6 Asbestos Cement Products (Competent Contractors usually required)

- ES/51356/08 - GF/R005 - Ground Floor - Shop floor - Above boiler
- ES/51356/23 - E/R099 - External - External areas - To main pitched roof

2.7 Bonded Asbestos Products - Vinyl Floor Tiles, Bitumen, Plastic, etc (Competent Contractors usually required)

- ES/51356/18 - GF/R011 - Ground Floor - Stairs to first floor - To steps
- ES/51356/21 - 2F/R020 - 2nd Floor - Toilet - To wall

IMPORTANT:

One or more areas within this property have been classed as contaminated. Access into any of these is prohibited until they have been deemed as safe to enter following suitable remedial works. Please ensure you familiarise yourself with the survey findings accordingly.

3 Introduction

3.1 The building known as:

7 High Street West
Glossop
SK13 8AL

has been subjected to a Refurbishment and Demolition survey. This survey was undertaken in accordance with HSG264 (Asbestos: The Survey Guide) by Andy Owen and Adam Martin on 30/08/2013 acting on behalf of Martin Bennett. For an explanation of the terminology within this report, please refer to the [Legislative Guidance Notes](#) distributed with this report.

A refurbishment and demolition survey is used to locate and describe, as far as reasonable practicable, all ACMs in the area where the refurbishment work will take place or in the whole building if demolition is planned. The survey will be fully intrusive and involve destructive inspection, as necessary, to gain access to all areas, including those that may be difficult to reach.

Additional surveying, inspections and further information may be added to this survey report and will be reported within the version history below:

3.2 This building was at the time of survey being used as a retail outlet and was unoccupied.

It is constructed from load bearing masonry external walls with a pitched slate covered roof. Internally, there are plasterboard and stud partition walls with concrete and timber floors. The rainwater goods are uPVC, cement and cast iron.

There are no associated outbuildings.

3.3 The survey was limited to the following areas: (Note: Any numbered points below refer to areas on the corresponding drawings in Appendix G)

- Basement
- Ground floor
- First floor
- Second floor
- Attic
- Loft space
- Ceiling voids
- Exterior of building
- External areas

3.4 No survey was carried out in the following areas, therefore these areas are presumed to

contain asbestos:

- Limited survey to shop front boxings due to listed status
- Limited survey to ceiling in ground floor sales area due to listed status
- Limited inspection behind timber panelling and boxing in stock room and consultation room due to listed status

3.5 Specific exclusions relating to the survey:

- We have not inspected electrical and mechanical plant and equipment or similar which require the attendance of a specialist engineer. This includes the:
 - Electrical distribution board and associated equipment throughout (if applicable)
 - Wall mounted heaters - Dimplex
 - Water heaters - Triton
 - Gloworm 45-60 boiler

3.6 Specific exclusions relating to sampling:

3.6.1 Materials contained within the premises could be suspected as containing asbestos by persons untrained in the identification of asbestos containing materials. For the purpose of clarity the following materials have been visually inspected by our surveyors and they have determined that the materials are not asbestos containing:

- Fibreboard ceiling tiles in ground floor kitchen and stock room - too new
- Black nosing strips to step from ground floor kitchen to stock room and store to stairwell lobby - too new
- Modern grey vinyl floor tiles to floor on ground floor throughout - too new
- Hessian backed black patched vinyl floor tiles to floor below grey vinyl floor tiles in ground floor shop floor area
- Brown timber effect lino in first floor store room - too new
- Black patterned vinyl floor covering to floor in first floor stock room - too new
- Copper water tank with MMMF jacket - too new
- Roofing felt repairs to main pitched roof and light well - too new
- Green mineral roofing felt to flat roof - too new

3.6.2 Where, during the survey inspection, materials were suspected of containing asbestos, samples were taken. However, where a large area of visually homogenous material was observed, only a few samples were collected and these were considered as being representative of the whole surface.

- 3.6.3 Samples have not been taken where:
- The act of sampling would endanger the surveyor or affect the functional integrity of the item concerned. For example, fuses within electrical boxes, gaskets, fire doors, ropes associated with heating, glazing or power plant, etc. Therefore all these materials are presumed to contain asbestos.
 - Behind or above suspected ACM's where the act of investigation could cause potential health risks from uncontrolled asbestos fibre release.
- 3.6.4 When samples have not been taken during the survey due to persons or circumstances preventing sampling, the client or client's representative will be notified at the time of the incident by a representative of Eurosafe UK. Any such exclusions and the reasons for the exclusions will be included in section 3.4.
- 3.6.5 Where a material has been observed as containing no asbestos, a sample was not taken. Caution should still be exercised, as in certain cases there may be the possibility of residual asbestos being trapped behind or under newly-applied insulation materials. This would usually be due to previous removal works not being conducted to a satisfactory standard. Whilst every effort has been made to identify such occurrences, it can often be difficult to detect without causing significant damage to the new materials.
- 3.6.6 In accordance with Regulation 4 of the Control of Asbestos Regulations (2012), which states that all materials must be presumed to contain asbestos unless there is strong evidence to suppose that they do not, Eurosafe UK employ a sampling strategy to specifically address this requirement through sampling and analysis of all materials that cannot be evidenced as being free from asbestos fibre types.
- 3.6.7 Materials have been referred to as Asbestos Insulating Board or Asbestos Cement based on content and visual appearance alone. Density checks on materials have not been carried out unless stated otherwise.
- 3.6.8 All quantities are approximate and have not all been arrived at using measuring aids. The quantities are for guidance purposes only and Eurosafe UK do not take any responsibility for the accuracy of the quantities.
- 3.6.9 The Priority Risk Assessment was undertaken at the time of the survey in respect of the information gathered from the Client and building user. Should the use of the building or a room where an ACM was identified change, then the priority risk assessment becomes null and void and a re-assessment must be undertaken by a suitably competent person.
- 3.6.10 Surveyors endeavour to lift any carpets during their surveying. It is usually the case however that they are unable to lift the entire carpet, because the carpeted area may be very large, have furniture placed upon it, or it may be stuck down etc. Therefore, we advise that site conditions at the time of the survey may mean that the entire floor area has not been surveyed.
- 3.7 The survey report remains the intellectual property of Eurosafe UK until full and final payment has been received.

4 Version History

- Version 1 This report is the initial report produced in accordance with CAR 2012. As removal works are undertaken on this building, amendments will be issued and published to www.cloudsuk.com.

5 Declaration of Conformity

The surveyor has checked this report and declared the contents to be accurate



Andy Owen

Technical content checked by

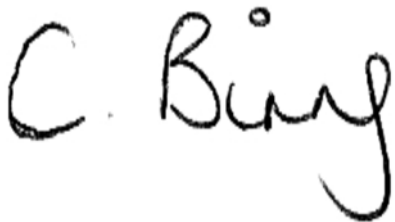

Claire Binns

Quality Manager

05 September 2013

APPENDIX A: Register of Asbestos Containing Materials

Sample No:	ES/51356/01		
Item:	Pipe insulation		
Location:	B/R004 - Basement - Drop room - To pipework		
Condition:	High Damage		
Extent:	~14 m lin		
Ease of access:	Easy	Surface treatment:	Unsealed
Lab reference:	T901/EUR1/496/001		
Results:	Chrysotile		
Algorithm:	Material	10	+ Priority 6 = 16
Recommendation:	Remove		
Urgency:	Medium (mid-term)		
Further Comments:	This area is contaminated and therefore access should be restricted until remedial works have been undertaken.		



Sample No:	ES/51356/02		
Item:	Insulation residue		
Location:	B/R004 - Basement - Drop room - To walls and ceiling adjacent to pipework		
Condition:	Medium Damage		
Extent:	~8 m lin		
Ease of access:	Easy	Surface treatment:	Unsealed
Lab reference:	T901/EUR1/496/002		
Results:	Chrysotile		
Algorithm:	Material	10	+ Priority 6 = 16
Recommendation:	Remove		
Urgency:	Medium (mid-term)		
Further Comments:	The residue is present to the length of the pipework, 0.5m ² above and 0.5m ² below the pipework. This area is contaminated and therefore access should be restricted until remedial works have been undertaken.		



Sample No: ES/51356/03
Item: Insulation debris
Location: B/R004 - Basement - Drop room - To floor
Condition: Low Damage
Extent: <1 m²
Ease of access: Easy **Surface treatment:** Unsealed
Lab reference: T901/EUR1/496/003
Results: Chrysotile
Algorithm: **Material** 10 + **Priority** 5 = 15
Recommendation: Environmental clean
Urgency: Medium (mid-term)
Further Comments: The total floor space is 11m². There are large amounts of rubbish in this area. This area is contaminated and therefore access should be restricted until remedial works have been undertaken.



Sample No: ES/51356/04
Item: Insulating board
Location: B/R003 - Basement - Rear store - To wall
Condition: Low Damage
Extent: ~1 m²
Ease of access: Easy **Surface treatment:** Sealed
Lab reference: T901/EUR1/496/004
Results: Chrysotile
Algorithm: **Material** 4 + **Priority** 5 = 9
Recommendation: Manage
Urgency: None (manage)
Further Comments:



Sample No: ES/51356/05
Item: Insulating board
Location: B/R002 - Basement - Store off stairs - To walls
Condition: Low Damage
Extent: ~1 m²
Ease of access: Easy **Surface treatment:** Sealed
Lab reference: No sample taken
Results: Strongly presumed to be Chrysotile
Algorithm: **Material** 4 + **Priority** 5 = 9
Recommendation: Manage
Urgency: None (manage)
Further Comments: Strongly presumed to be as sample ES/51356/04.



Sample No: ES/51356/08
Item: Cement flue pipe
Location: GF/R005 - Ground Floor - Shop floor - Above boiler
Condition: Low Damage
Extent: ~6 m lin
Ease of access: Easy **Surface treatment:** Unsealed
Lab reference: T901/EUR1/496/008
Results: Chrysotile
Algorithm: Material + Priority =
Recommendation: Manage
Urgency: None (manage)
Further Comments:



Sample No: ES/51356/09
Item: Insulating board
Location: GF/R005 - Ground Floor - Shop floor - To floor below 2 small radiators
Condition: Low Damage
Extent: <1 m²
Ease of access: Easy **Surface treatment:** Unsealed
Lab reference: T901/EUR1/496/009
Results: Chrysotile
Algorithm: Material + Priority =
Recommendation: Remove
Urgency: Medium (mid-term)
Further Comments: Present to 2 small radiators to the right hand side



Sample No: ES/51356/10
Item: Insulating board debris
Location: GF/R005 - Ground Floor - Shop floor - To surrounds of 2 small radiators
Condition: High Damage
Extent: ~4 m²
Ease of access: Easy **Surface treatment:** Unsealed
Lab reference: T901/EUR1/496/010
Results: Chrysotile
Algorithm: Material + Priority =
Recommendation: Remove
Urgency: Medium (mid-term)
Further Comments: There are small amount of debris where the boxing has been removed from 2 small radiators.



Sample No: ES/51356/11
Item: Insulating board
Location: GF/R005 - Ground Floor - Shop floor - To floor below large radiators on the right hand side
Condition: Low Damage
Extent: <1 m²
Ease of access: Easy **Surface treatment:** Unsealed
Lab reference: No sample taken
Results: Strongly presumed to be Chrysotile
Algorithm: Material 6 + Priority 5 = 11
Recommendation: Remove
Urgency: Medium (mid-term)
Further Comments: Strongly presumed to be as sample ES/51356/09.



Sample No: ES/51356/14
Item: Gaskets
Location: GF/R005 - Ground Floor - Shop floor - To boiler pilot light glass
Condition: Low Damage
Extent: <1 m²
Ease of access: Medium **Surface treatment:** Sealed
Lab reference: T901/EUR1/496/014
Results: Chrysotile
Algorithm: Material 6 + Priority 5 = 11
Recommendation: Remove
Urgency: Medium (mid-term)
Further Comments:



Sample No: ES/51356/15
Item: Gaskets
Location: GF/R005 - Ground Floor - Shop floor - To main body of boiler
Condition: Low Damage
Extent: <1 m²
Ease of access: Easy **Surface treatment:** Sealed
Lab reference: T901/EUR1/496/015
Results: Chrysotile
Algorithm: Material 6 + Priority 5 = 11
Recommendation: Remove
Urgency: Medium (mid-term)
Further Comments:



Sample No: ES/51356/18
Item: Black nosing strip
Location: GF/R011 - Ground Floor - Stairs to first floor - To steps
Condition: Low Damage
Extent: ~12 m lin
Ease of access: Easy **Surface treatment:** Composite
Lab reference: T901/EUR1/496/018
Results: Chrysotile
Algorithm: Material + Priority =
Recommendation: Manage
Urgency: None (manage)
Further Comments:



Sample No: ES/51356/21
Item: Toilet cistern
Location: 2F/R020 - 2nd Floor - Toilet - To wall
Condition: Low Damage
Extent: 1 No.
Ease of access: Easy **Surface treatment:** Composite
Lab reference: T901/EUR1/496/021
Results: Chrysotile
Algorithm: Material + Priority =
Recommendation: Manage
Urgency: None (manage)
Further Comments:



Sample No: ES/51356/23
Item: Cement guttering
Location: E/R099 - External - External areas - To main pitched roof
Condition: Low Damage
Extent: ~36 m lin
Ease of access: Medium **Surface treatment:** Unsealed
Lab reference: T901/EUR1/496/023
Results: Chrysotile
Algorithm: Material + Priority =
Recommendation: Manage
Urgency: None (manage)
Further Comments: The gutters are set in concrete on top of the wall.



APPENDIX B: Register of Non-Asbestos Containing Materials

Sample No: ES/51356/06
Item: Green vinyl floor covering
Location: B/R002 - Basement - Store off stairs - To floor
Extent: ~6 m²
Lab reference: T901/EUR1/496/006
Results: No asbestos detected
Recommendation: No action required
Further Comments:



Sample No: ES/51356/07
Item: Green vinyl floor covering
Location: B/R003 - Basement - Rear store - Loose on floor under stairs
Extent: <1 m²
Lab reference: No sample taken
Results: Strongly presumed no asbestos detected
Recommendation: No action required
Further Comments: Strongly presumed to be as sample ES/51356/06.



Sample No: ES/51356/12
Item: Red vinyl floor covering
Location: GF/R005 - Ground Floor - Shop floor - To floor below plywood
Extent: ~20 m²
Lab reference: T901/EUR1/496/012
Results: No asbestos detected
Recommendation: No action required
Further Comments:



Sample No: ES/51356/13
Item: Red vinyl floor covering
Location: GF/R022 - Ground Floor - Corridor adjacent to basement stairs - To floor below grey vinyl floor tiles and plywood
Extent: ~4 m²
Lab reference: No sample taken
Results: Strongly presumed no asbestos detected
Recommendation: No action required
Further Comments: Strongly presumed to be as sample ES/51356/12.



Sample No: ES/51356/16
Item: Orange vinyl floor covering
Location: GF/R006 - Ground Floor - Consultation room - To floor below carpet
Extent: ~12 m²
Lab reference: T901/EUR1/496/016
Results: No asbestos detected
Recommendation: No action required
Further Comments:



Sample No: ES/51356/17
Item: Red vinyl floor covering
Location: GF/R011 - Ground Floor - Stairs to first floor - To steps
Extent: ~6 m²
Lab reference: No sample taken
Results: Strongly presumed no asbestos detected
Recommendation: No action required
Further Comments: Strongly presumed to be as sample ES/51356/12.



Sample No: ES/51356/19
Item: Red vinyl floor covering
Location: GF/R009 - Ground Floor - Rear store room - To floor below plywood and grey vinyl floor tiles
Extent: ~12 m²
Lab reference: No sample taken
Results: Strongly presumed no asbestos detected
Recommendation: No action required
Further Comments: Strongly presumed to be as sample ES/51356/12. Continues into first floor store below plywood and grey vinyl floor tiles.



Sample No: ES/51356/20
Item: Red vinyl floor covering
Location: GF/R008 - Ground Floor - Kitchen - To floor below plywood and grey vinyl floor tiles
Extent: ~10 m²
Lab reference: T901/EUR1/496/020
Results: No asbestos detected
Recommendation: No action required
Further Comments:



Sample No: ES/51356/22
Item: Sash cord
Location: 2F/R017 - 2nd Floor - Wash up - To windows
Extent: 1 No.
Lab reference: T901/EUR1/496/022
Results: No asbestos detected
Recommendation: No action required
Further Comments: Present to 7 windows in total.



APPENDIX C: Summary of Asbestos Containing Samples

Location	Item Product type	Extent	Ease of access	Condition	Surface treatment	Asbestos type	Sample no	Sampled/ presumed/ strongly	Material score Action	Priority score
B/R004 - Basement - Drop room - To pipework	Pipe insulation Insulation	~14 m lin	Easy	High Damage	Unsealed	Chrysotile	ES/51356/01	Sampled 1 sample(s)	10	6 Remove
B/R004 - Basement - Drop room - To walls and ceiling adjacent to pipework	Insulation residue Insulation	~8 m lin	Easy	Medium Damage	Unsealed	Chrysotile	ES/51356/02	Sampled 1 sample(s)	10	6 Remove
B/R004 - Basement - Drop room - To floor	Insulation debris Insulation	<1 m ²	Easy	Low Damage	Unsealed	Chrysotile	ES/51356/03	Sampled 1 sample(s)	10	5 Environmental clean
B/R003 - Basement - Rear store - To wall	Insulating board AIB, Millboard	~1 m ²	Easy	Low Damage	Sealed	Chrysotile	ES/51356/04	Sampled 1 sample(s)	4	5 Manage
B/R002 - Basement - Store off stairs - To walls	Insulating board AIB, Millboard	~1 m ²	Easy	Low Damage	Sealed	Chrysotile	ES/51356/05	Strongly presumed	4	5 Manage
GF/R005 - Ground Floor - Shop floor - Above boiler	Cement flue pipe Cement	~6 m lin	Easy	Low Damage	Unsealed	Chrysotile	ES/51356/08	Sampled 1 sample(s)	3	3 Manage
GF/R005 - Ground Floor - Shop floor - To floor below 2 small radiators	Insulating board AIB, Millboard	<1 m ²	Easy	Low Damage	Unsealed	Chrysotile	ES/51356/09	Sampled 1 sample(s)	6	5 Remove
GF/R005 - Ground Floor - Shop floor - To surrounds of 2 small radiators	Insulating board debris AIB, Millboard	~4 m ²	Easy	High Damage	Unsealed	Chrysotile	ES/51356/10	Sampled 1 sample(s)	7	5 Remove
GF/R005 - Ground Floor - Shop floor - To floor below large radiators on the right hand side	Insulating board AIB, Millboard	<1 m ²	Easy	Low Damage	Unsealed	Chrysotile	ES/51356/11	Strongly presumed	6	5 Remove
GF/R005 - Ground Floor - Shop floor - To boiler pilot light glass	Gaskets Gaskets, Rope and Paper	<1 m ²	Medium	Low Damage	Sealed	Chrysotile	ES/51356/14	Sampled 1 sample(s)	6	5 Remove
GF/R005 - Ground Floor - Shop floor - To main body of boiler	Gaskets Gaskets, Rope and Paper	<1 m ²	Easy	Low Damage	Sealed	Chrysotile	ES/51356/15	Sampled 1 sample(s)	6	5 Remove
GF/R011 - Ground Floor - Stairs to first floor - To steps	Black nosing strip Bonded (Vinyl Floor Tiles Bitumen Plastic etc)	~12 m lin	Easy	Low Damage	Composite	Chrysotile	ES/51356/18	Sampled 1 sample(s)	3	6 Manage
2F/R020 - 2nd Floor - Toilet - To wall	Toilet cistern Bonded (Vinyl Floor Tiles Bitumen Plastic etc)	1 No.	Easy	Low Damage	Composite	Chrysotile	ES/51356/21	Sampled 1 sample(s)	3	4 Manage
E/R099 - External - External areas - To main pitched roof	Cement guttering Cement	~36 m lin	Medium	Low Damage	Unsealed	Chrysotile	ES/51356/23	Sampled 1 sample(s)	6	3 Manage

APPENDIX D: Summary of Non-Asbestos Containing Samples

Item	Location	Extent	Ease of access	Asbestos type	Sample no	Sampled/ presumed/ strongly
Green vinyl floor covering	B/R002 - Basement - Store off stairs - To floor	~6 m ²	Easy	No asbestos detected	ES/51356/06	Sampled 1 sample(s)
Green vinyl floor covering	B/R003 - Basement - Rear store - Loose on floor under stairs	<1 m ²	Easy	No asbestos detected	ES/51356/07	Strongly presumed
Red vinyl floor covering	GF/R005 - Ground Floor - Shop floor - To floor below plywood	~20 m ²	Difficult	No asbestos detected	ES/51356/12	Sampled 1 sample(s)
Red vinyl floor covering	GF/R022 - Ground Floor - Corridor adjacent to basement stairs - To floor below grey vinyl floor tiles and plywood	~4 m ²	Easy	No asbestos detected	ES/51356/13	Strongly presumed
Orange vinyl floor covering	GF/R006 - Ground Floor - Consultation room - To floor below carpet	~12 m ²	Easy	No asbestos detected	ES/51356/16	Sampled 1 sample(s)
Red vinyl floor covering	GF/R011 - Ground Floor - Stairs to first floor - To steps	~6 m ²	Easy	No asbestos detected	ES/51356/17	Strongly presumed
Red vinyl floor covering	GF/R009 - Ground Floor - Rear store room - To floor below plywood and grey vinyl floor tiles	~12 m ²	Medium	No asbestos detected	ES/51356/19	Strongly presumed
Red vinyl floor covering	GF/R008 - Ground Floor - Kitchen - To floor below plywood and grey vinyl floor tiles	~10 m ²	Medium	No asbestos detected	ES/51356/20	Sampled 1 sample(s)
Sash cord	2F/R017 - 2nd Floor - Wash up - To windows	1 No.	Easy	No asbestos detected	ES/51356/22	Sampled 1 sample(s)

APPENDIX E: Actions Required in Priority Order

Sample no	Item	Recommended Action	Priority	Location	Extent	Ease of access	Condition	Surface treatment	Asbestos type	Material score	Priority score
ES/51356/15	Gaskets	Remove	Medium (mid-term)	GF/R005 - Ground Floor - Shop floor - To main body of boiler	<1 m ²	Easy	Low Damage	Sealed	Chrysotile	6	5
ES/51356/14	Gaskets	Remove	Medium (mid-term)	GF/R005 - Ground Floor - Shop floor - To boiler pilot light glass	<1 m ²	Medium	Low Damage	Sealed	Chrysotile	6	5
ES/51356/11	Insulating board	Remove	Medium (mid-term)	GF/R005 - Ground Floor - Shop floor - To floor below large radiators on the right hand side	<1 m ²	Easy	Low Damage	Unsealed	Chrysotile	6	5
ES/51356/10	Insulating board debris	Remove	Medium (mid-term)	GF/R005 - Ground Floor - Shop floor - To surrounds of 2 small radiators	~4 m ²	Easy	High Damage	Unsealed	Chrysotile	7	5
ES/51356/09	Insulating board	Remove	Medium (mid-term)	GF/R005 - Ground Floor - Shop floor - To floor below 2 small radiators	<1 m ²	Easy	Low Damage	Unsealed	Chrysotile	6	5
ES/51356/03	Insulation debris	Environmental clean	Medium (mid-term)	B/R004 - Basement - Drop room - To floor	<1 m ²	Easy	Low Damage	Unsealed	Chrysotile	10	5
ES/51356/02	Insulation residue	Remove	Medium (mid-term)	B/R004 - Basement - Drop room - To walls and ceiling adjacent to pipework	~8 m lin	Easy	Medium Damage	Unsealed	Chrysotile	10	6
ES/51356/01	Pipe insulation	Remove	Medium (mid-term)	B/R004 - Basement - Drop room - To pipework	~14 m lin	Easy	High Damage	Unsealed	Chrysotile	10	6

APPENDIX F: Register of Asbestos Removals

No ACMs have been removed from this property

APPENDIX G: Drawings

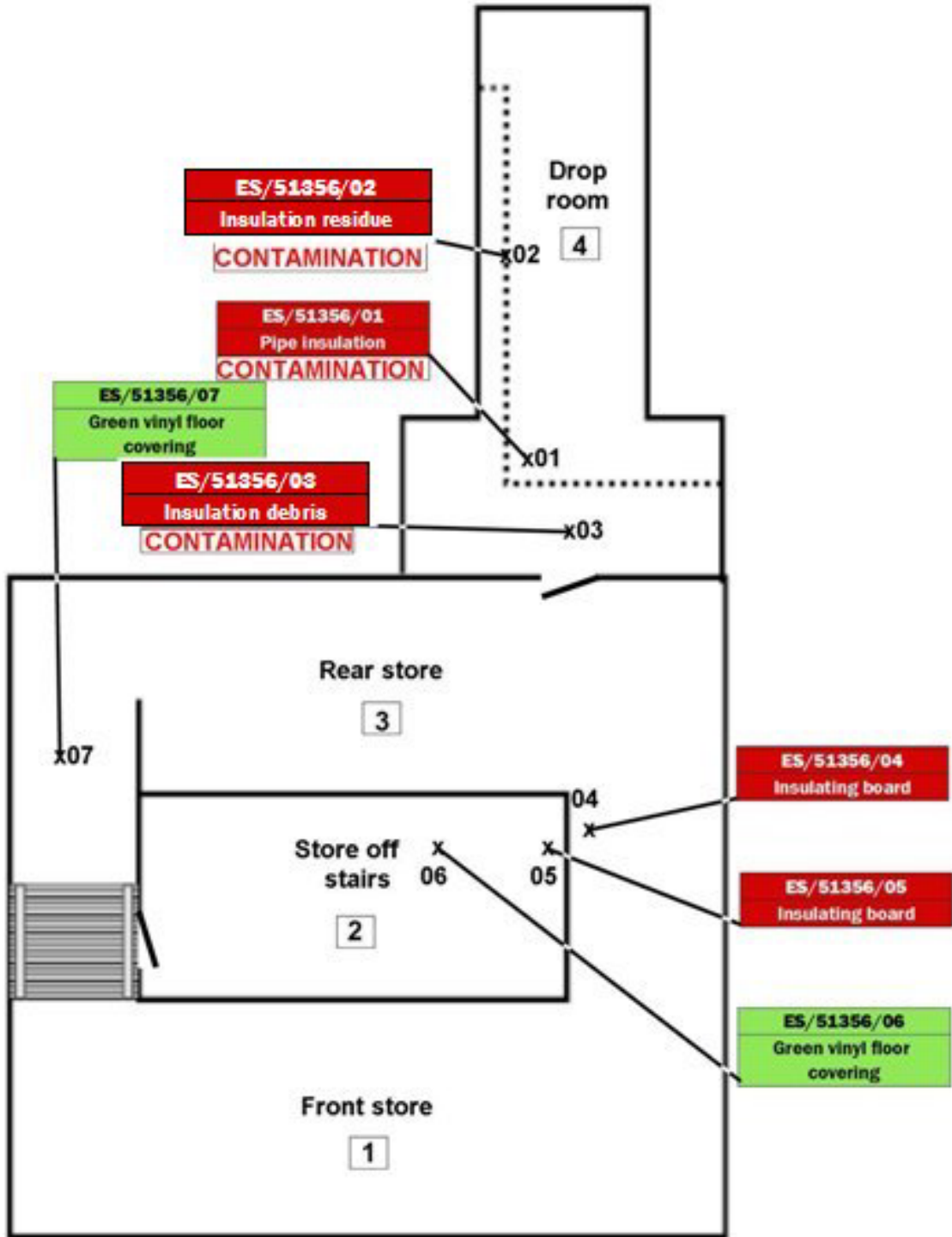

Site Details	7 High Street Glossop Basement		
Key:	Asbestos found	No asbestos found	Areas not surveyed
	C Column	H Hatch	X Lift - - - Beam Pipe run
Note/s	Drawing not to scale		There is no drawing for the first floor as no suspected ACM's were identified

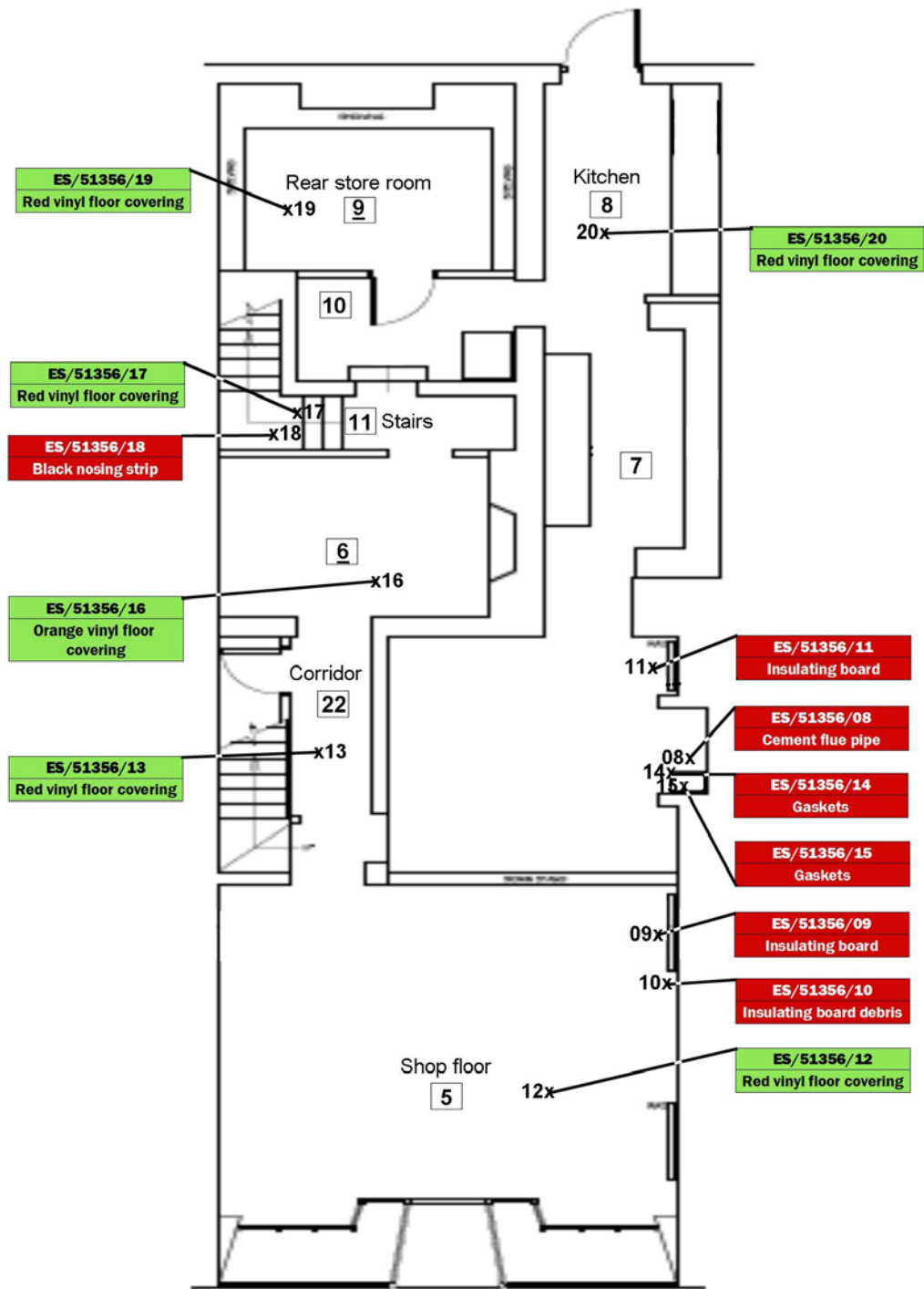

Site Details	7 High Street Glossop Ground floor		
Key:	Asbestos found	No asbestos found	Areas not surveyed
	C Column	H Hatch	X Lift- - - Beam Pipe run
Note/s	Drawing not to scale		There is no drawing for the first floor as no suspected ACM's were identified

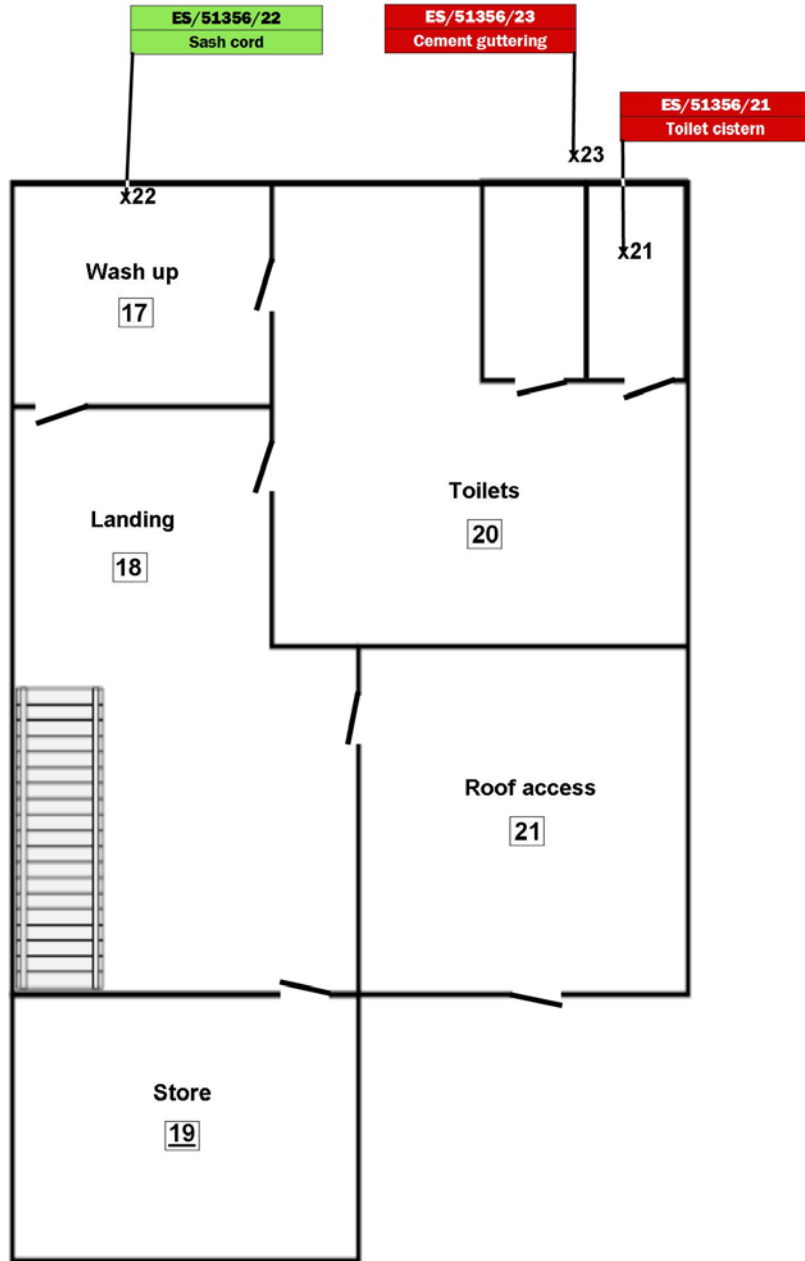

Site Details	7 High Street Glossop Second floor		
Key:	Asbestos found	No asbestos found	Areas not surveyed
	C Column	H Hatch	X Lift- - - Beam Pipe run
Note/s	Drawing not to scale		There is no drawing for the first floor as no suspected ACM's were identified

APPENDIX H: Bulk Reports



1752

Eurosafe
Eurosafe House
Tribune Way
Centurion Park
Clifton Moor
York
YO30 4RY

For the attention of Linda Buckley



Kings Court
17 School Road
Hall Green
Birmingham
B28 8JG

T: (0) 121 270 2550

F: (0) 121 707 2080

www.tersusgroup.co.uk

info@tersusgroup.co.uk

REPORT OF ANALYTICAL EXAMINATION FOR ASBESTOS IN BULK SAMPLE(S)

Job number	T901/EUR1/498
Number of samples	17
Date sampled / received	2/9/2013
Date analysed	2/9/2013, 4/9/2013
Analyst	Sonia Kaur,
Site address	7 High Street West, Glossop, SK13 8A

METHOD OF ANALYSIS

The sample(s) were analysed using Polarised Light Microscopy and McCrone Dispersion Staining by the method given in HSG248, Appendix 2. This is an accredited test method under ISO 17025. We disclaim responsibility for the accuracy of information provided and sampling undertaken the client. "Trace" is reported as defined in HSG248 where applicable. All opinions and descriptions ie. non asbestos fibre types and material types in this report fall outside the scope of our accreditation.

Sample ref no	Building	Floor level	Room	Position	Item	Material	Conclusion
T901/EUR1/498/001	ES/51356/01	Basement	Drop	Pipes	Pipe insulation	Insulation	Chrysotile
T901/EUR1/498/002	ES/51356/02	Basement	Drop	Walls and columns adjacent to pipeowrk	Insulation rosique	Insulation	Chrysotile
T901/EUR1/498/003	ES/51356/03	Basement	Drop	Floor	Insulation debris	Insulation	Chrysotile
T901/EUR1/498/004	ES/51356/04	Basement	Adjacent entrance door to drop	Window	Insulating board panel	Board	Chrysotile

T.BA.v3

T901/EUR1/496

7 High Street West

Page 2

Sample ref no	Building	Floor level	Room	Position	Item	Material	Conclusion
T901/EUR1/496/006	ES/51356/06	Basement	Store off stairs	Floor	Green vinyl floor covering	Not Applicable	No Asbestos Detected
T901/EUR1/496/008	ES/51356/08	Ground Floor	Shop floor area	Above boiler	Cement flue pipe	Cement	Chrysotile
T901/EUR1/496/009	ES/51356/09	Ground Floor	Shop floor area (2x small)	Beneath radiators	Insulating Board	Board	Chrysotile
T901/EUR1/496/010	ES/51356/010	Ground Floor	Shop floor area (2x small)	Surrounds of radiators	Insulating board debris	Board	Chrysotile
T901/EUR1/496/012	ES/51356/12	Ground Floor	Sales area	Floor	Red vinyl floor covering below plywood	Not Applicable	No Asbestos Detected
T901/EUR1/496/014	ES/51356/14	Ground Floor	Sales area	Boiler	Gasket to pilot light glass	Gasket	Chrysotile
T901/EUR1/496/015	ES/51356/15	Ground Floor	Sales area	Boiler	Gasket to main body of boiler	Gasket	Chrysotile
T901/EUR1/496/016	ES/51356/16	Ground Floor	Consulatati on room	Floor	Orange vinyl floor covering under carpet	Not Applicable	No Asbestos Detected
T901/EUR1/496/018	ES/51356/18	1st Floor	Not Supplied	Steps	Black nosing strip	Nosing strip	Chrysotile
T901/EUR1/496/020	ES/51356/20	Ground Floor	Kitchen	Floor	Red vinyl floor covering and adhesive	Not Applicable	No Asbestos Detected
T901/EUR1/496/021	ES/51356/21	2nd Floor	Toilet	Wall	Toilet cistern	Toilet Cistern	Chrysotile
T901/EUR1/496/022	ES/51356/22	2nd Floor	Washup	Windows	Sash ropes	Not Applicable	No Asbestos Detected
T901/EUR1/496/023	ES/51356/23	External	External	Main roof	Cement guttering	Cement	Chrysotile

Authorised signatures

Sonia Kaur

