

Existing Elevation

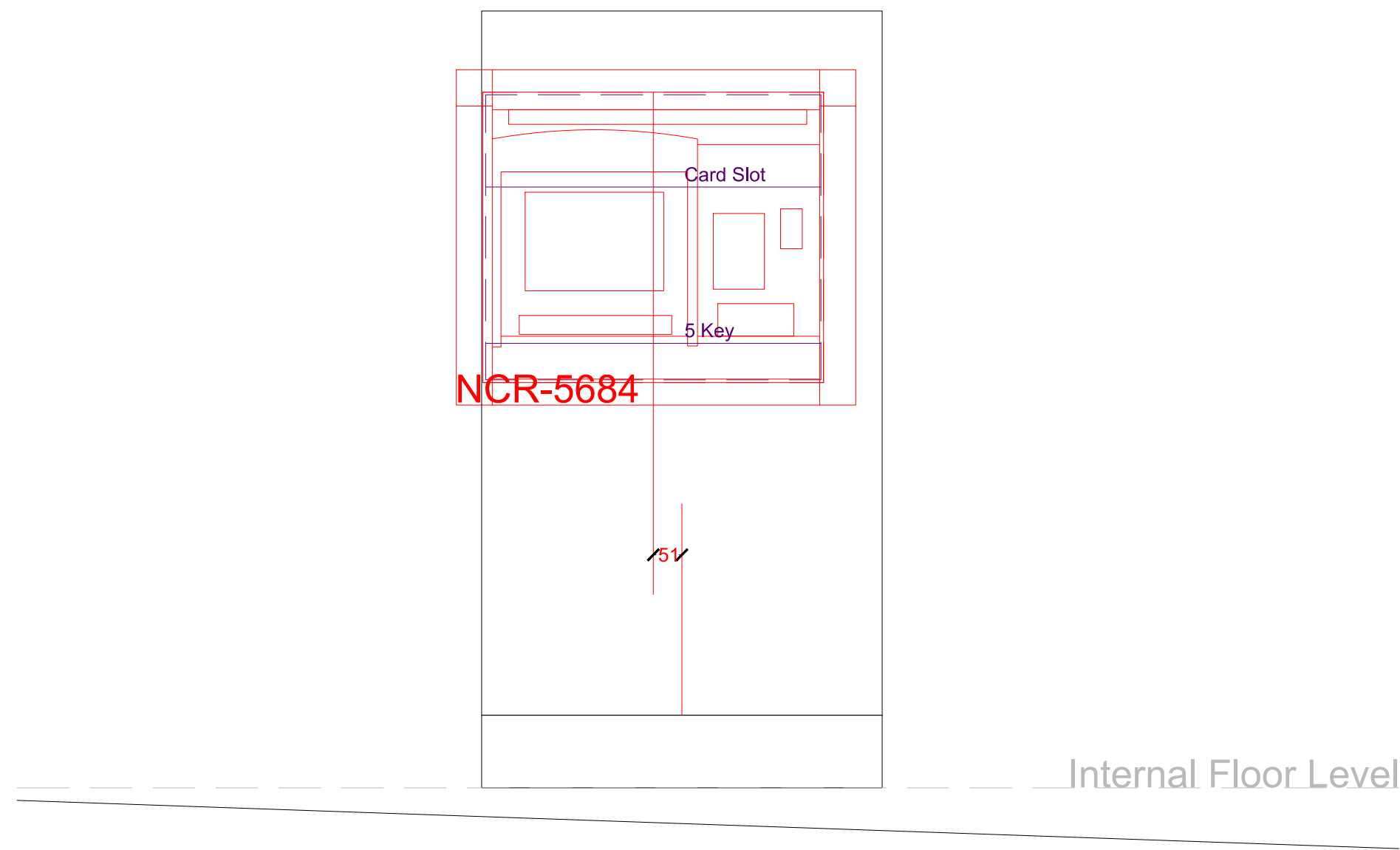

Proposed elevation

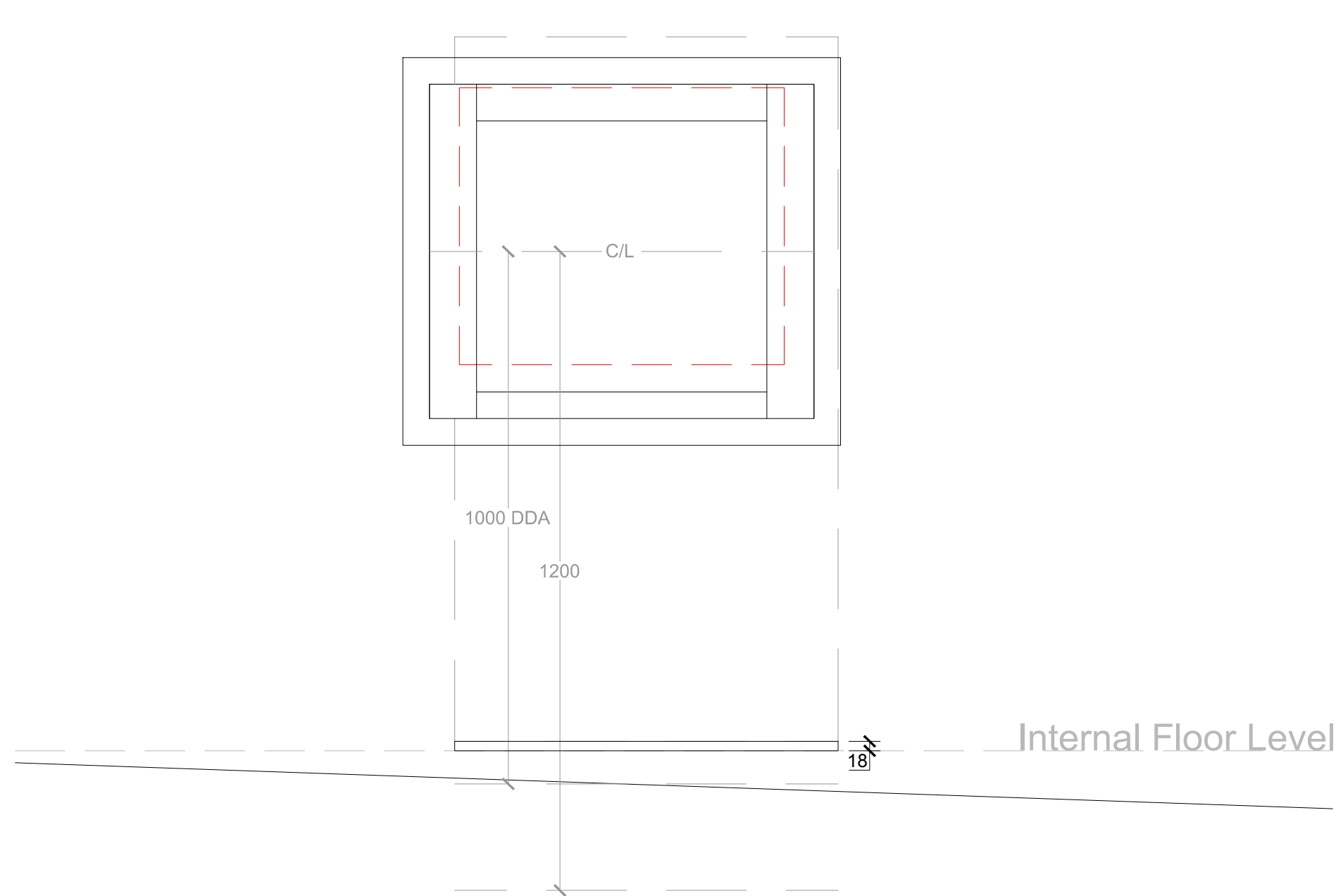

General notes

- ATM Replacement Scope of Works
- NCR 5684 is to be replaced with Wincor Nixdorf 2054xe with CENIII safe and standard bezel.
 - This machine is being installed through a masonry wall faced with stone.
 - Machine is to be lowered to 1000 mm to the c/l of the bezel, as per Bank requirements for accessibility.
 - Aperture plate to be used to adjust existing aperture to new requirement, see drawing for sizes. Plate is to be powder coated to match ATM bezel. Plate has been sized at 50mm beyond the new bezel to cover the area previously hidden by the old machine.
 - Existing linings are to be retained / replaced as appropriate.
 - Machine to be installed through wall on centre line of existing opening.
 - Existing aperture shown dotted is the minimum recommended for the existing machine, lower opening as required to suit new aperture.
 - Internal wall to be refinished and redecorated to suit new opening. Any gaps between aperture and throat to be closed with MDF or similar board painted to match surround wall.
 - New plinth fitted to suit, approx 18 mm.
 - All works subject to a listed building application.

Existing plan

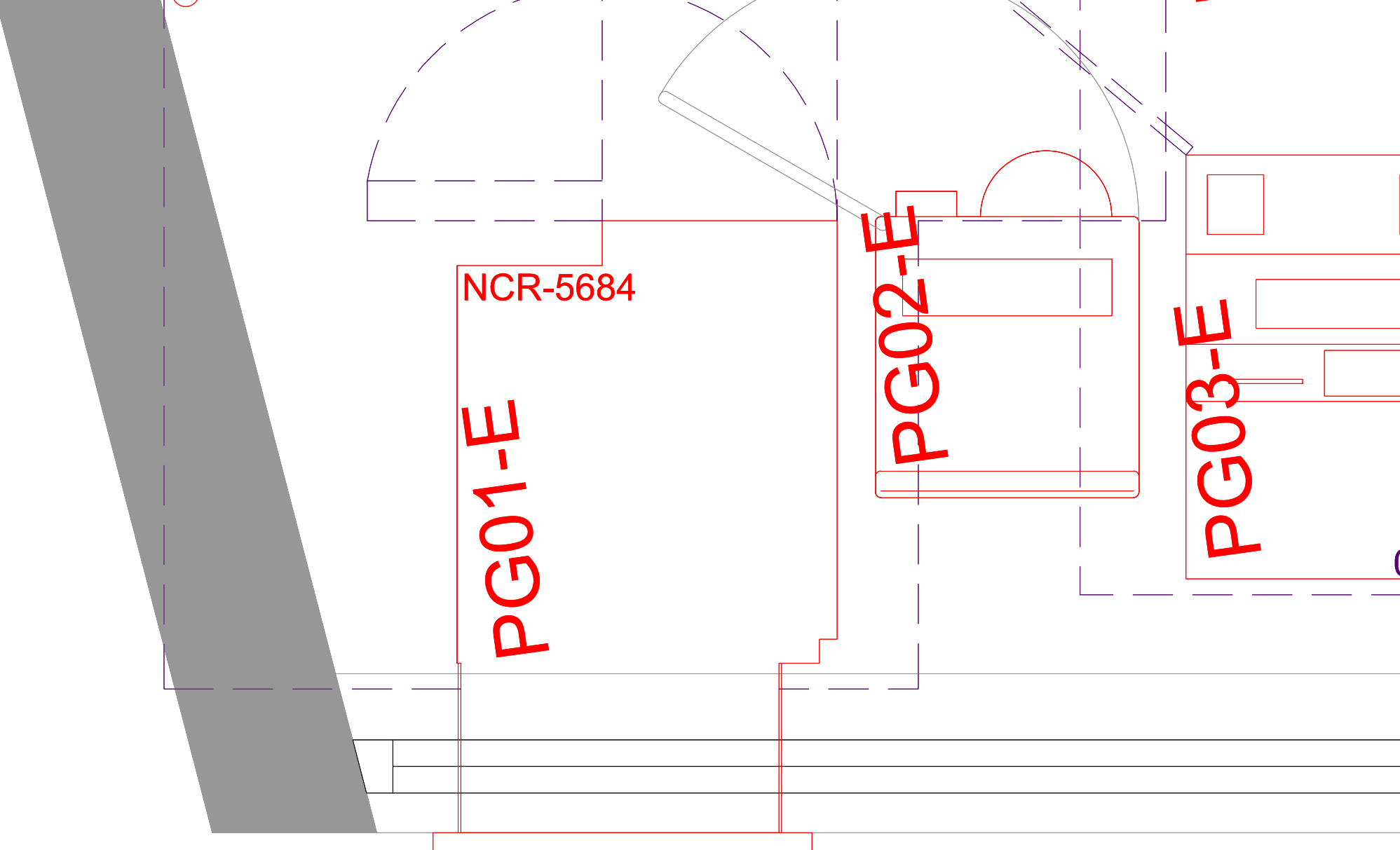

Proposed plan

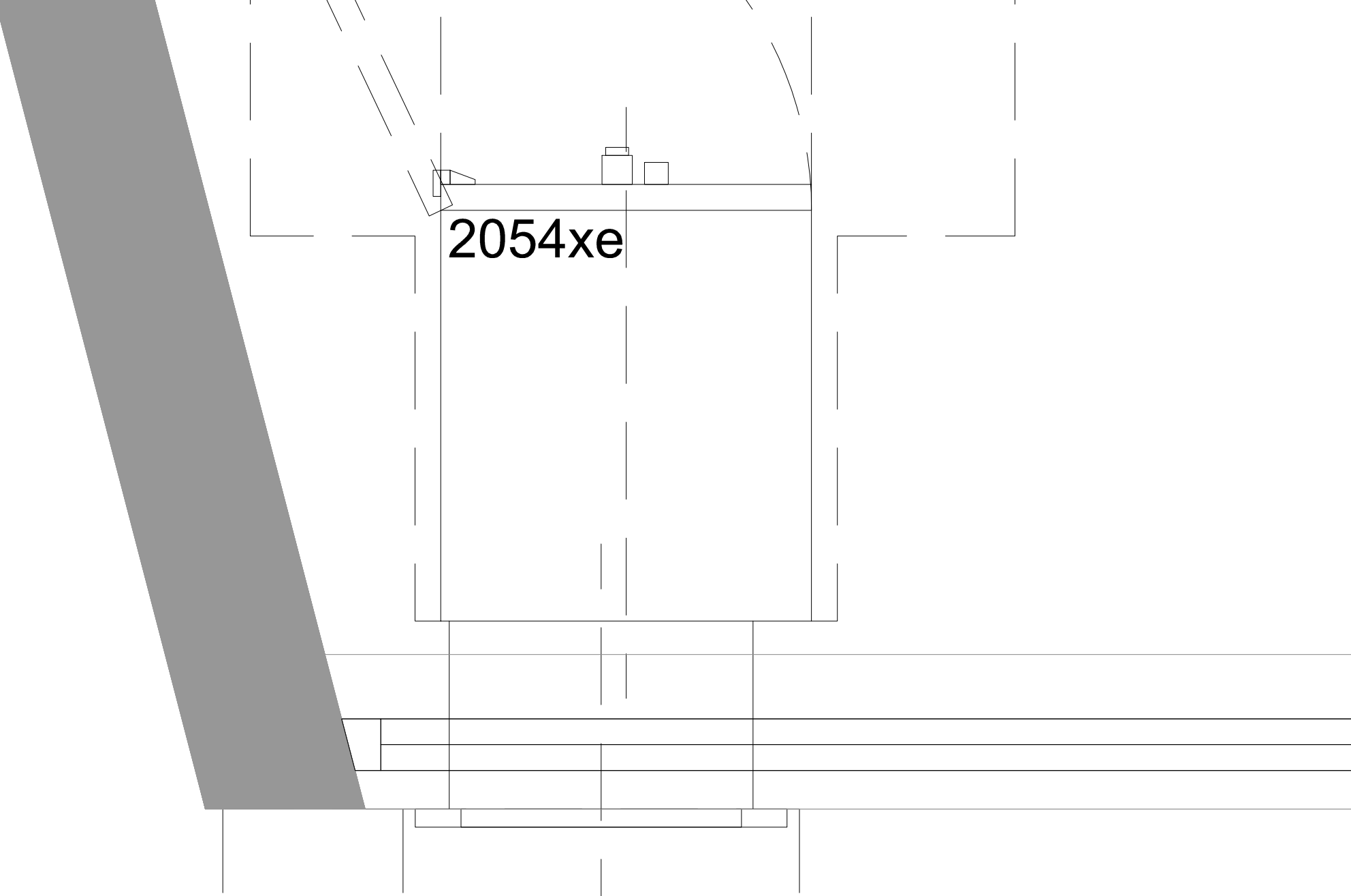

Aperture plate

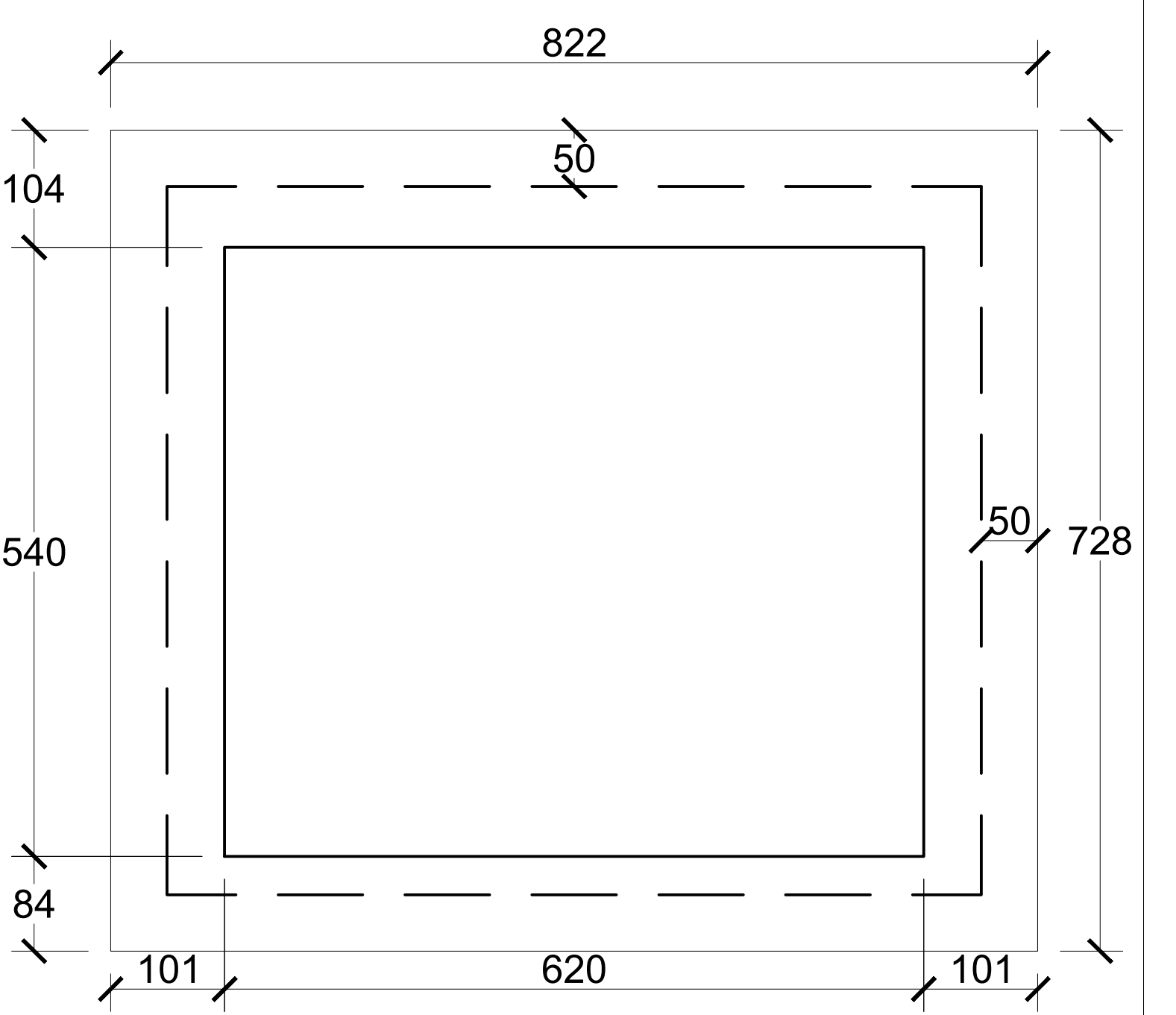

Notes:	Rev	Date	Notes	Rev	Date	Notes
Copyright of this drawing is reserved by AXIS Architecture and issued on the condition that it is not copied, reproduced or disclosed to any third party either wholly or in part without the consent in writing of AXIS Architecture.	-	14.03.13	Initial issue.			
The contractor must verify all dimensions on site before making shop drawings or commencing work of any kind. No dimensions to be scaled from this drawing.						

Client HSBC	Project Buxton - Refresh 1 The Quadrant, Buxton, Derbyshire, SK17 6AW.	Title Proposed ATM Replacement Evergreen Programme
Status INFORMATION	Scale A1 A3 Date 14.03.2013 RAS	Job No. 26620_ATM
AXIS Architecture and Design Ltd, Talbot Chambers, 2-6 North Church Street, Sheffield, S1 2DH.	tel: +44(0)114 2490944 fax: +44(0)114 2490966 www.axis-architecture.com designed@axis-architecture.com	