

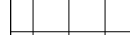



## EXTERNAL SURFACES KEY

	<p>EXISTING PAVING SLABS TO BE RE-LAID TO NEW FALLS REQUIRED FOR MODIFICATION OF ENTRANCE. REFER TO HIGHWAYS ENGINEERS &amp; STRUCTURAL ENGINEERS DRAWING FOR DETAILS.</p>
	<p>NEW TARMAC FOOTPATH TO BE LAID TO REPLACE THE EXISTING TARMAC FOOTPATH TO LEVELS REQUIRED. REFER TO HIGHWAYS ENGINEERS &amp; STRUCTURAL ENGINEERS DRAWING FOR DETAILS.</p>

ANY FOOTPATH SURFACING (INCLUDING AREAS OF TACTILE PAVING ON HIGHWAYS) LAND TO BE TO ADOPTABLE STANDARD AND UNDER SEPERATE AGREEMENT. ALL DETAILS TO BE AGREED WITH SPECIALIST HIGHWAY CONSULTANT

## LEVELS KEY

	EXISTING FINISHED GROUND/FLOOR LEVELS
	PROPOSED FINISHED GROUND/FLOOR LEVELS
	GRADIENT OF SURFACE
	DROP KERB IN PAVEMENT TO DDA REGULATIONS AND PART M & K

## EXTERNAL WORKS NOTES

FOR FULL SPECIFICATION OF ROAD AND PATH SURFACES REFER TO STRUCTURAL ENGINEERS DETAILED DESIGN AND SPECIFICATION.

FOR DETAILED INFORMATION OF SITE CROSS OVER POINTS REFER TO HIGHWAYS ENGINEERS DETAILED DESIGN & SPECIFICATION.

FOR KERB DETAILS, REFER TO STRUCTURAL ENGINEERS DRAWING.

FOR EXTERNAL WORKS DETAILS, REFER TO STRUCTURAL ENGINEERS DRAWINGS.

NEW FOOTPATHS AND ACCESS ROUTES ACROSS SITE TO BE LAID IN ACCORDANCE WITH ALL CURRENT BRITISH REGULATIONS AND BRITISH STANDARDS.

ALL WHITE LINING SHOULD CONFORM TO THE D.O.T STANDARD AND DEFINED WITH 100mm WIDE THERMOPLASTIC LINING PAINT

CAR PARKING AND GENERAL SITE AREA, CONTRACTOR TO PROVIDE ALL EXTERNALLY LOCATING:

- CAR PARKING AREA
- ACCESS AND SERVICE ROADS.
- FOOTPATHS.
- BOUNDARY AND RETAINING WALLS, FENCING, RAILINGS.
- BOLLARDS.

GRADIENTS TO ACCESS ROADS SHOULD BE DESIGNED TO A MAXIMUM 1:20 FALL WITH CROSS FALLS AND PARKING AREAS DESIGNED TO A MAXIMUM 1:40 GRADIENT. EXTERNAL LIGHTING IS TO BE PROVIDED BY THE CONTRACTOR TO AN ILLUMINATION LEVEL OF 20 LUX MEASURED MINIMALLY AT GROUND LEVEL. THE POSITIONS WILL BE SPECIFIED BY ARCHITECT, LIGHTING SCHEME BY OTHERS.

Revision: \_\_\_\_\_ By \_\_\_\_\_ Approved \_\_\_\_\_

FOR PLANNING PURPOSES

Office 7, Gateway 1000  
Arlington Business Park  
Whittle Way  
Stevenage  
Hertfordshire  
SG1 2FP

archer  
architects

Client:

TESCO EXPRESS

Project:  
Masons Arms, 87 Station Road  
Hadfield, SK13 1DL

Drawing Title:  
**PROPOSED EXTERNAL WORKS  
APPLICATION**

Scale:	Date:	Drawn:	Checked:
VA@A1	27.03.2011	LH	
Project No:	Drawing No:	Revision:	
4186	(P)506		

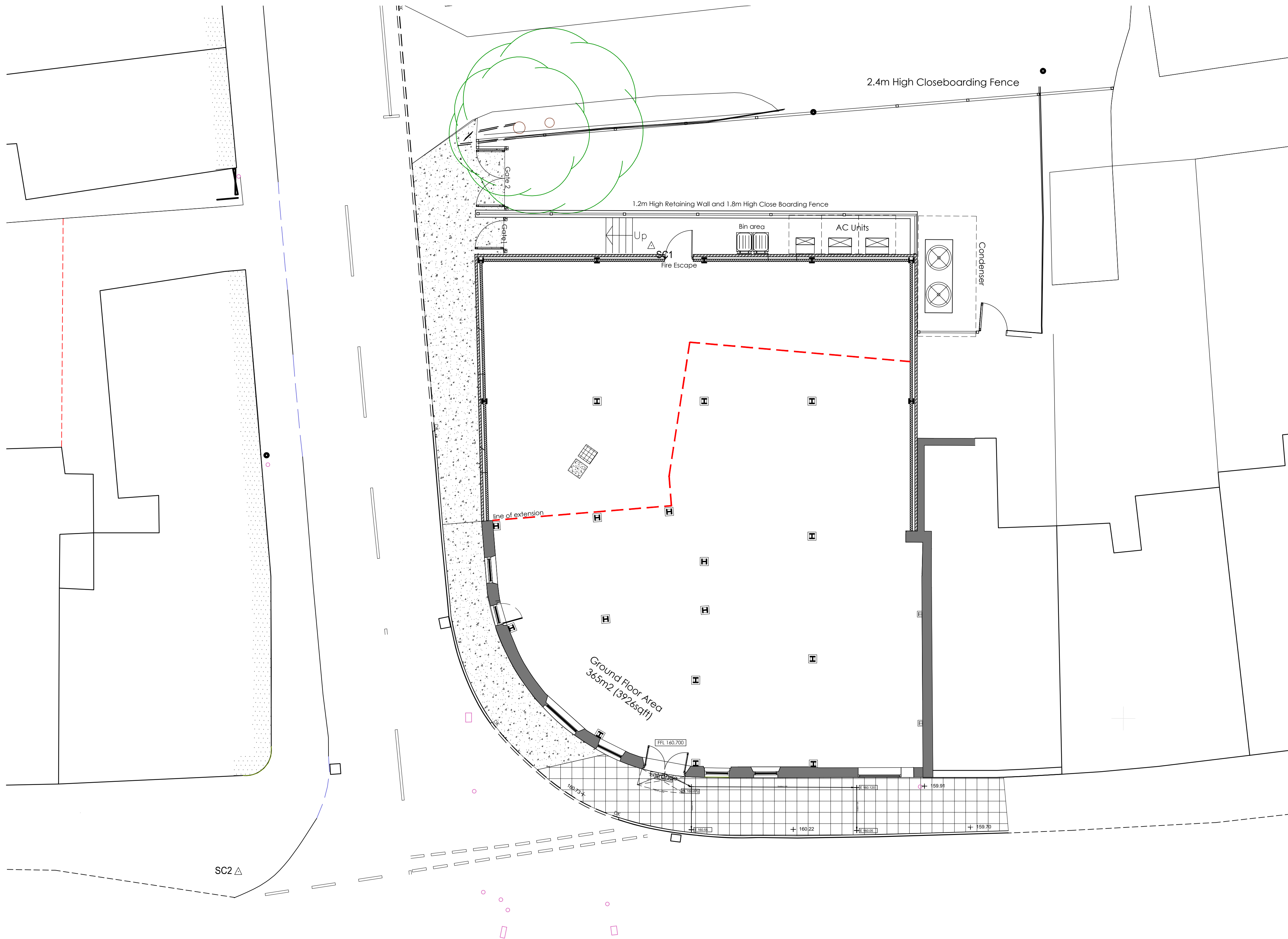

EXTERNAL WORKS SITE PLAN  
SCALE 1:100



PHOTO ALONG KILN LANE OF FOOTPATH



PHOTO ALONG STATION ROAD OF FOOTPATH

