

Existing 2-storey residential semi-detached in pebbledash render and slate roof

New semi-detached dwellings in smooth cream render upon coursed stone plinth

New 3-storey residential terrace onto Waterswallows front in natural grey limestone to extend through garden walls

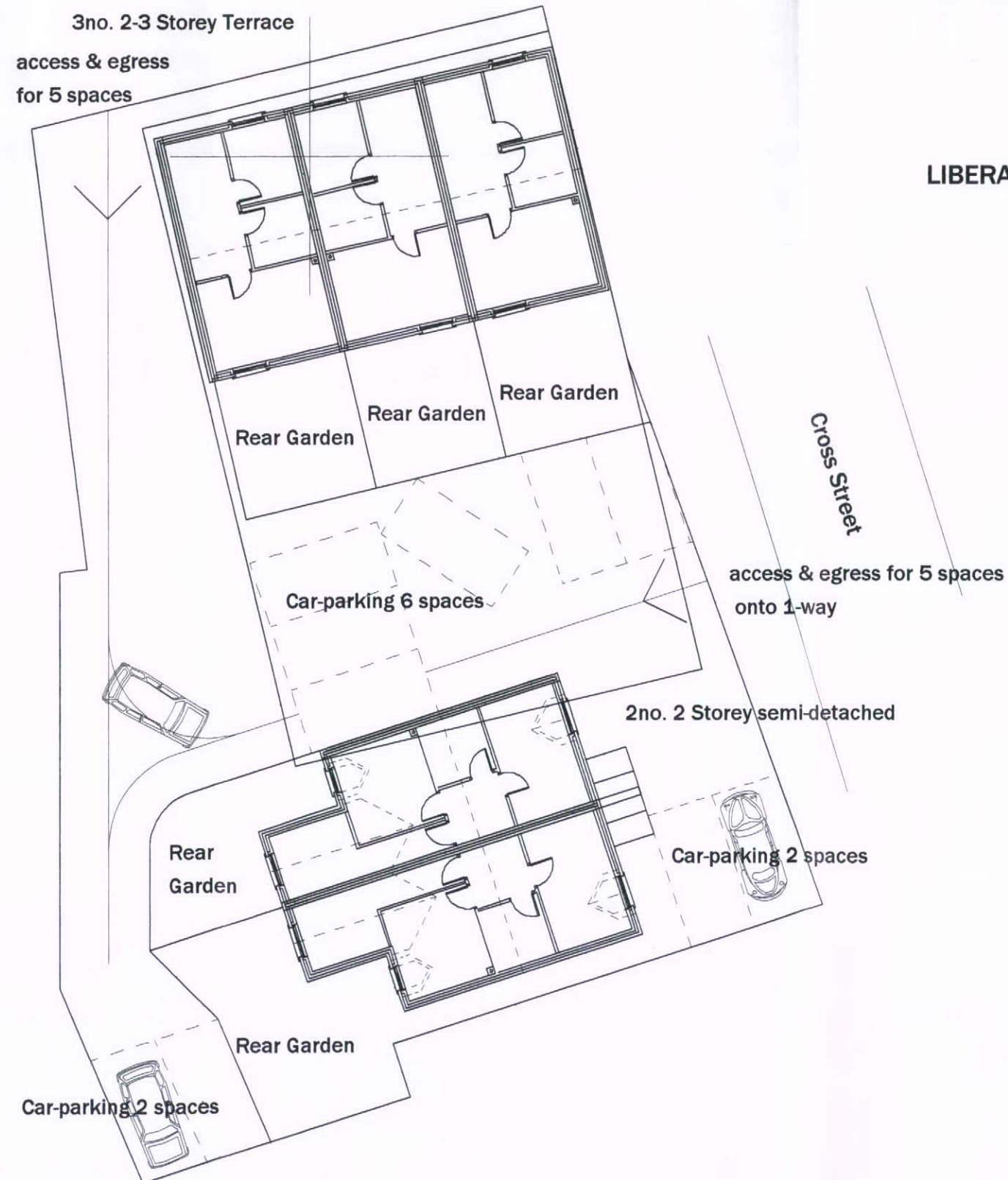

LIBERAL CLUB SITE - CROSS STREET (WEST) ELEVATION

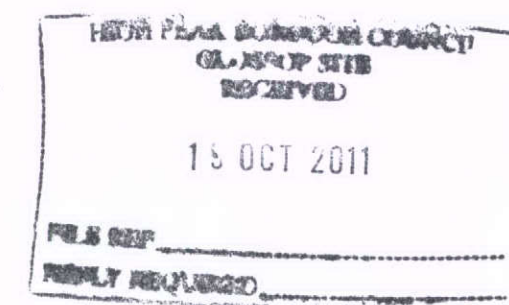

Rev B Ridge Height stated 16/9/11

**LIBERAL CLUB SITE
WATERSWALLOWS ROAD, BUXTON.
PROPOSED LAYOUT DRAWING.**

Drawing 1101/07revB

July 2011 Scale 1:200

**Paul Searle Architect Ltd.
CHARTERED ARCHITECT**

MILLINGTON HOUSE 12 LEEK ROAD CONGLETON CW12 3HU
HILLSIDE LEEK OLD ROAD RUSHTON SPENCER SK11 ORN
(01260) 289019 OR 226550 (mobile) 07989 410658