

PLAN OF PROPOSED EXTENSION

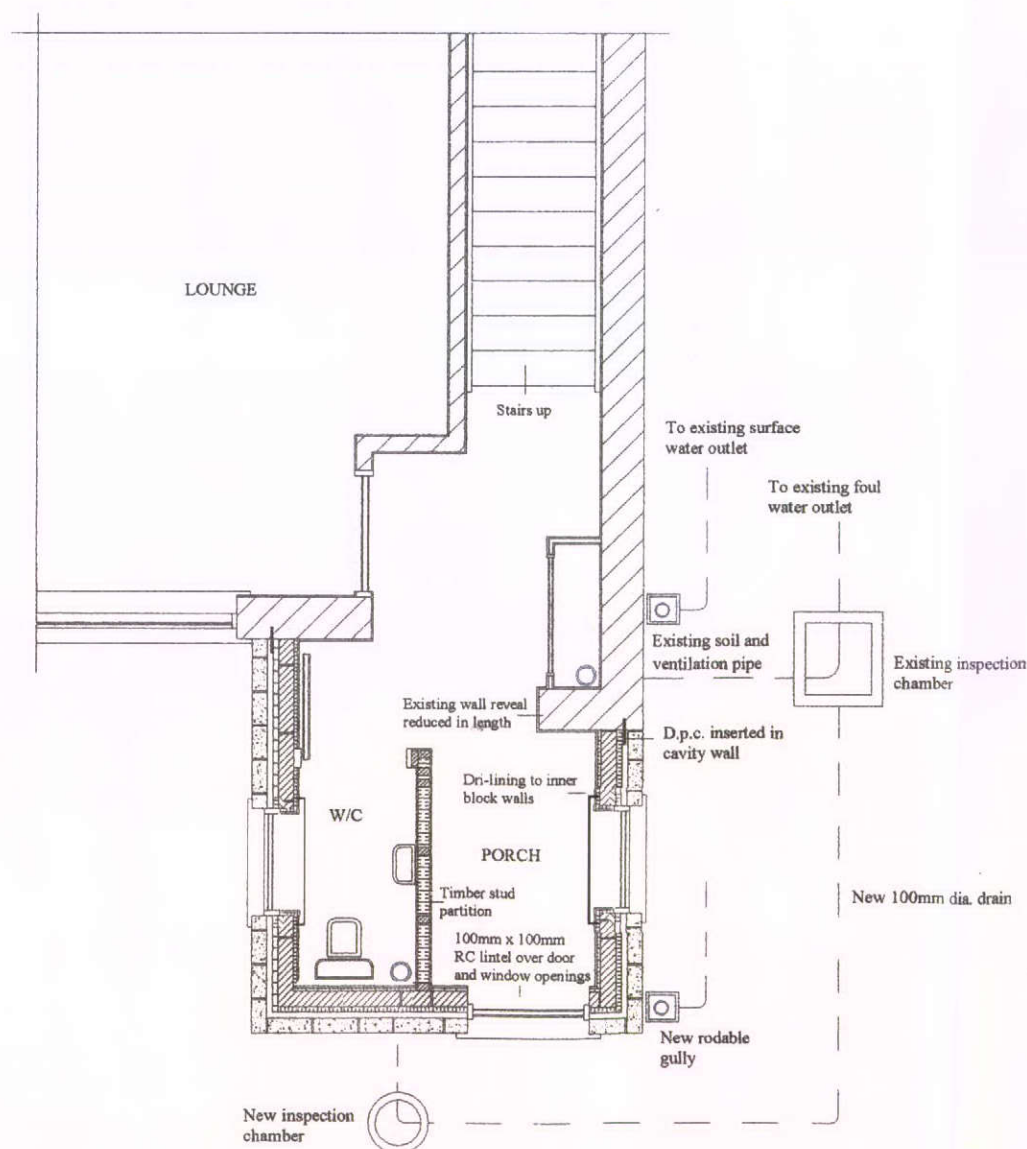

INSULATION

The external walls, roof and floors are to be insulated to the following minimum standards:-

Walls - Kingspan Kooltherm K8 partial cavity board 50mm thick with a clear 25mm residual cavity "U" value 0.27W/m2K.

Roof - Unvented roof with insulation between rafters Kingspan Kooltherm K7 125mm thick between rafters and underdrawn with Kingspan K18 Dry-lining board "U" value 0.16W/m2K.

Kingspan nilvent breathable membrane laid taut in vertical runs held in place with staples. 25mm thick counter battens should be fixed to the top of the rafter to allow a minimum of 10mm gap for the disposal of water vapour drainage. All work on the warm insulated unvented roof is to comply with BS 5250: 1989 (1995).

Floor - Kooltherm K3 Floorboard 65mm thick laid under the floor concrete "U" value 0.22W/m2K.

Windows - U.p.v.c. frames with 4-22-4 double glazing (low - E, en = 0.15 soft supplied by Pilkington Optitherm) "U" value 0.22W/m2K.

SOUND INSTALLATION

All internal walls adjoining habitable rooms, bedrooms, lounges, kitchens and bathrooms etc. from corridors will have a performance of 40LnTw minimum of sound transmission. All timber stud partitions are to be of 100mm studs with 12.5mm of Gyproc Wall-board either side of partition with 65mm ISOWOOL APR 1200 glass mineral wool fixed to inner side of wall.

LIMITATIONS ON AIR LEAKAGE

Robust Construction

All reasonable methods to reduce infiltration of air around openings in the external fabric, floor and roof and all good practice guides shall be included in the general construction of the building.

SAFETY GLAZING

All glazing in critical locations i.e. glazing in and around doors and windows below 900mm off the floor level are to be safely glazed to BS 6260 and marked according to BS 6260.

ELECTRICAL INSTALLATIONS

All electrical work will be carried out to meet the requirements of Part P of the Building Regulations by a competent person and a member of ELECSA. Notification to the Local Authority is the responsibility of ELECSA and the contractor, the notice must demonstrate that the electrical installations conform to BS 7671. The householder certificate is to be issued on completion of the work to show compliance with BS 7671.

GAS SAFETY (installation and use) REGULATIONS

The contractor or person appointed to carry out work shall be GAS SAFE registered, approved by the Health and Safety Executive.

SPM/1070-4-0